

Process ID #65736

Vol 4961 Fol 93
R.P.O. Vol. 33 Fol. 605

C.T. Vol. 3039 Fol. 117

Vide Bk. 1157 fol. 56 Original

See 1273:110

Cadastral Sheet G.B.N. 63C
Ward of Naparima 3/c
County of Victoria

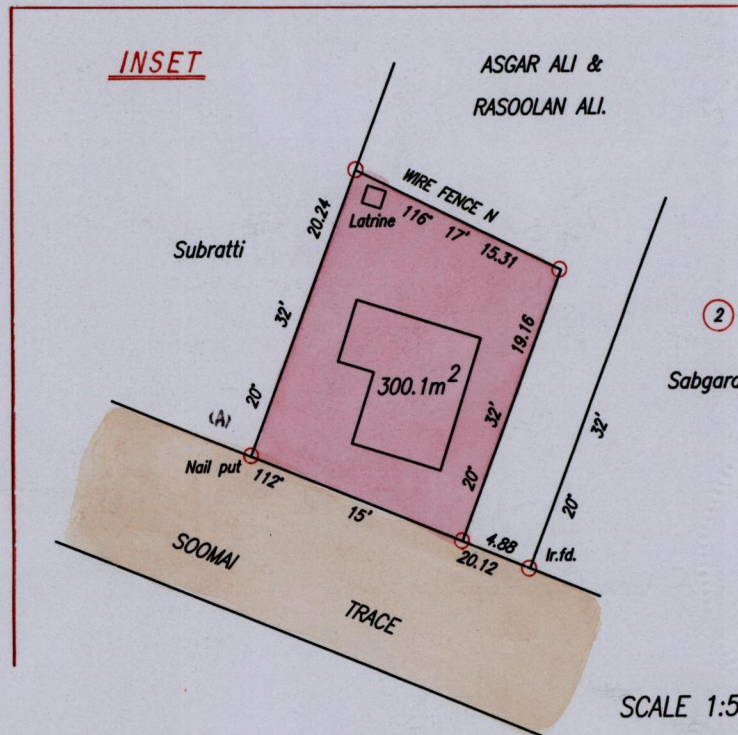
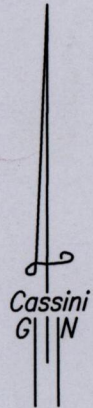
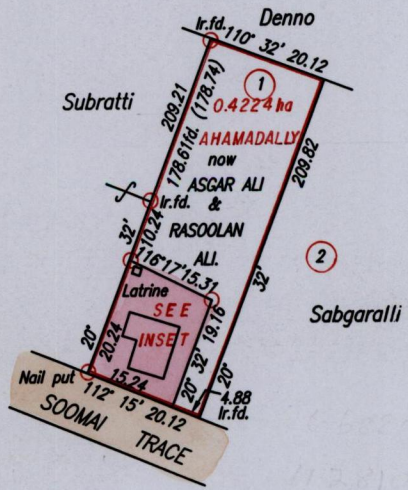

SCALE 1:500

(A) - 668906
1128338
24584

Nishward & Amit Dubree
Dookree

Approved *[Signature]*
Director of Surveys
2004.8.6

SCALE 1:1250
Distances are in Metres

○ Denotes Iron put except otherwise stated.
Bearings are Cassini Grid based on Solar Observations.
PLAN of a Parcel of land coloured pink in the Ward of Naparima
Containing three hundred point one square metres.
Surveyed by me, with due authority, in July, 2002
In accordance with Regulation 25(1) of the Land Surveyors' Regulations 1998,
I certify that this plan is correct.

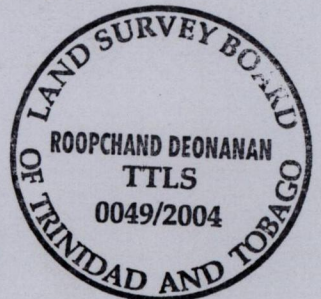

Checked by *[Signature]* *[Signature]*

Entered *[Signature]* 08.07.2013 Trinidad & Tobago Land Surveyor 16th April 2004
PATH = E:\700 C:\Drawings\Dubree.dwg.