

REMAINING PORTION

R.P.O. Vol. 4 Fol. 529

Cadastral Sheet C.22.L. $\frac{26A}{3/c \text{ \& } 3/d}$

C. of T. Vol. 455 Vol. 233

Ward of Manzanilla

Vol. 4104 fol. 491

County of St. Andrew

Process ID #65629

SEE PLAN R.H. 90

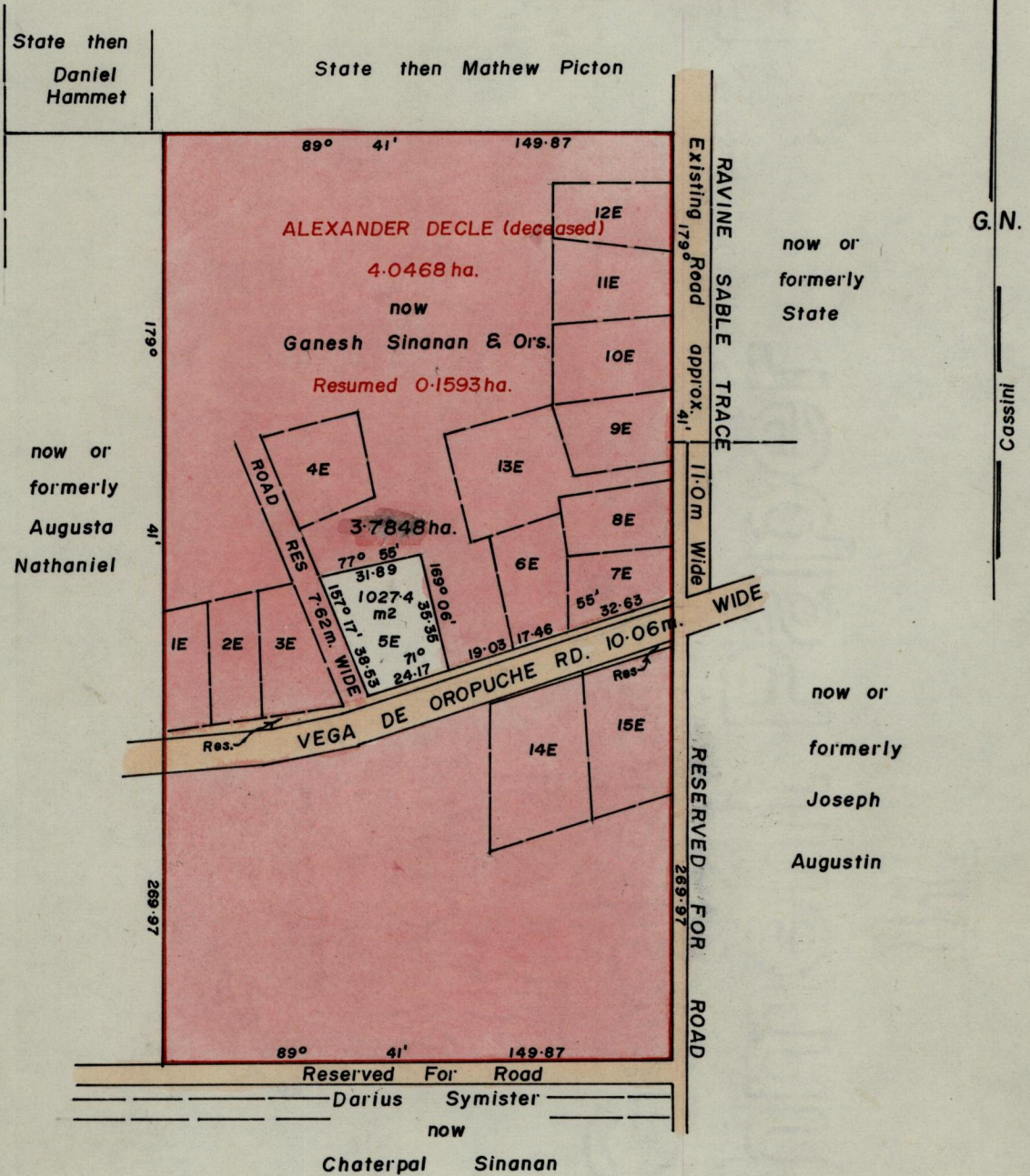

Approved

[Signature]
Director of Surveys
99.5.26

Note: To obtain compass bearings

add 19 minutes
subtract

Distances are in metres

Lot 5E Patrick Williams
C.T. Vol. 3112 fol. 129

Ganesh & Ramajaya Sinanan
SCALE 1/2000

original bk. 174 fol 50

This is a true copy of a diagram of Four Point Zero Four Six Eight Hectares originally transferred granted to ALEXANDER DECLE, shewing a portion

coloured pink and containing Three point seven eight Four eight Hectares being the remainder after one resumption and one previous transfer of another portion of the land.

(the dividing lines having been run in conformity with Rule 76 under Sec. 7(d) of Cap. 27. No. 2 and duly certified by the Director of Surveys.

Checked by *MP 99/05/07*

Entered on *26/10/04*
ENTERED ON CMIS

Sugriva Ramaul
Land Surveyor, Trinidad, Decemba 10, 19.98.