

1281287

105

REMAINING PORTION

R.P.O. Vol. 38 Fol. 139

C.T. Vol. 349 Fol. 57

Vol. 4526 Fol. 47

Process 50-65664

Ward of Savana Grande  
County of Victoria  
Cadastral Sheet ( G.9.O ) 64.A  
4/c

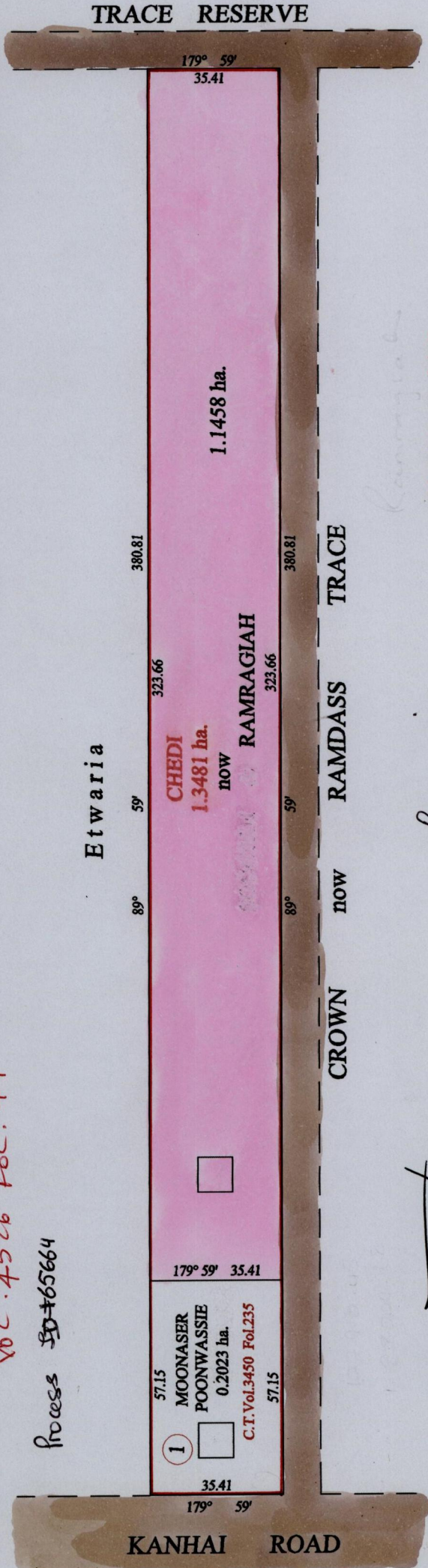

Vide Bk. 1197 fol. 68

Ramragiah

SCALE : 1:1500

Note: Bearings are cassini grid based on solar observations Distances are in metres

This is a true copy of a diagram of one point three four eight one hectares, originally transferred to CHEDI, shewing a portion coloured pink and containing one point one four five eight hectares being the remainder after one (1) previous transfer of another portion of the land. In accordance with Regulation 25 (1) of the Land Surveyors' Regulations 1998, I certify that this plan is correct.



Approved: *[Signature]*  
 Director of Surveys  
 10/11/22

Checked by *[Signature]*  
 M.M. 10/11/22

Entered on C.M.S. 1305-2013 Trinidad & Tobago Land Surveyor 13: 05: 2003