

Vol 4950  
R.P.O. Vol. 3708  
C.T. Vol. 51

Ward of Ortoire  
County of Victoria  
Cadastral Sheet G.5.J., 54E  
3/b

Process SD#65663

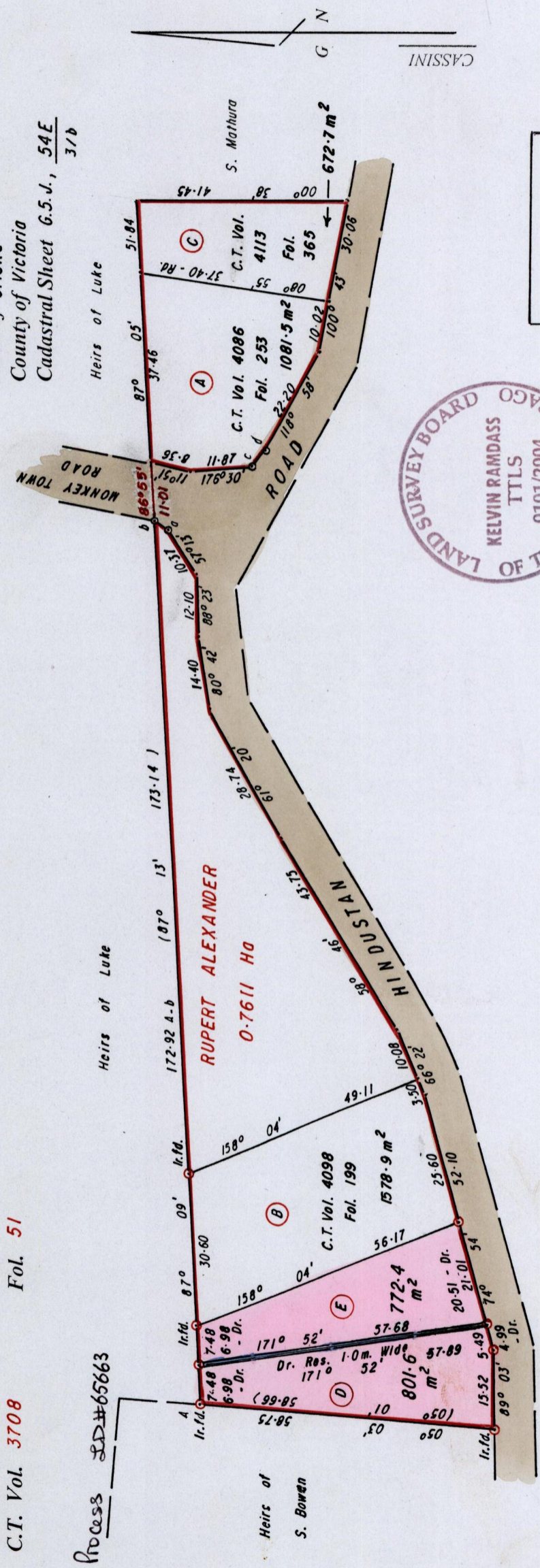

a - b	37° 29'	3-56
c - d	125° 44'	4-11

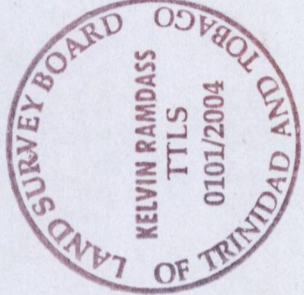

SEE 1524:10

Approved *[Signature]*  
Director of Surveys  
2005-3-14

Bearings are Cassini Grid based on Solar Obs.  
minutes Distances are in METRES

PLAN of 2 Parcels of land coloured PINK in the Ward of Ortoire  
Containing together one thousand five hundred and seventy four point zero square metres  
Surveyed by me, with due authority, in May 2002  
In accordance with Reg. 25 (1) of the Land Surveyors' Regulations 1998, I certify that this plan is correct.

Checked by *[Signature]*  
Entered *[Signature]* 14-05-2013  
Trinidad and Tobago Land Surveyor ..... 2004

SCALE 1/1000

○ Denotes Iron put unless otherwise stated

Ref. Bk. 1280/44

1287

104

D - Vol. 4968 Fol. 217 Brian Cornwall.

E -

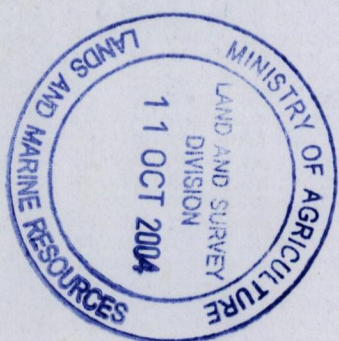

1195/190