

Process ID# 6621

1282

33
99

R.P.O. Vol 2412 Fol 445

Cadastral Sheet A.20.0 $\frac{23B}{1/a}$

City of Port of Spain

County of St. George

Vol. 4781 Fol. 281

Sea Lots Road	K	120.76	1.89
		77.98	0.60
		32.18	0
		0.00	0
		C	96° 06'

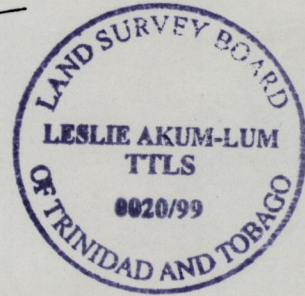

G N
cassini

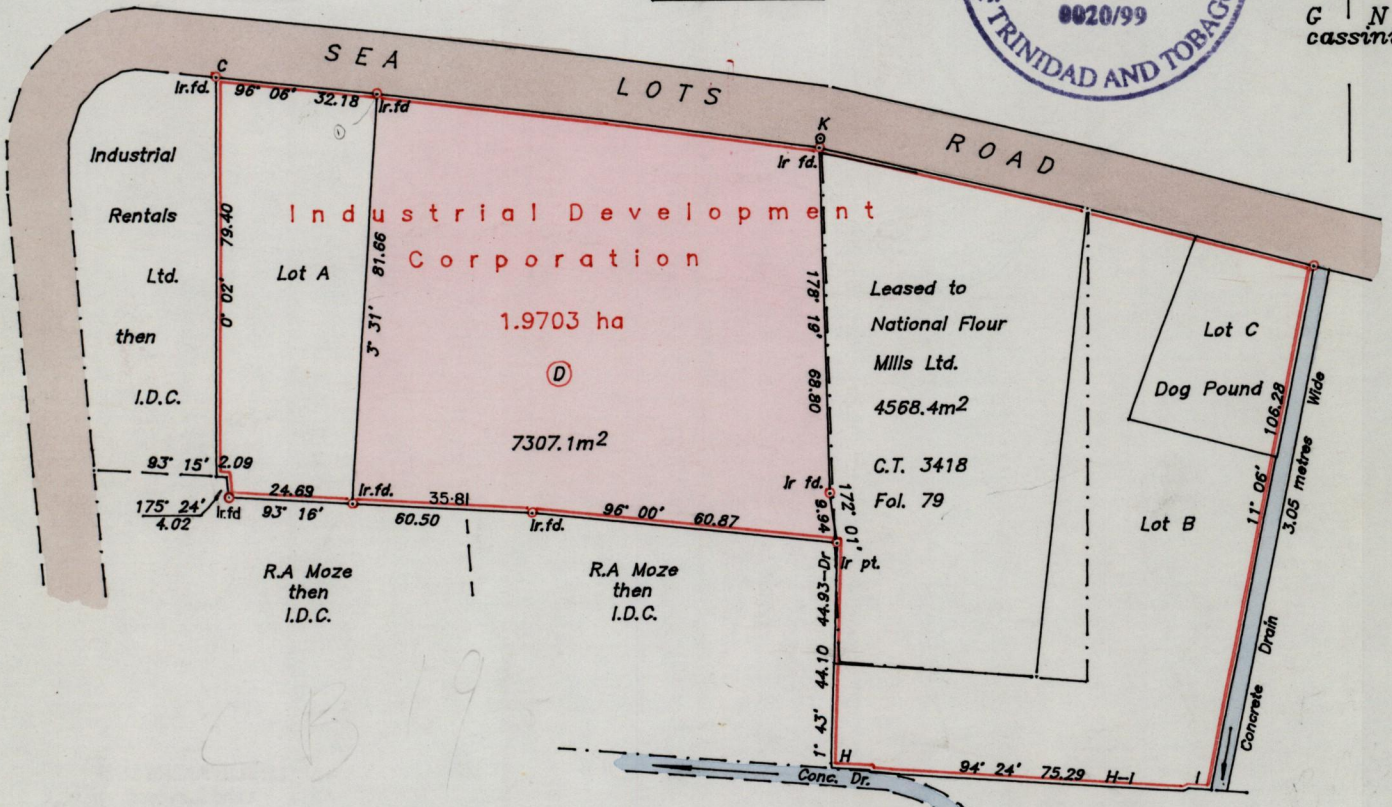

Approved
[Signature]
 Director of Surveys of
 2000.12.1

1083:124
 Aeromarie Trinidad Central Market
 Ltd.

See Plan LB 19
 Bk. 1066 fol. 160

SCALE 1/1500

Orig in F.A 133

Bearings are based on Solar Observations.

Distances are in metres

PLAN of a Parcel of land coloured pink in the City of Port of Spain
 Containing seven thousand three hundred and seven point one square metres
 Surveyed by me with due authority in February 1999
 In accordance with rule 25 (1) of the Land Surveyors' Regulations 1998,
 I certify that this plan is correct.

Checked by *CP 23/03/00*
 Entered *238 3/03*
TBelmonte

Leslie Akum-Lum
 Trinidad & Tobago
 Land Surveyor, *2nd April* 19.99