

1282

L. & S.—54

No 19525

Process Id# 65891

R.P.O. Vol. 10  
C.T. Vol. 1097

Fol. 101  
Fol. 129  
Fol. 103

Ward of Moruga.  
County of Victoria.  
Cadastral Sheet G. 20.H & G.

STATE then J. E. Hutching

74C  
12

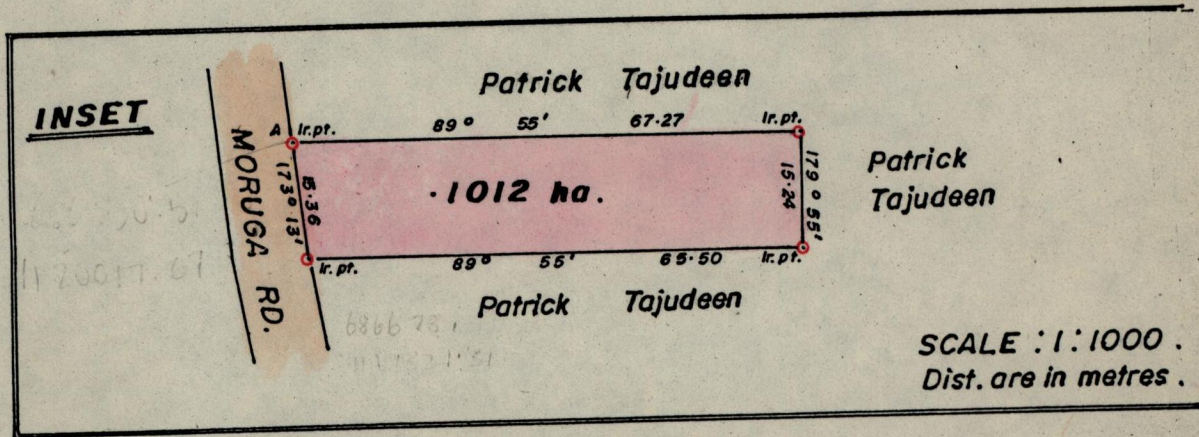
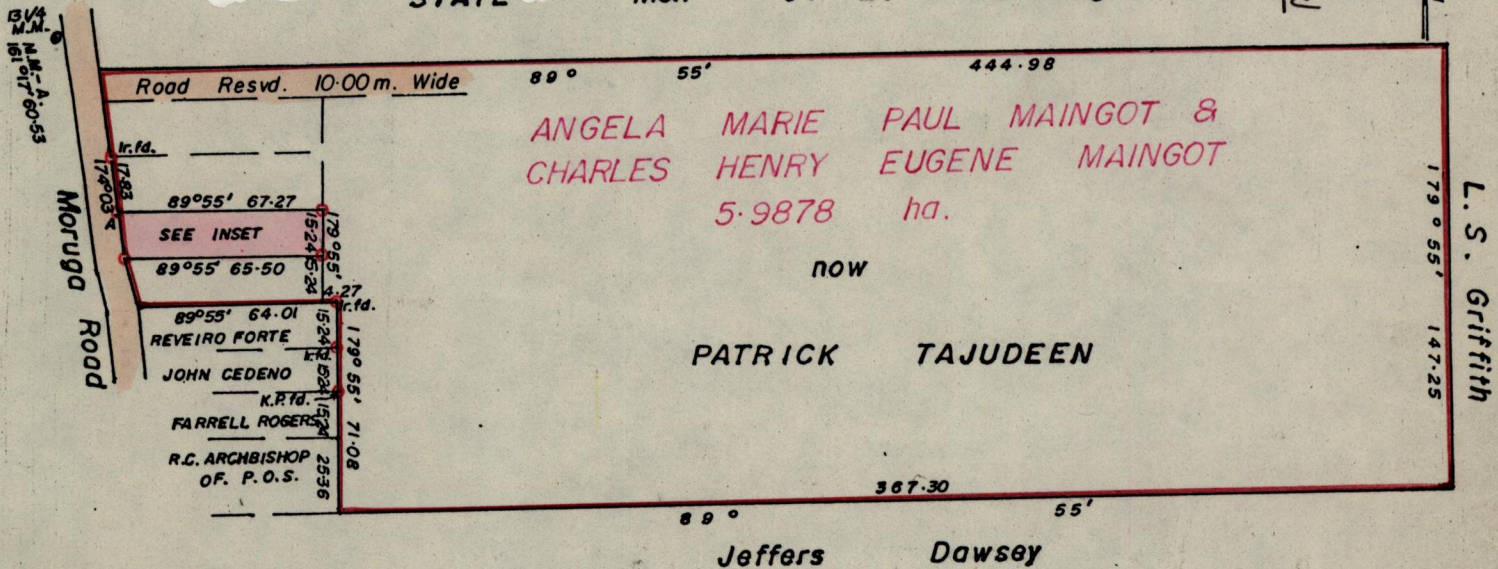

SCALE : 1:1000.  
Dist. are in metres.

Orig. Bk 317; 138

Approved

*J. Lewis Charles*  
Director of Surveys  
93.03.10

Matthew & Helen Balbosa  
SCALE 1:2500.

Note: To obtain compass bearings add/subtract 5 minutes Distances are in metres.

PLAN of a Parcel of land coloured pink in the Ward of Moruga.  
Containing point one zero one two hectare.

Surveyed by me, with due authority, in Jan. 1988.

I certify that I have complied with rule 76 under section 14(2)(d) of the  
Land Surveyors' Ordinance 1952, and that this plan is correct.

Checked by *A. Loh* 19/2/93

Entered *749* 1/103

Land Surveyor, Trinidad ... 23rd February 1988

G.P., Tr./To. -943-20,000-183

34-07-13