

R.P.O. Vol. 6 fol. 579 REMAINING PORTION

Cadastral Sheet  $\frac{14F}{1/a}$ , B.14.O. & P.

C.T. Vol. 1065 fol. 261

Ward of Arima

Vol. 4201 fol. 495

County of St. George

Process ~~LD~~ 66030

located  
①

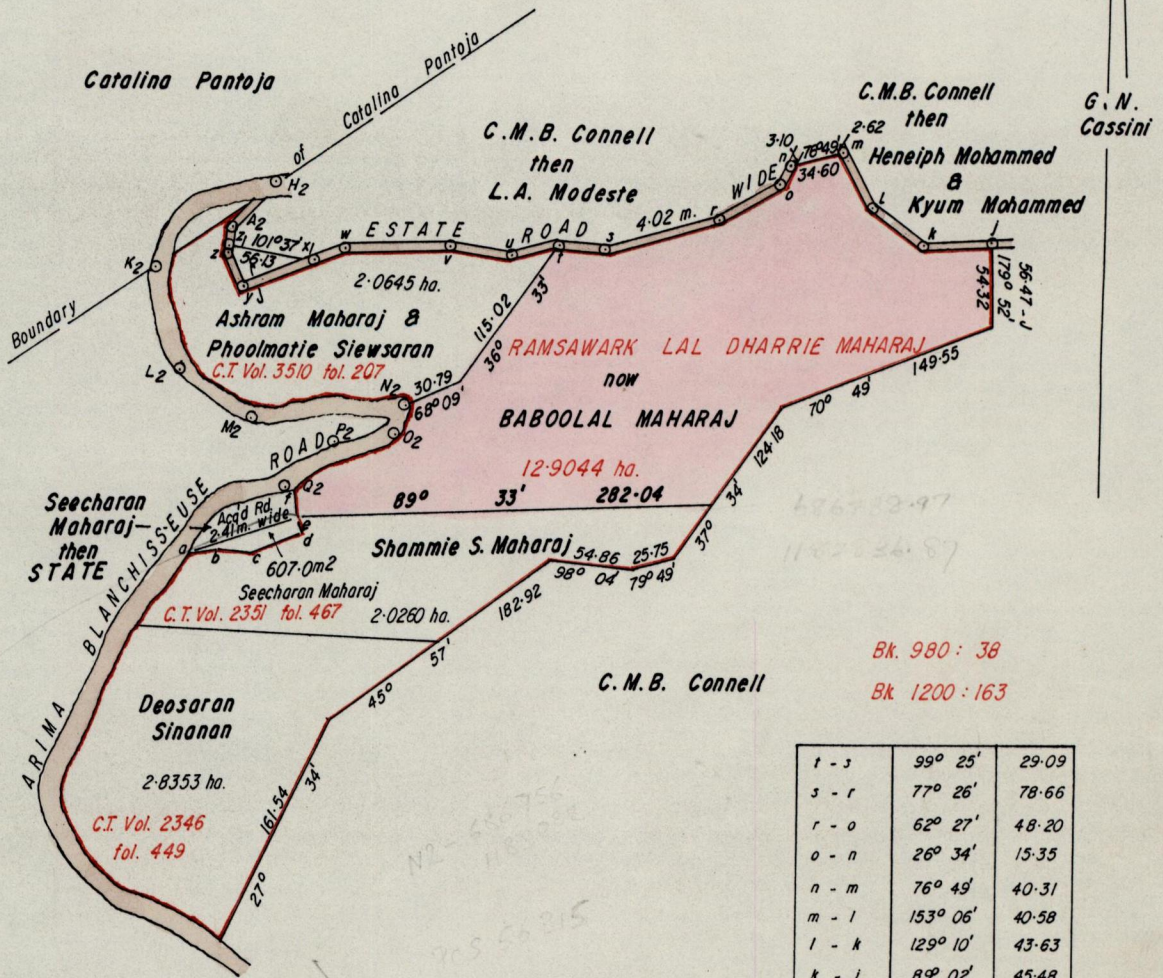

Bk. 980 : 38  
Bk. 1200 : 163

t - s	99° 25'	29.09
s - r	77° 26'	78.66
r - o	62° 27'	48.20
o - n	26° 34'	15.35
n - m	76° 49'	40.31
m - l	153° 06'	40.58
l - k	129° 10'	43.63
k - j	89° 02'	45.48
a - b	77° 08'	19.65
b - c	100° 01'	19.05
c - d	67° 39'	36.53
d - e	343° 09'	9.25
e - f	357° 11'	15.93
f - Q2	289° 14'	6.08
Q2 - P2	44° 29'	41.26
P2 - O2	87° 42'	42.45
O2 - N2	23° 48'	23.86

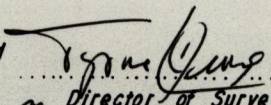
Approved   
Director of Surveys  
48.10.02

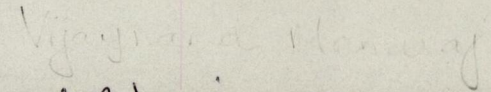
  
Vijeyrand Maharaj  
Scale 1 / 5000  
Distances are in metres  
Orig Plan C.E.30

This is a true copy of a diagram of twelve point nine zero four four hectares originally transferred to RAMSAWARK LAL DHARRIE MAHARAJ showing a portion coloured pink and containing five point nine seven eight six hectares being the remainder after three (3) previous transfer of another portion of the land. the dividing lines having been run in conformity with Rule 76 under section 14 (2)(d) of the Land Surveyors' Ordinance 1952, and duly certified by the Director of Surveys.

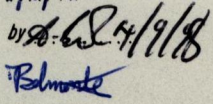
Ent. on  $\frac{13/8/93}{14F}$   
Checked by   
Land Surveyor, Trinidad & Tobago  
5<sup>th</sup> August 1998