

1282

L. & S.—54

No 25332
Process 30# 65879

v51 4244
R.P.O. Vol. 11.
C.T. Vol. 1149.

f01 523
Fol. 389.
Fol. 141.

Ward of Arima.
County of St. George.
Cadastral Sheet B. 25. A. $\frac{24C}{27c}$

Vide R H 87.

Cassini
G N

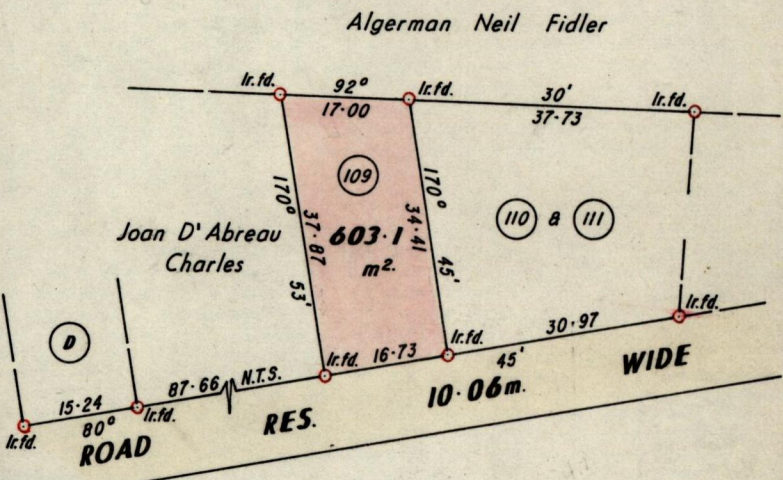
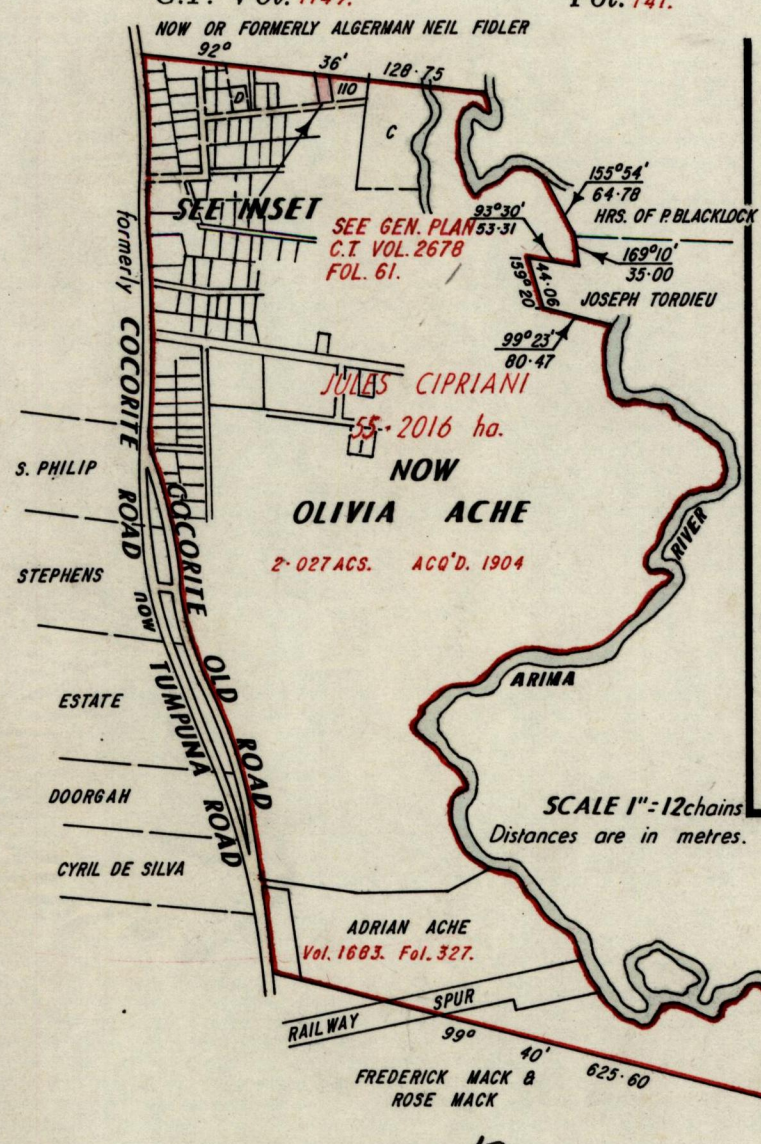

SCALE 1"=12chains
Distances are in metres.

Approved

[Signature]
Director of Surveys
97/2/5

Cleophas Thomas & ORS

SCALE 1:1000.

Note: To obtain compass bearings add/ ~~10~~ 10 minutes Distances are in metres.

PLAN of a Parcel of land coloured pink in the Ward of Arima.

Containing six hundred and three point one square metres.

Surveyed by me, with due authority, in January 1993.

I certify that I have complied with rule 76 under section 14(2)(d) of the Land Surveyors' Ordinance 1952, and that this plan is correct.

Checked by *[Signature]* 97.9.4

[Signature]

Entered *[Signature]* 9/103

Land Surveyor, Trinidad and Tobago 5th February 1993

G.P., Tr./To.—943—20,000—183

ENTERED: CMIS: *[Signature]*

E: 628784
N: 1176249