

Process ~~66023~~

R.P.O. Vol. 212  
C.T. Vol. 4308

Fol. 309  
Fol. 57

1282

Ward of Siparia.  
County of St. Patrick.  
Cadastral Sheet G.14.F. 64D  
1/d

46

Vol 4429 fol. 59

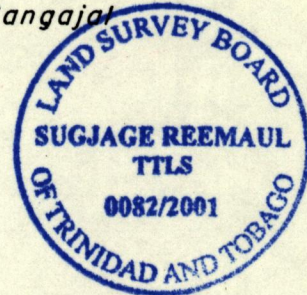
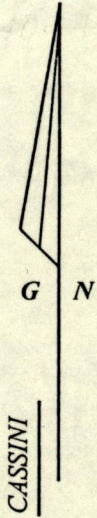
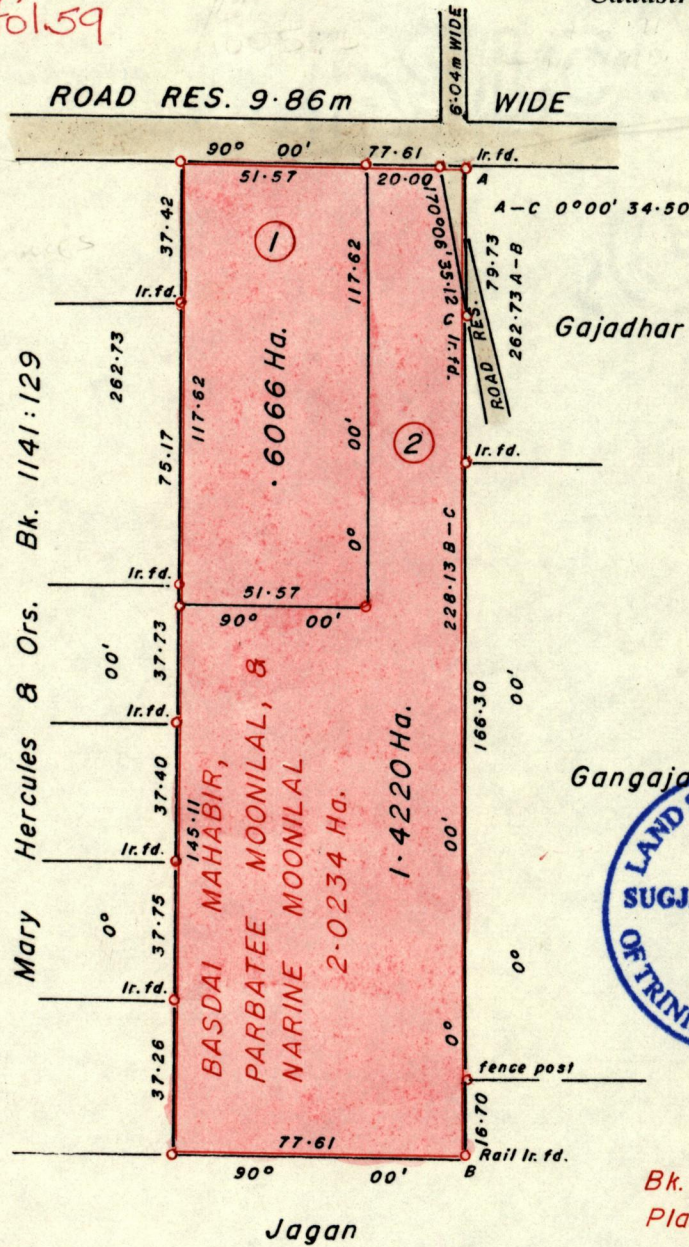

Bk. 834:36  
Plan E.C. 95

Approved

*[Signature]*  
Director of Surveys  
2002.02.18

○ Denotes Iron put unless otherwise stated  
Bearings are Cassini Grid based on Solar Obs.  
SCALE 1:2000.

Note: To Obtain compass bearings subtract 01 minutes Distances are in METRES

PLAN of 2 Parcels of land coloured PINK in the Ward of Siparia.  
Containing together two point zero two eight six hectares.  
Surveyed by me, with due authority, in September 2000.  
In accordance with Rule 25 (1), of the Land Surveyors Regulations 1998.  
I certify that this plan is correct.

Checked by *[Signature]* *[Signature]*

Entered 64D 8/03 *[Signature]* Trinidad and Tobago Land Surveyor. 15<sup>th</sup> March, 2001.  
*[Signature]* 07-06-13

Lot 1

Lot 2 Vol 4429 Fol. 67 Ralla Jagdeo

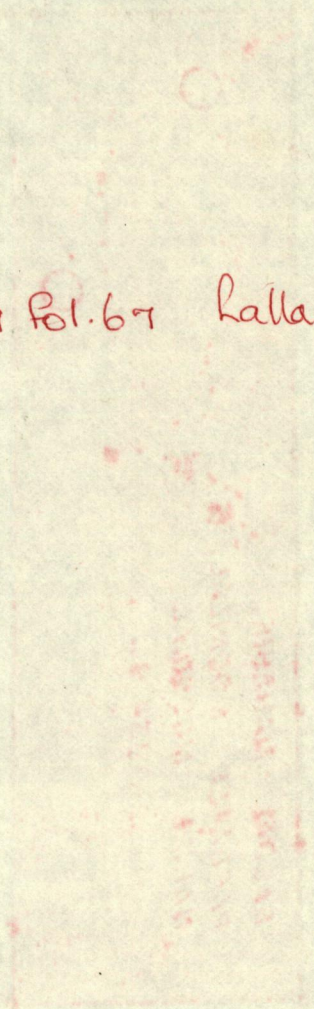
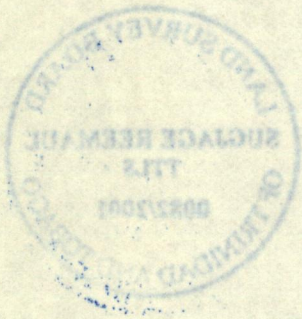

1-FEB 2002  
Lands and  
Surveys  
Division

1267/193