

Vol. 4432

Fol. 69

Process ID# 65974

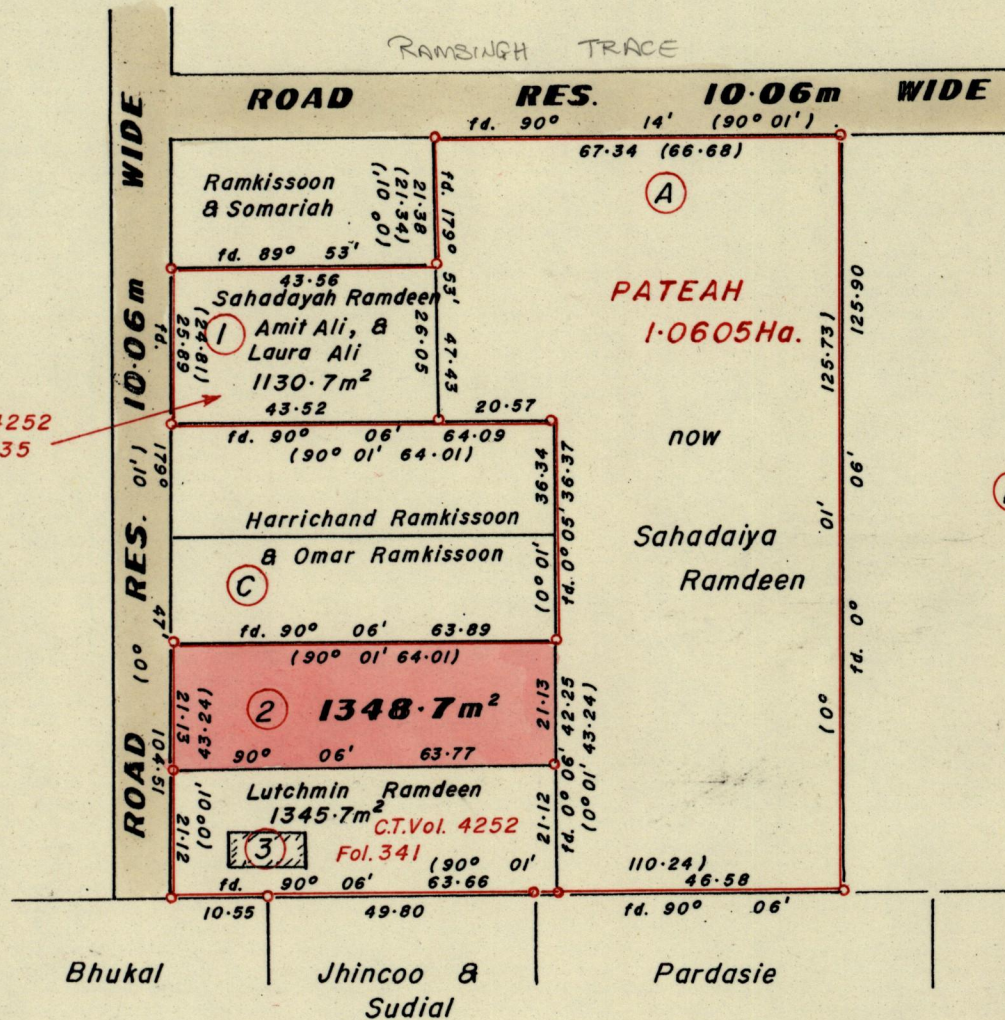

C.T. Vol. 4252
Fol. 335

Bk. 1189 : 136
Bk. 1249 Vol. 2 : 91
Bk. 1273 : 149.

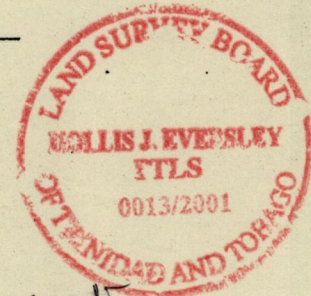

Lutchmin Ramdeen & Lisa Bastant

Approved

[Signature]
Director of Surveys
2002/11/21

○ Denotes Irons found unless otherwise stated

Bearings are Cassini Grid based on Solar Obs.
SCALE 1:1250.

Note: To Obtain compass bearings add/subtract

minutes

Distances are in METRES

PLAN of a Parcel of land coloured PINK in the Ward of Siparia.
Containing one thousand three hundred and forty eight point seven square metres.
Surveyed by me, with due authority, in February 1999.

In accordance with Reg. 25 (1) of the Land Surveyors' Regulations 1998,
I certify that this plan is correct.

Checked by M.M. 11/11/02

Entered M30 @ 8/03

Trinidad and Tobago Land Surveyor..... 15 N. 2000

CMIS 10-07-2013
[Signature]