

Process Ldt# 65955

B N^o 4220

R.P.O. Vol. 295

Fol. 205

C.T. Vol. 3580

Fol. 187

Ward of Toco

County of St. David

Cadastral Sheet (C.9.D) 6F
2/b

Remaining Portion Plan Vol. 3312 Fol. 335

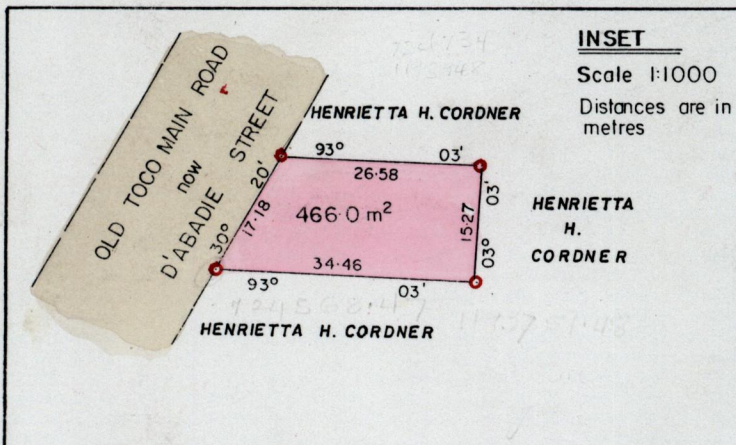
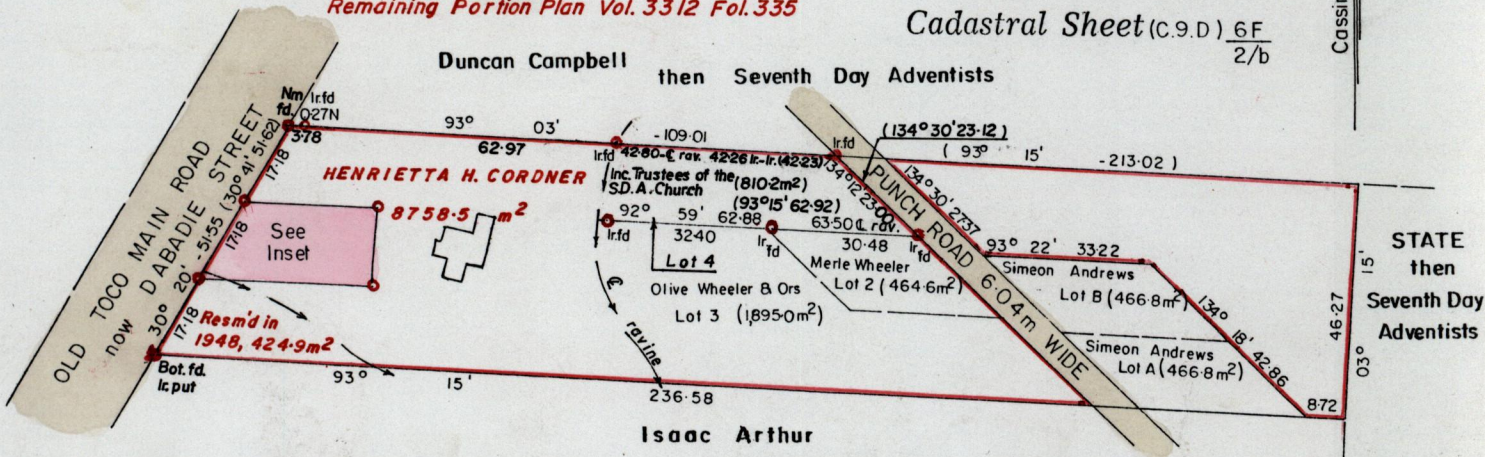

INSET
Scale 1:1000
Distances are in metres

E. 724734
N. 1193948

Lot	C.T. Vol	Fol
A	1770	213
B	1770	213
2	3580	195
3	3580	201
4	3699	37

Approved

[Signature]
Director of Surveys 1.9.2000

Bearings are based on solar observations

Note: To obtain compass bearings add/subtract 30

SCALE 1/1500 ● Denotes Iron put except where otherwise stated
Distances are in metres

PLAN of a Parcel of land coloured pink in the Ward of Toco

Containing four hundred and sixty six point zero square metres

Surveyed by me, with due authority, in May 1996

I certify that I have complied with rule 76 under section 14(2)(d) of the Land Surveyors' Ordinance, 1952, and that this plan is correct.

Checked by ... 00.09.17

Entered 6F 7/03

Land Surveyor, Trinidad and Tobago
[Signature] 21st May 1996

ENTERED: CHS: *[Signature]*

Bk 1282 Fol. 26
Vide Bk. 1197 Fol. 24 Original
Bk. 1227 Fol. 102

Merle Wheeler

Merle Wheeler