

R.P.O. Vol. 494 Fol. 326
C.T. Vol. Fol.
Vol. 4496 fol. 5

1282

Cadastral Sheet E.1.B. 25E
Ward of Tamana 3/a, 3/b
County of St. Andrew

Process JD#66136

Cumuto

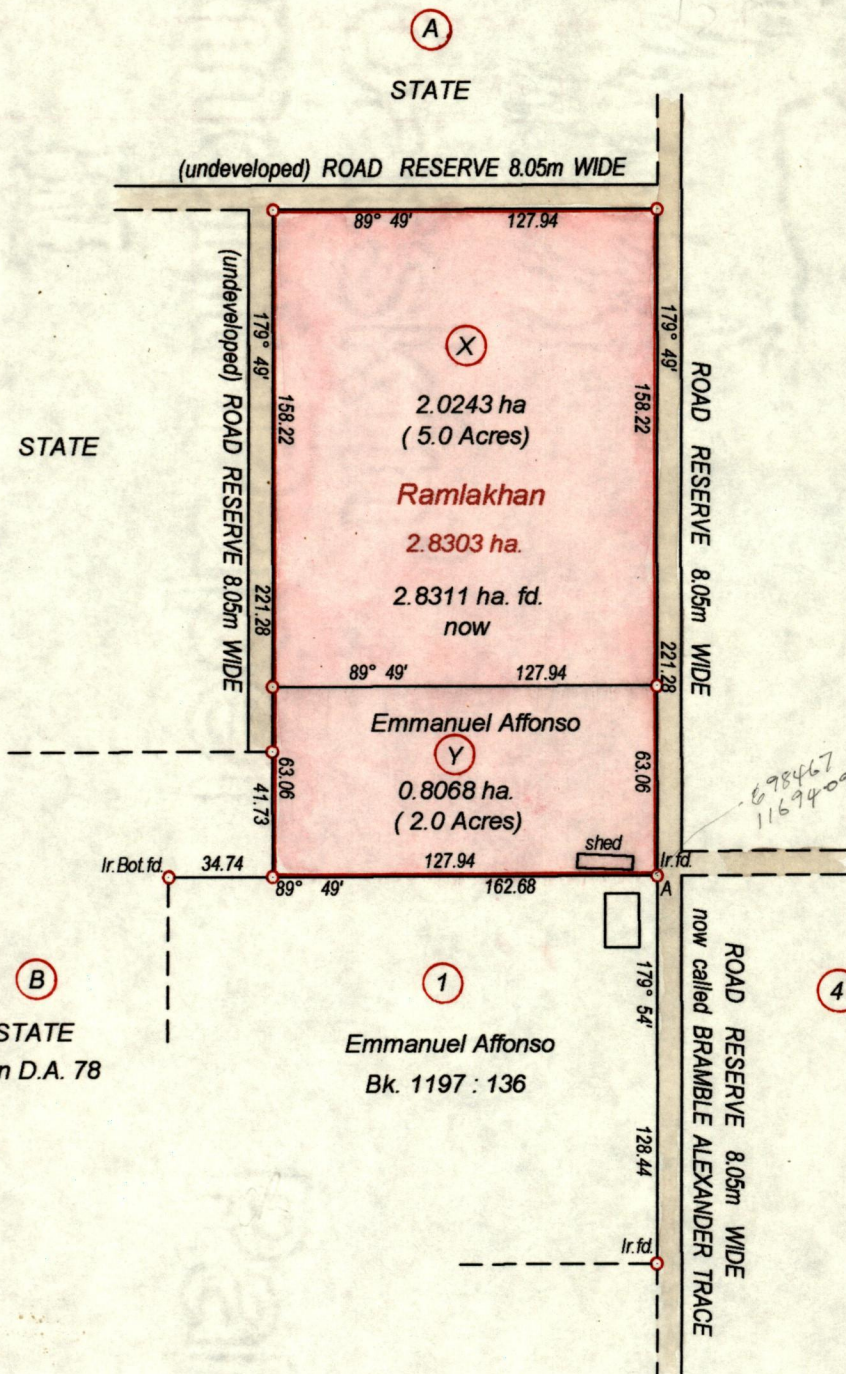
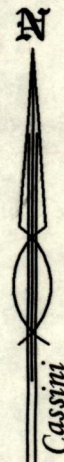

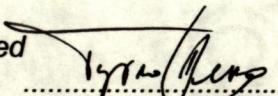
Approved 
Director of Surveys
2003.8.6

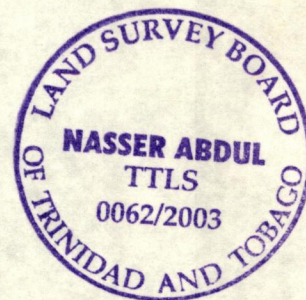

A- 698467
1169409

Vide Bk. 212 Fol. 320

Y to be amalgamated with 1

○ Denotes Iron put unless otherwise stated
Bearings are Cassini Grid based on Solar Obs.

SCALE : 1/2500
Distances are in metres

PLAN of two (2) parcels of land coloured pink in the Ward of Tamana
Containing together two point eight three one one hectares
Surveyed by me with due authority in March 2003.
In accordance with Regulation 25(1) of the Land Surveyors' Regulations 1998,
I certify that this plan is correct.

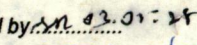
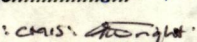
Checked by 
Entered on 25E 11/03
ENTERED: CHAIS' 

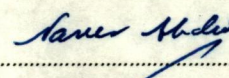
Trinidad & Tobago Land Surveyor... 27th March 2003

212

No.	C.T. Volume	Name
X	Vol. 4496 fol. 9	Peter M. Affonso & Nerissa Chantual Lisha Affonso
Y	Vol. 4803 fol. 55B	Emmanuel Affonso

-5 JUN 2003
Lands and
Surveys
Division

1279/94