

12832

No 28335

Process Id# 66168

R.P.O. Vol. 55

C.T. Vol. 3313

See Plan J.A.109

Vol. 4496 fol. 175

Fol. 623

Fol. 17

Ward of Turure

County of St. Andrew

Cadastral Sheet E.2.E. 25F/3/b

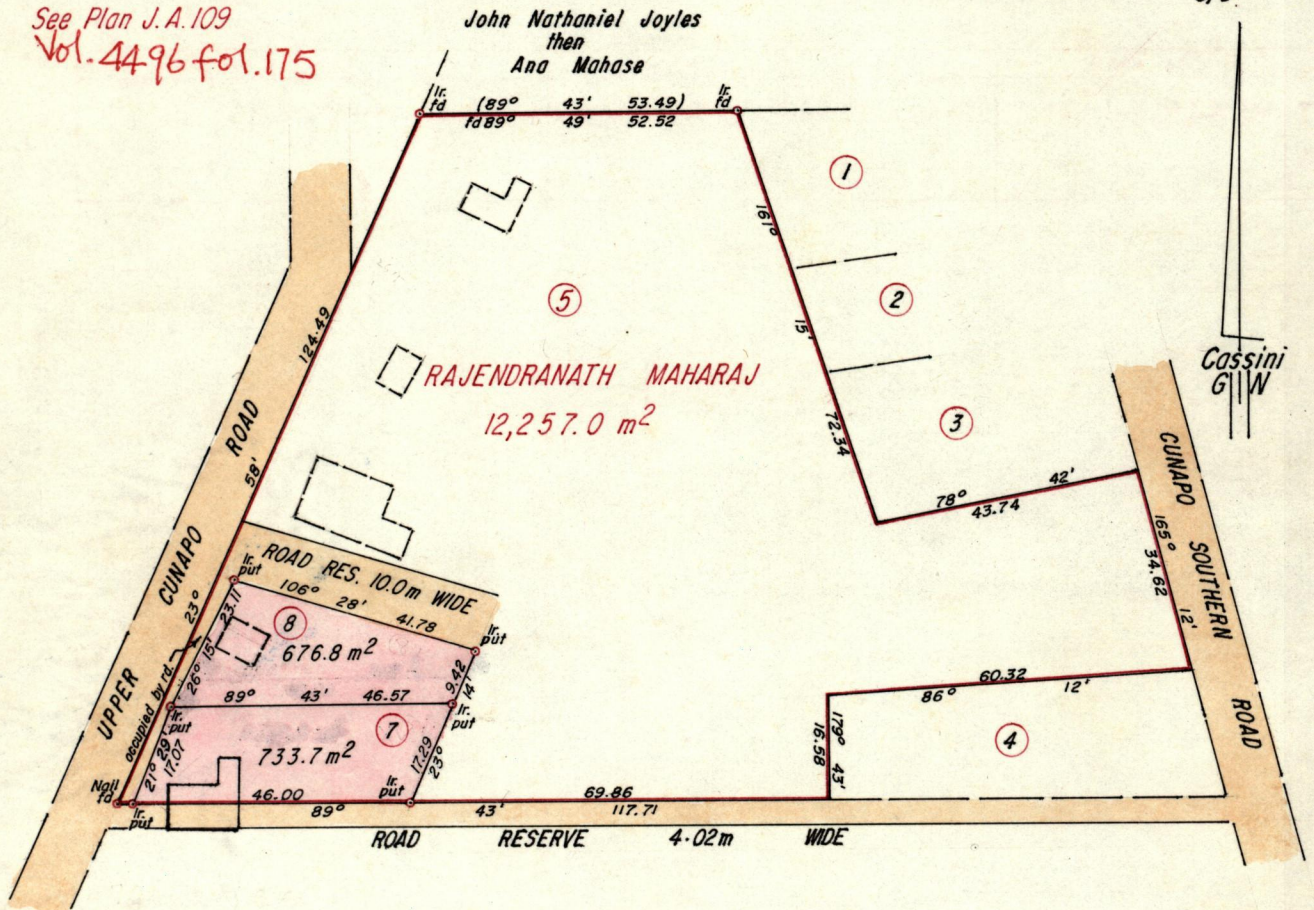

704209
1168391.
W45 84.

Approved *[Signature]*
Director of Surveys
94 03 29

Bearings are based on solar observations

SCALE 1:1250

Note: To obtain compass bearings add/subtract

minutes

Distances are in Metres

PLAN of 2 Parcelsof land coloured pink in the Ward of Turure
Containing together one thousand four hundred and ten point five square metres
Surveyed by me, with due authority, in July 1992

I certify that I have complied with rule 76 under section 14(2)(d) of the
Land Surveyors' Ordinance 1952, and that this plan is correct.

Checked by *[Signature]* 18/03/94

[Signature] Ramcharitar
Land Surveyor, Trinidad and Tobago 20/12/93

Entered 25F/3/b 11/03

G.P., Tr./To.-943-20,000-183

GANESH DATH RAMCHARITAR
LAND SURVEYOR

EIS

No.	C.T. VOLUME	Name
7	Vol. 4496 fol. 181	James Dodds & Sharon Mohammed-Dodds
8		

1155/666