

R.P.O. Vol. 122 Fol. 535

C.T. Vol. 1935 Fol. 385

Vol. 4509 fol. 449

Process ~~1282~~ 66154

Ward of Siparia

County of St. Patrick

Cadastral Sheet (G.12.H) 63.E

2/c

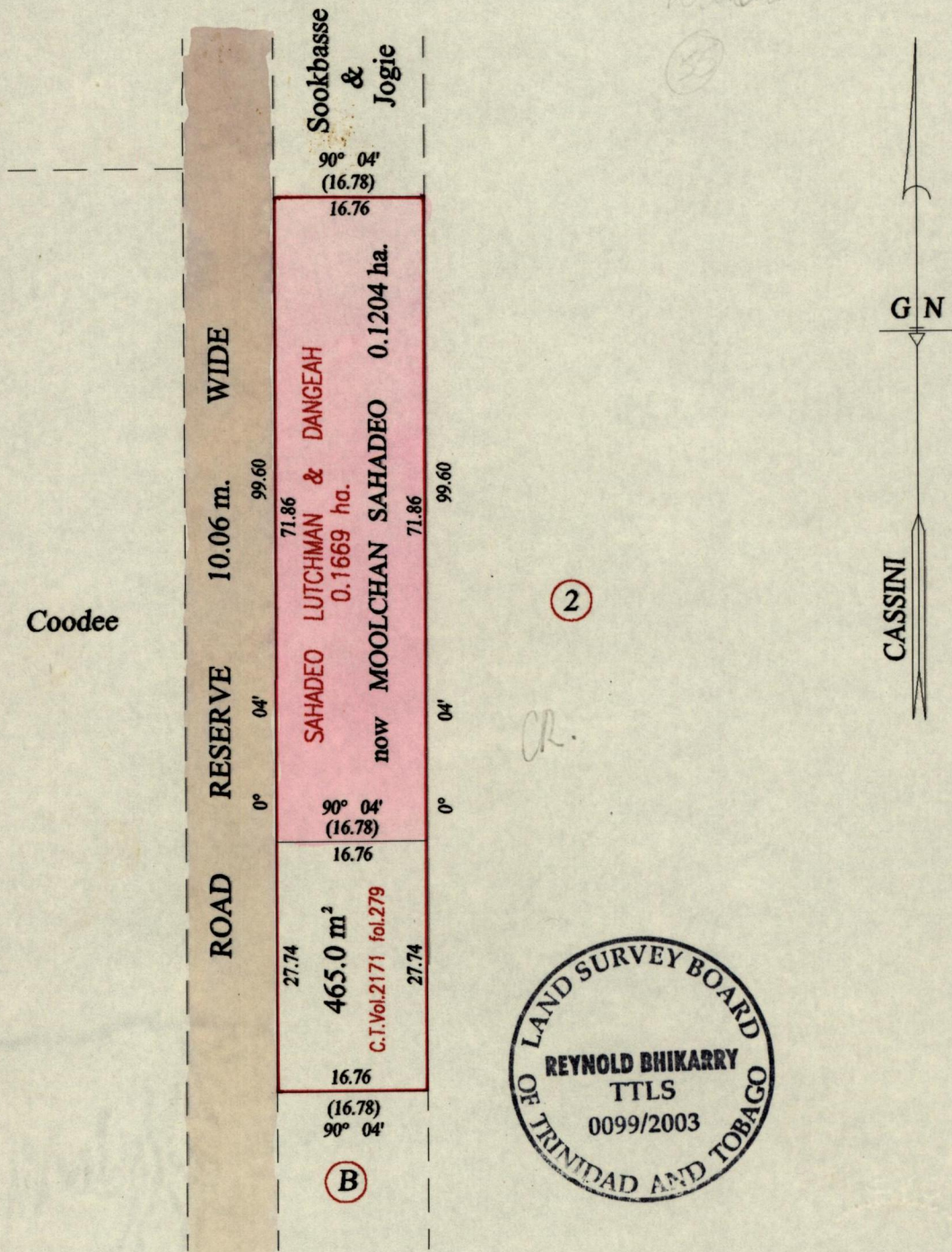

66323.72
112617.60
WGS 84.

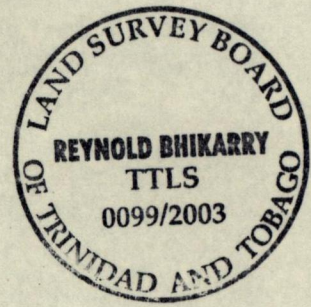

Moolchan Sahadeo & Ors
 Vide Bk.1017 fol.124
 Vide Bk.856 fol.52
 Vide Bk.1003 fol.68

Approved *[Signature]*
 Director of Surveys
 2003.8.29

Moolchan Sahadeo & Ors.
 SCALE : 1:750

Note: Bearings are cassini grid based on solar observations Distances are in metres
 This is a true copy of a diagram of zero point one six six nine hectare, originally transferred to Sahadeo Lutchman and Dangeah, shewing a portion coloured pink and containing zero point one two zero four hectare being the remainder after one (1) previous transfer of another portion of the land.
 In accordance with Regulation 25 (1) of the Land Surveyors' Regulations 1998, I certify that this plan is correct.

Checked by *Reynold Bhikarry*

Entered on *63E PA 11/03* Trinidad & Tobago Land Surveyor ... *2nd August* ... 2003