

Process LD#66038

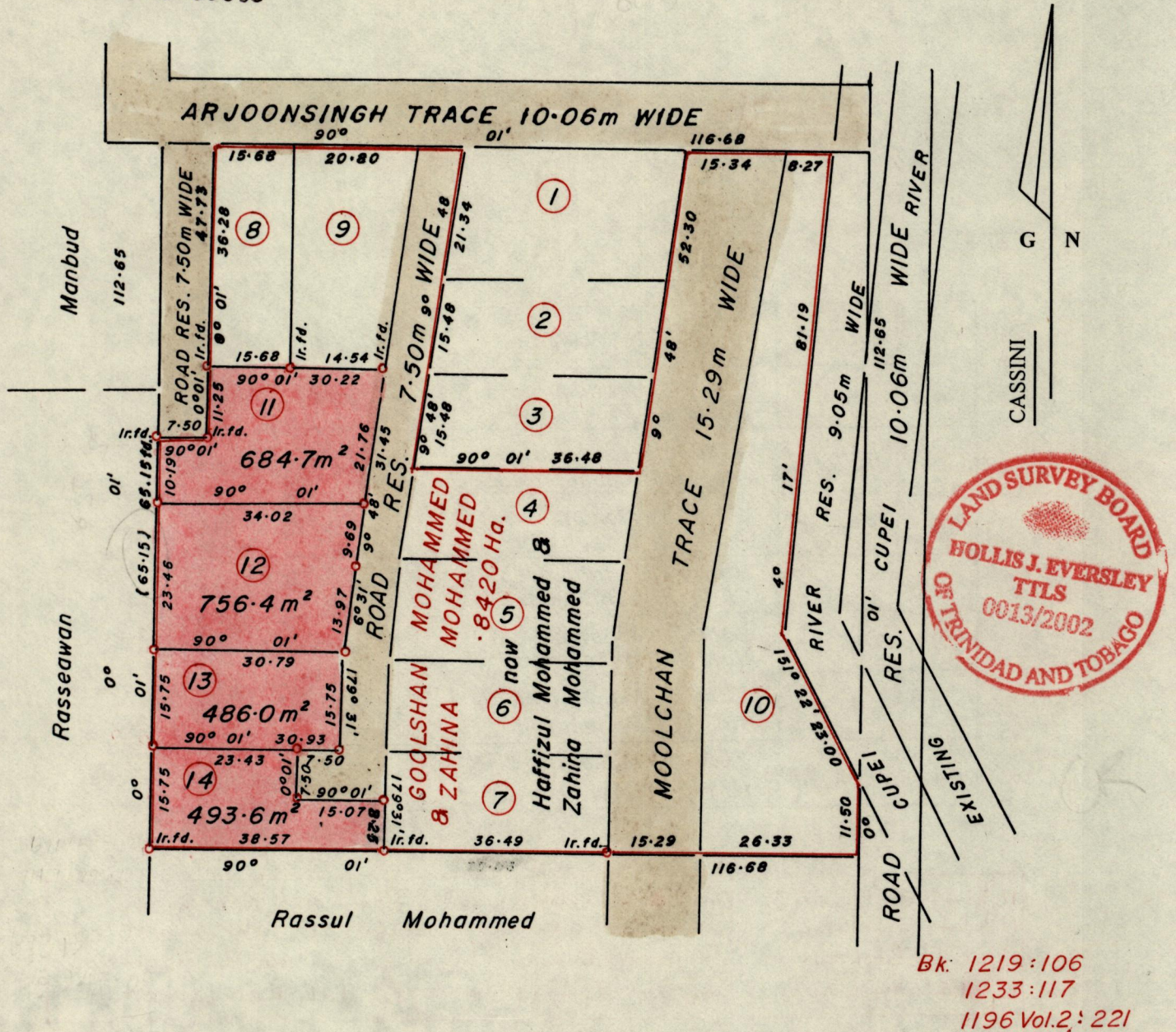

Bk: 1219:106
 1233:117
 1196 Vol.2: 221

Approved
[Signature]
 Director of Surveys 2003.3.20

Denotes Iron put unless otherwise stated
 Bearings are Cassini Grid based on Solar Obs.
 SCALE 1:1000.

Note: To Obtain compass bearings add/subtract minutes Distances are in METRES

PLAN of 4 Parcels of land coloured PINK in the Ward of Siparia.
 Containing together two thousand four hundred and twenty point seven square metres.
 Surveyed by me, with due authority, in July 1998.
 In accordance with Regulation 25 (1) of the Land Surveyors' Regulations 1998,
 I certify that this plan is correct.

Checked by *[Signature]*

Entered *[Signature]* 13-06-13 Trinidad and Tobago Land Surveyor.....2001.

Lot No.	AREA	NAME	C.T. Vol.	Fol.
4	557 m ²	Zahina Mohammed & Haffizul Mohammed	3871	339
5	557.1 m ²	Zahina Mohammed & Haffizul Mohammed	3871	345
6	556 m ²	Zahina Mohammed & Haffizul Mohammed	3871	351
7	556 m ²	Jagdesh Dabiedeen & Sherry Dabiedeen	3849	431
8	568.9 m ²	Zahina Mohammed & Haffizul Mohammed	4029	405
9	641 m ²	Zahina Mohammed & Haffizul Mohammed	4029	411
10	1714.4 m ²	Zahina Mohammed & Haffizul Mohammed	4029	417

11	Vol. 4458 fol. 225	Zahina Mohammed & Haffizul Mohammed
12	Vol. 4458 fol. 227	Zahina Mohammed & Haffizul Mohammed
13	Vol. 4458 fol. 211	Jaipersad Kempo & Wendy Beulah Ramsaroop
14	Vol. 4458 fol. 219	Jaipersad Kempo & Wendy Beulah Ramsaroop

20 MAR 2002
Lands and
Surveys
Division

1271/578