

Process SD#66029

R.P.O. Vol. 81

C.T. Vol. 1957

Vol. 4320 fol. 497

Fol. 97

Fol. 501

1282

Ward of Siparia .

County of St. Patrick .

Cadastral Sheet (G.13.F), 63E

1/c&3/a.

located  
570

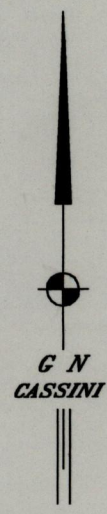
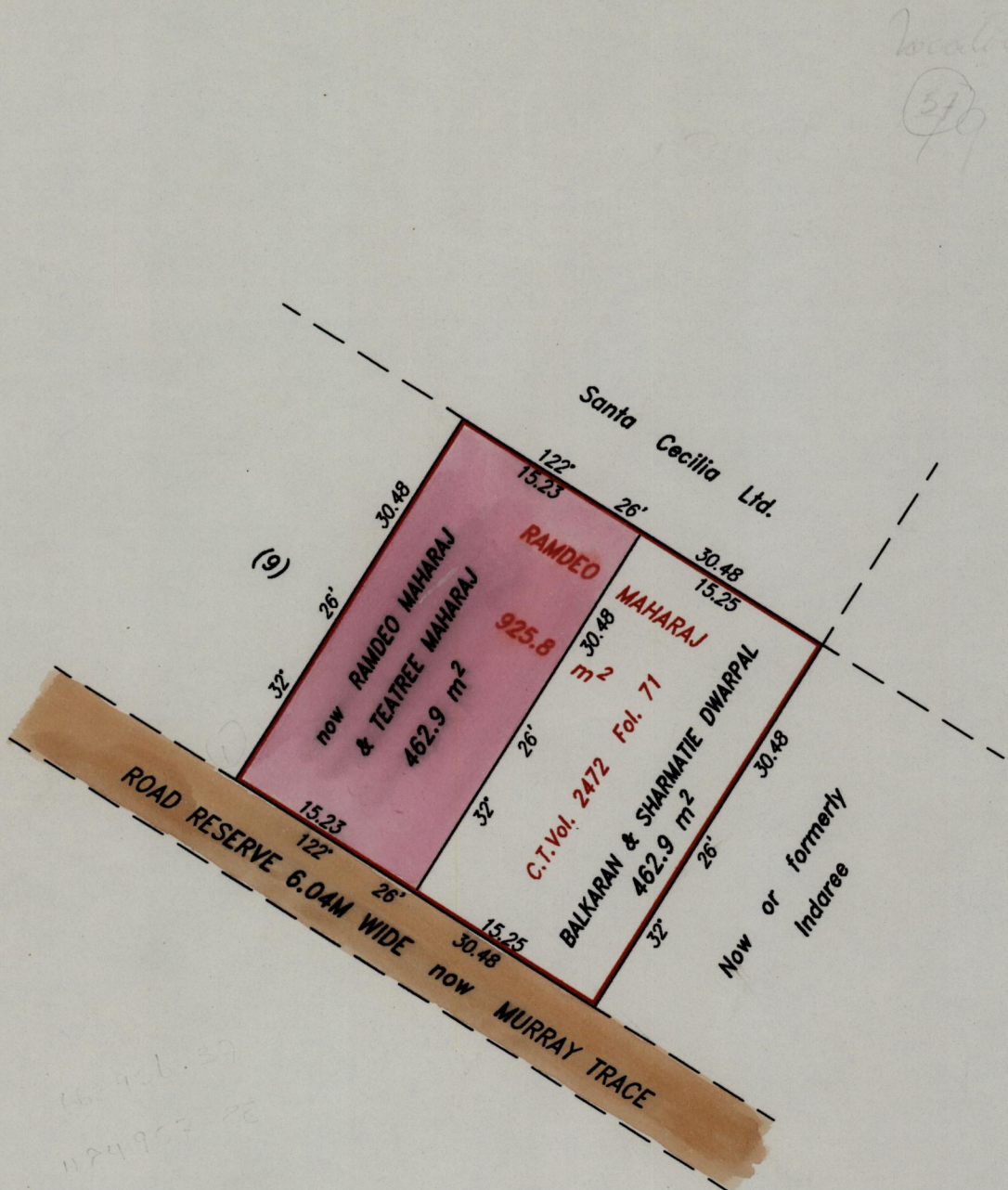

663956  
1124958  
WGS 84

Ramdeo Maharaj  
Teatree Maharaj  
Ganeshdath Maharaj

Ganeshdath Maharaj  
Teatree Maharaj  
Ramdeo Maharaj

Approved

*[Signature]*  
 Director of Surveys  
 2007.8.14

Note : To obtain compass bearings subtract 4 minutes

This is a true copy of a diagram of nine hundred and twenty five point eight square metres originally transferred to Ramdeo Maharaj, shewing a portion

coloured pink and containing four hundred and sixty two point nine square metres being the remainder after one (1) previous transfer of a portion of the land.

In accordance with Rule 25 (1) of the Land Surveyors Regulations 1998,

I certify that this plan is correct.

Checked by *[Signature]*

Entered on 10/11/03 CE 6 RE

OMIS 10-07-2013

*[Signature]*  
 Trinidad & Tobago, Land Surveyor.....2000  
 31/7/

Orig R.F. 22

See Bk. 1110 : 2

SCALE 1:500

Distances are in metres

