

Process #66022
R.P.O. Vol. 168 Fol. 535
C.T. Vol. Fol.
Vol. 4471 fol. 67

12832
12832 Ward of Siparia
County of St. Patrick

Cadastral Sheet G.13.0 63F & 73C
3/d & 1/b

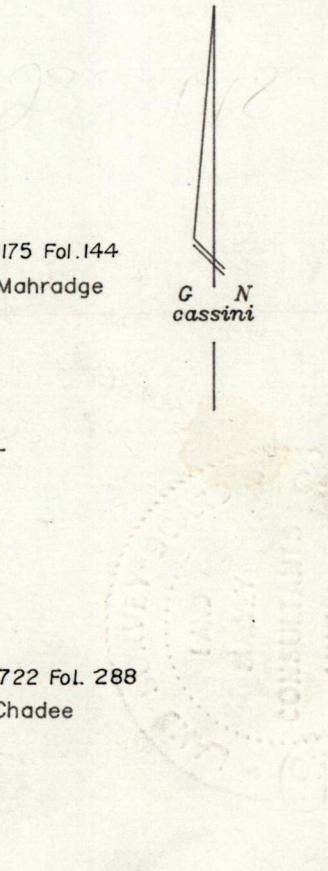
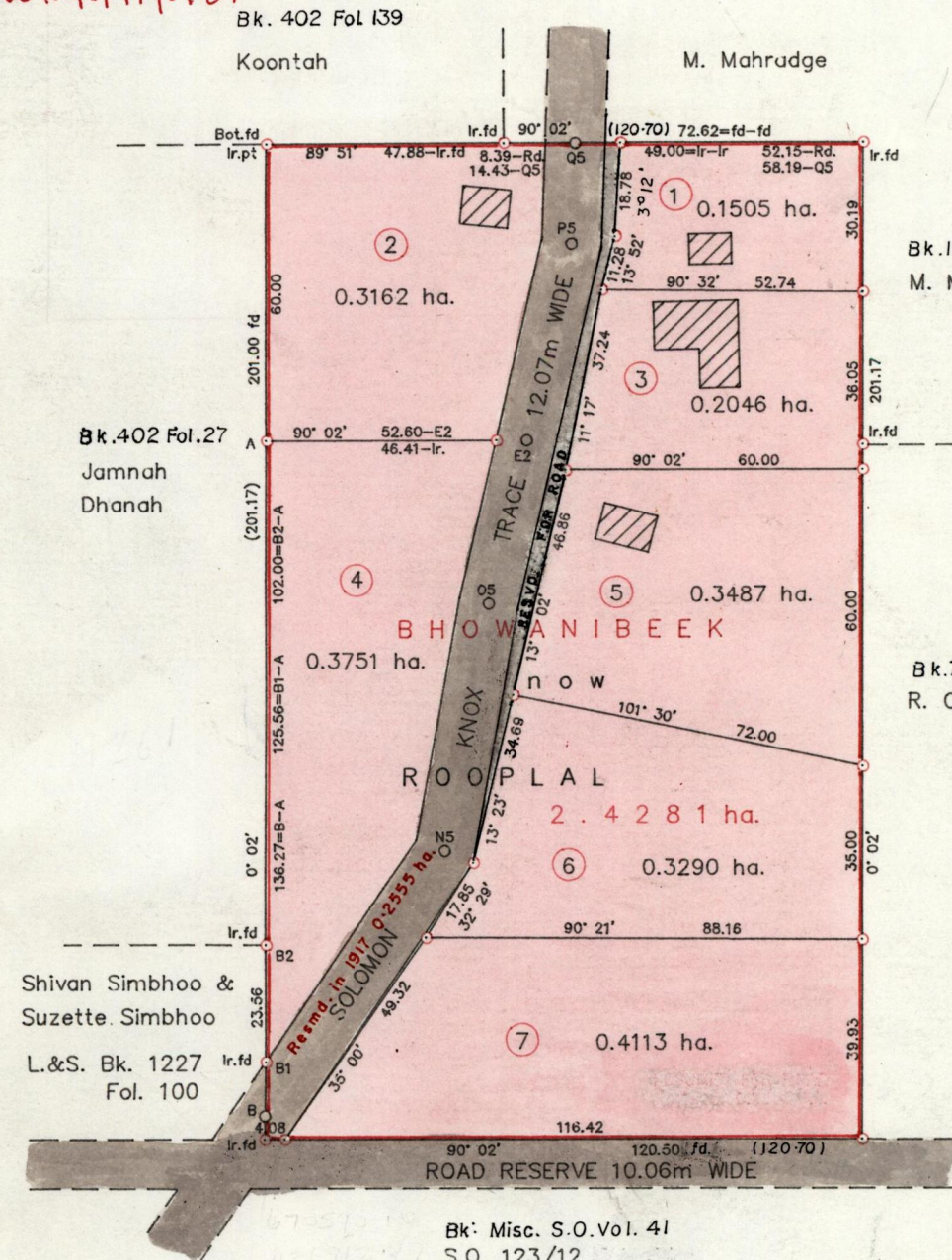

Approved
[Signature]
Director of Surveys
2003.07.20

Bk: Misc. S.O. Vol. 41
S.O. 123/12
K.E.55
Bk. 1175 Fol. 144
Bk. 402 Fol. 41

SCALE 1/1500
Distances are in metres

Ir.pt	270° 02'	Q5	20.31	89° 02'	Ir.pt
	6.04			6.04	
	14.43-fd			9.19-lr.	
		P5	1' 59'		
		P5	75.08		
		=E2			
	270° 02'		34.21		
Ir.pt	6.19				
		OF SOLOMON KNOX TR.			
		O5	12' 47'		
		O5	50.59		
		N5	10' 08'		
		N5	64.25		
Ir.pt	0' 02'			180° 02'	Ir.pt
B1	10.71			4.73	
		B	34' 18"		

○ Denotes Ir.pt except otherwise indicated.
Note: To obtain compass bearings subtract 2 minutes.

PLAN of 7 Parcels of land coloured pink in the Ward of Siparia
Containing together two point one three five four hectares.
Surveyed by me with due authority in September 2000

In accordance with Regulation 25(1) of the Land Surveyors' Regulations 1998,
I certify that this plan is correct.

Checked by M.M. 12/12/02

G.R. Jardine T.T.L.S.

Entered 11/1/03. Ce. 63F & 73C
12-06-13

Trinidad & Tobago Land Surveyor..... 19/3/2001

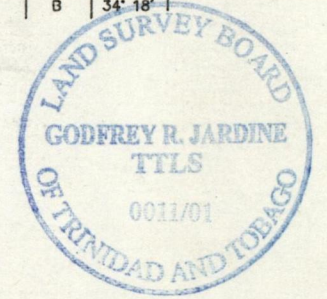

No.	C.T. Vol.	fol.	Name
1	Vol. 4471	fol. 71	Manwatee Rooplal & Rooplal Sookhoo
2	Vol. 4471	fol. 119	Michael & Indira Rooplal
3	Vol. 4471	fol. 111	Rodney & Kathleen Raghunath
4	Vol. 4471	fol. 103	Silvan Ramlochan & Patricia Ramlochan
5	Vol. 4471	fol. 95	Glenn Rooplal
6	Vol. 4471	fol. 79	Linda & Kristal Ramnaran
7	Vol. 4471	fol. 87	Angela Charles & Rooplal

-6 MAR 2002
Lands and
Surveys and
Division

1271/219