

1282
1282

176

Process LD#66013

R.P.O. Vol Fol
C.T. Vol 2108 Fol 215

Vol. 4235 fol. 377

Ward of Siparia
County of St. Patrick
Cadastral Sheet G. 12. D. $\frac{63E}{2/a}$

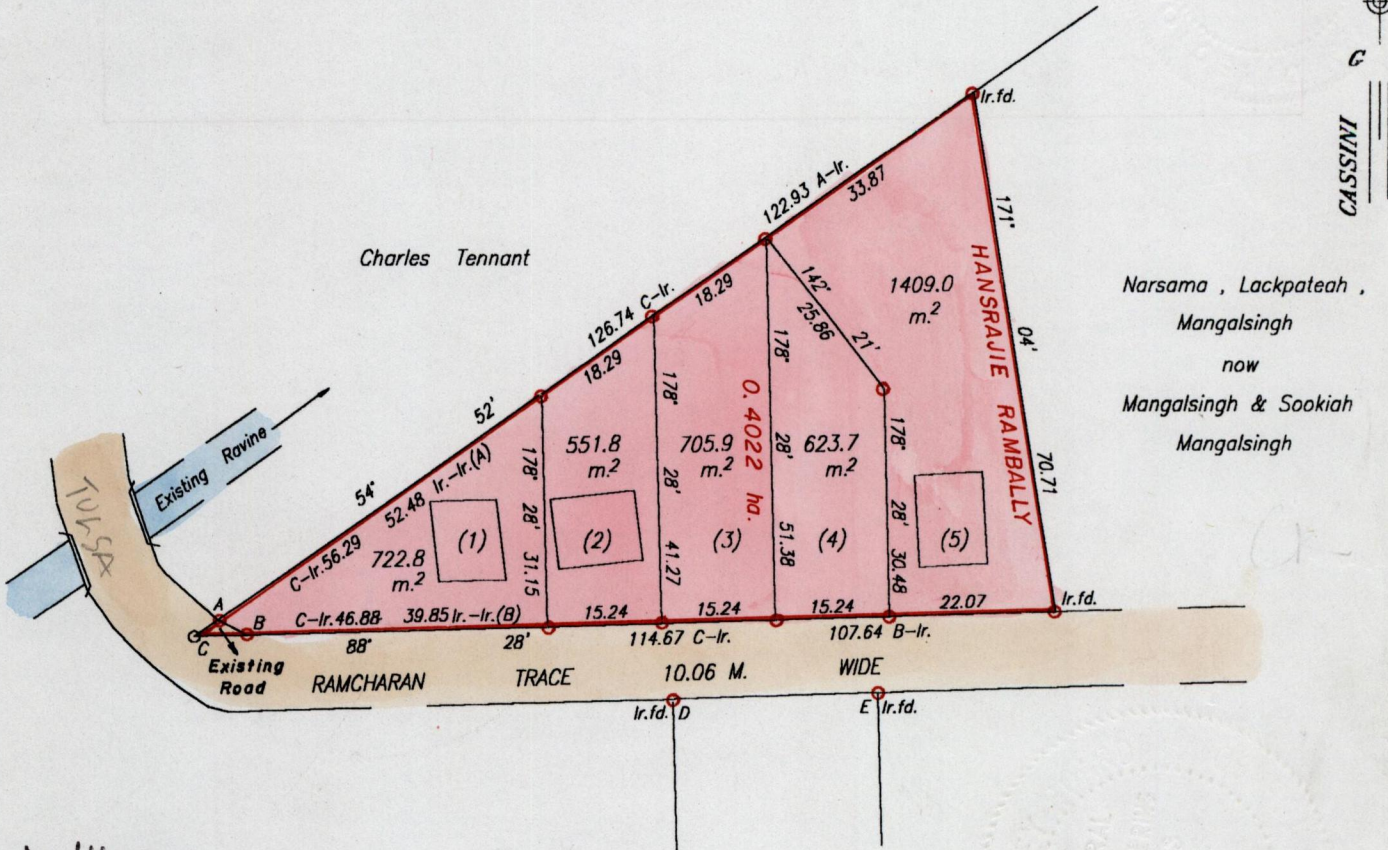

A - 666454.79
1126766.33
WQSS4.

A-B	117° 06'	4.40
C-D	97° 54'	64.26
C-E	95° 00'	91.35

Approved *[Signature]*
Director of Surveys
99.10.02

See Bk. 1003 Fol. 127

○ Denotes Iron put except stated otherwise
Note: To obtain compass bearing subtract 4 minutes
Plan of 5 Parcels of land coloured pink in the Ward of Siparia.
Containing together four thousand and thirteen point two square metres.
Surveyed by me, with due authority in, January 1999
I certify that I have complied with rule 25 (1) of the
Land Surveyors' Regulations 1998, and this plan is correct.

SCALE 1:1000

Distances are in metres

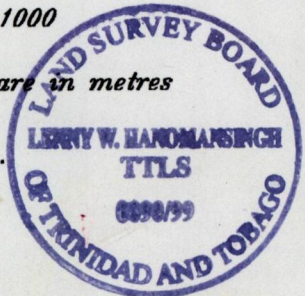

Checked by *[Signature]*
Entered *[Signature]*
C.M.S. 24/05/2012

[Signature]
Trinidad & Tobago, Land Surveyor 12/08.1999

original . BK. 1003 fol. 127

No.	C.T. Vol.	Name
1	Vol. 4235 Fol. 385	Steram Rambally
2	Vol. 4235 Fol. 387	Sajdaye Harripersad
3	Vol. 4235 Fol. 389	Sukdaye R. Singh
4	Vol. 4235 Fol. 391	Kamaldaye Ramsaroop
5	Vol. 4235 Fol. 393	Chaitam Rambally



1249/233