

REMAINING PORTION

1232

Process ID# 65998
R.P.O. Vol. 118 Fol. 511
C.T. Vol. 2251 Fol. 459
Vol 4492 Fol 153

Ward of Charuma
County of Nariva
Cadastral Sheet (H.2.B) 55.B.
3/d

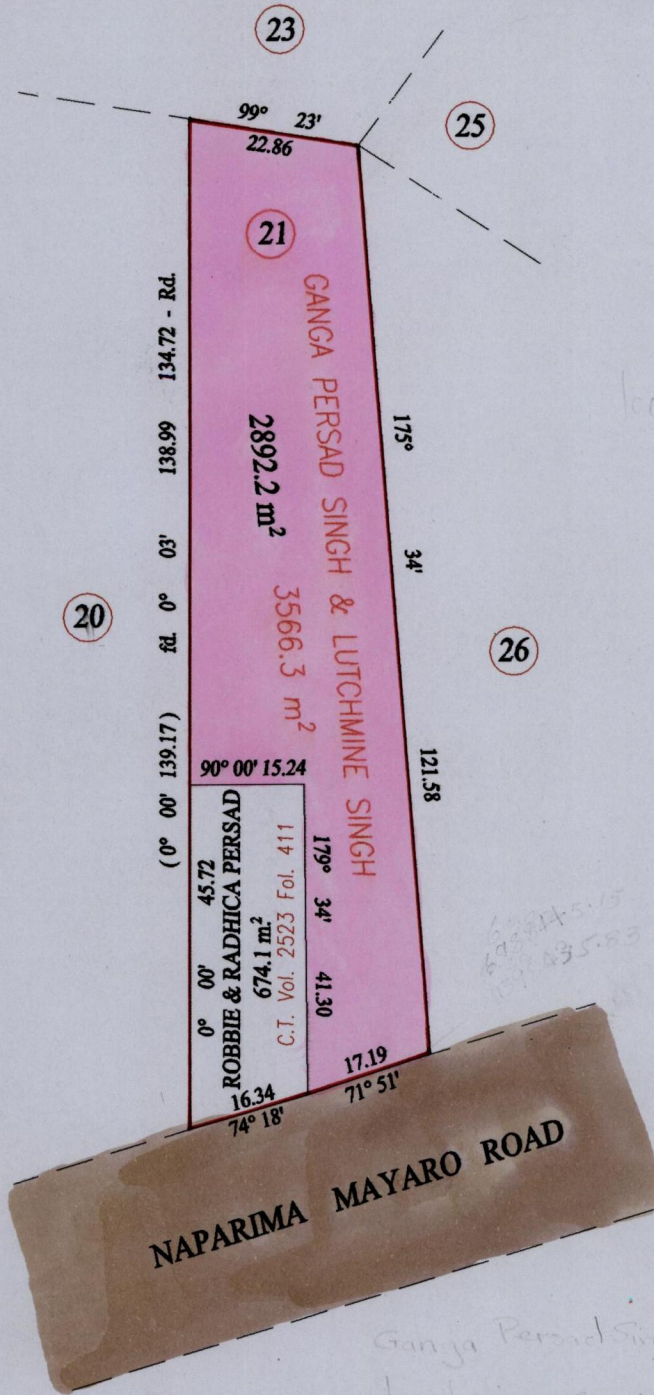

Ganga Persad Singh & Lutchmine Singh
Lutchmine Singh
Ganga Persad Singh & Lutchmine Singh

Vide Plan P.G.67

Approved *[Signature]*
Director of Surveys
2003.8.28

SCALE : 1:1000

Note: Bearings are cassini grid based on solar observations

Distances are in metres

This is a true copy of a diagram of three thousand five hundred and sixty six point three square metres, originally transferred to GANGA PERSAD SINGH AND LUTCHMINE SINGH, shewing a portion coloured pink and containing two thousand eight hundred and ninety two point two square metres being the remainder after one (1) previous transfer of another portion of the land.

In accordance with Regulation 25 (1) of the Land Surveyors Regulations 1998, I certify that this plan is correct.

Checked by *[Signature]*

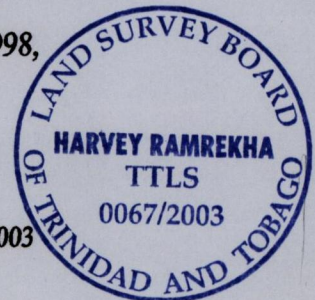

Entered on 6/11/03. 69. 55B Trinidad & Tobago Land Surveyor 22.07.2003

Entered: *[Signature]*