

R.P.O. Vol. 119 Fol. 597

Cadastral Sheet 6.18.F 73C / 1/d

C. of T. Vol. 1223 Vol. 399

Ward of Siparia

Remaining portion plan filed in Vol. 1571 fol. 73

County of St. Patrick

Vol. 4485 fol. 5

Vide L&S Bk. 1179 fol. 147

Procese Id# 66156

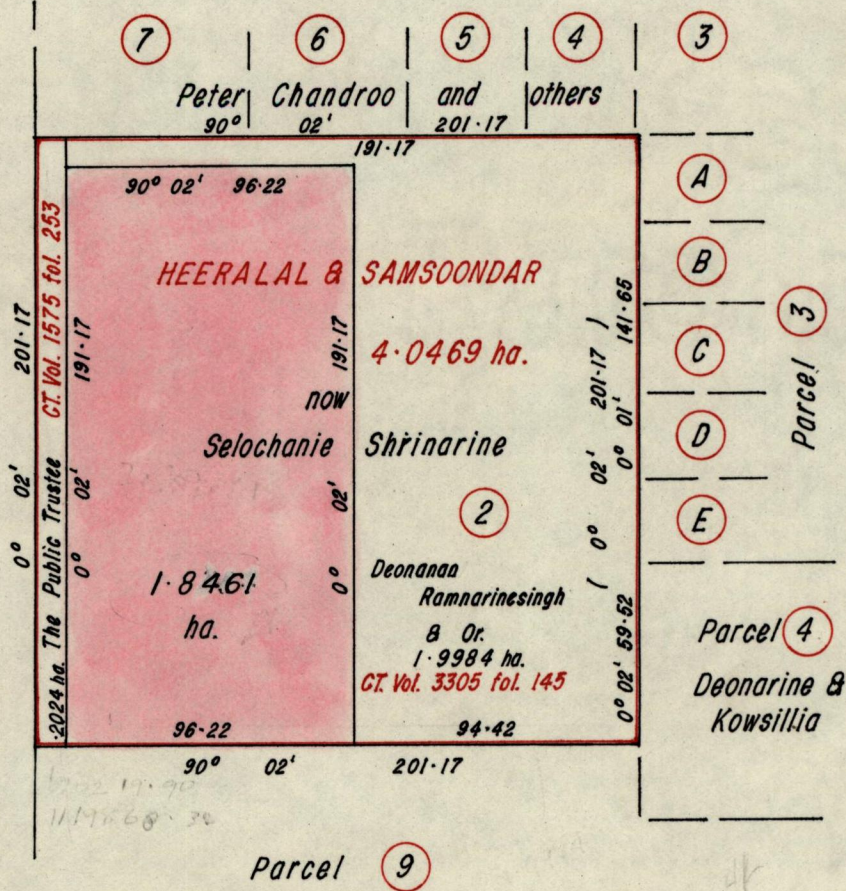

Approved

[Signature]
 Director of Surveys
 98.12.23

Note: To obtain compass bearings ^{add} 2 minutes _{subtract}

Selochanie Shrinarine
Orig. Bk 952:39

SCALE 1: 2500

Distances are in metres.

This is a true copy of a diagram of **four point zero four six nine hectares** originally transferred granted to **HEERALAL & SAMSOONDAR**, shewing a portion coloured pink and containing **one point eight four six one hectares** being the remainder after **two (2)** previous transfers of ~~another~~ portions of the land. the dividing lines having been run in conformity with Rule 76 under Sec. ~~7(d) of Cap. 27, No. 5~~ **14 (2)(d) of the Land Surveyors' Ordinance 1952** and duly certified by the Director of Surveys.

Checked by *[Signature]* 98.12.11

Entered on 73C 10/03

[Signature]
 Land Surveyor, Trinidad, 1996.