

REMAINING PORTION

1282

131

R.P.O. Vol. 36 Fol. 263

C.T. Vol. 816 Fol. 51

U.P.R.N. No.:

Vol. 4475 Fol. 17

Process 12# 66152

Ward of Naparima

County of Victoria

Cadastral Sheet G.8.N. 63B
4/d

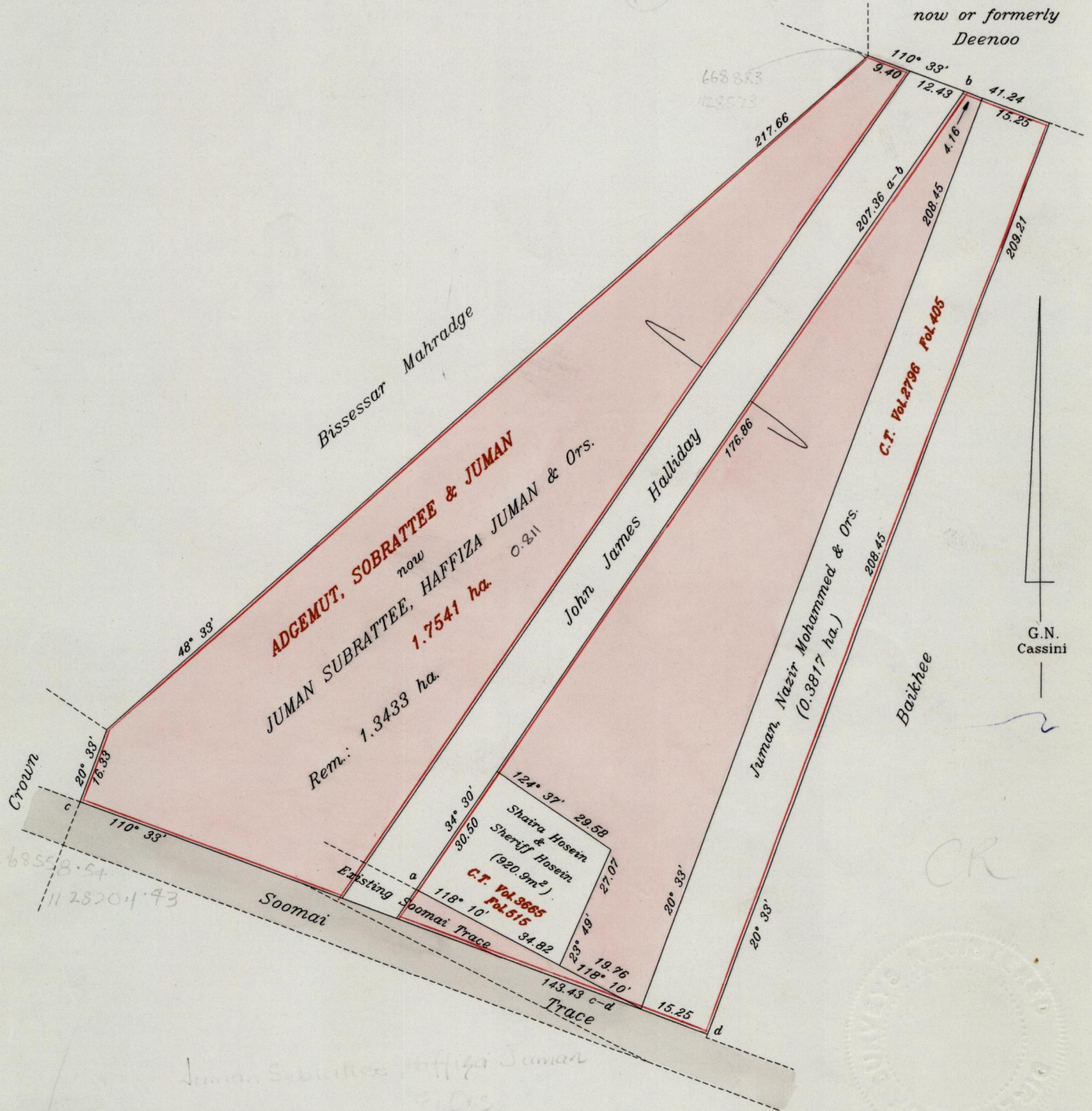

Approved

[Signature]
Director of Surveys
2002-03-05

Juman Subrattee &
Haffiza Juman
& Ors

Reference: Bk. 1219 Fol. 113

Original Bk. 1141 Fol. 119

SCALE 1: 1250

Distances are in metres

This is a true copy of a diagram of one point seven five four one hectares originally transferred to ADGEMUT, SOBRATTEE & JUMAN, showing a portion coloured pink and containing one point three four three three hectares being the remainder after two (2) previous transfers of another portion of the land. In accordance with Rule 25(1) of the Land Surveyors' Regulations 1998, I certify that this plan is correct.

Checked by

[Signature]

Entered

63B 10/03

Entered:

[Signature]

Trinidad & Tobago Land Surveyor

[Signature]
7/6/2001

