

1282

129

R.P.O. Vol. 262
C.T. Vol. 4202

Fol. 463
Fol. 135

Ward of Siparia.
County of St. Patrick.
Cadastral Sheet G.14.M. 63F
4/d

Vol. 4465 Fol. 39.

Process ID# 66149

Located

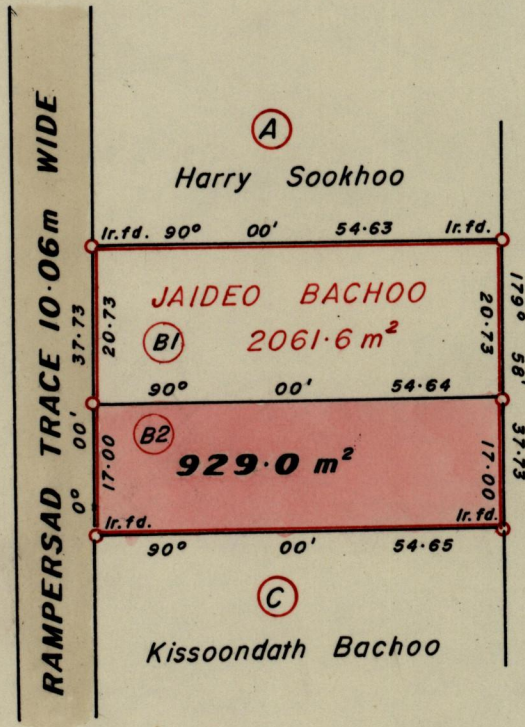
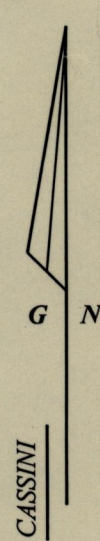

Sahadeo Baychoo
&
Sanmath Bachoo

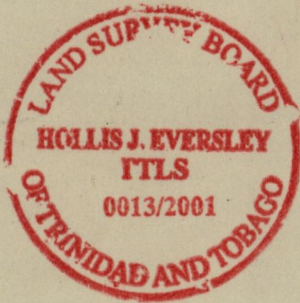

Bk. 1249 Vol. 2 : 68

Approved

[Signature]
Director of Surveys
2002.11.21

Rostant & Khamatee Ramsahai
Rostant & Khamatee Ramsahai

○ Denotes Iron put unless otherwise stated

Bearings are Cassini Grid based on Solar Obs.
SCALE 1:1000.

Note: To Obtain compass bearings subtract 01 minutes Distances are in METRES

PLAN of a Parcel of land coloured PINK in the Ward of Siparia.
Containing nine hundred and twenty nine point zero square metres.
Surveyed by me, with due authority, in May 2001.
In accordance with Reg. 25 (1) of the Land Surveyors' Regulations 1998,
I certify that this plan is correct.

Checked by M.M. 11/11/02

Entered 63F 20.9.03 Trinidad and Tobago Land Surveyor..... 2001.

[Signature]
5th June 2001.