

1282

1288

R.P.O. Vol. 262
C.T. Vol. 4202

Fol. 463
Fol. 119

Ward of Siparia.
County of St. Patrick.
Cadastral Sheet G.14.M. 63F
4/d

Vol. 4457

Fol. 317

Process ID# 66148

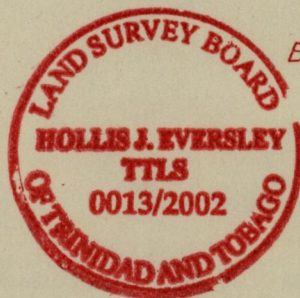
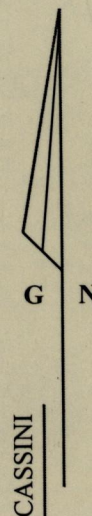
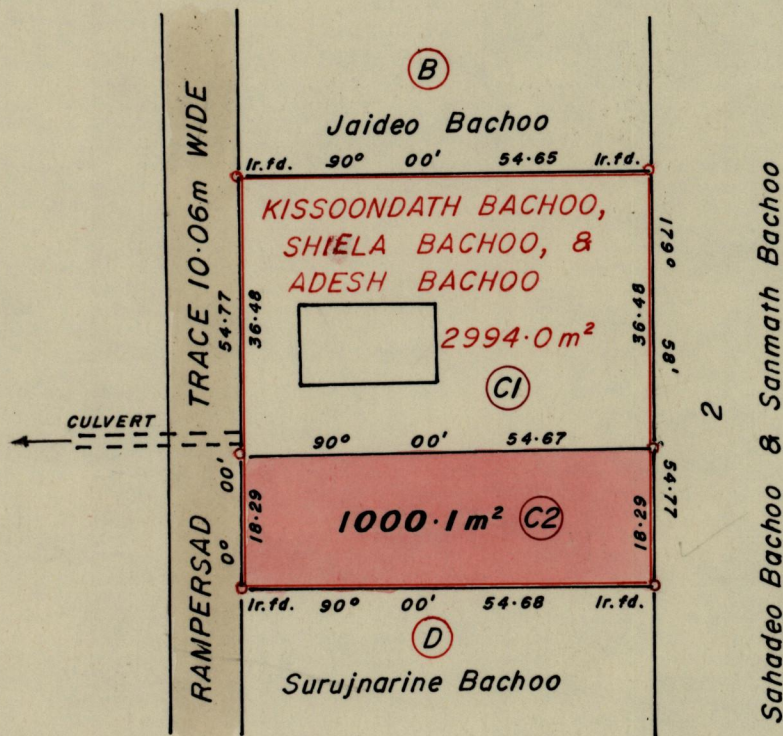

Bk. 1249 Vol. 2:68

See Bk. 1256:210

Approved

[Signature]
Director of Surveys 2003.3.7

Fyzool Hamid

Denotes Iron put unless otherwise stated

Bearings are Cassini Grid based on Solar Obs.
SCALE 1:1000.

Note: To Obtain compass bearings add/subtract

minutes

Distances are in METRES

PLAN of a Parcel of land coloured PINK in the Ward of Siparia.
Containing one thousand point one square metres.
Surveyed by me, with due authority, in February 2002.
In accordance with Reg. 25 (1), of the Land Surveyors' Regulations 1998,
I certify that this plan is correct.

Checked by *[Signature]* 24 Feb 2002

Entered *[Signature]* 9/03 Trinidad and Tobago Land Surveyor *[Signature]* 28 Feb 2002