

679

REMAINING PORTION

R.P.O. Vol. 152 Fol. 105

Cadastral Sheet G 19 E

C. of T. Vol. 1178 Vol. 379
Vol 4108 Fol. 285

1282

Ward of Siparia

126

County of St Patrick

Rem. Portion Plan Vol. 2555 Fol. 355^B

Vol 4108 Fol. 285

Process ID# 66146

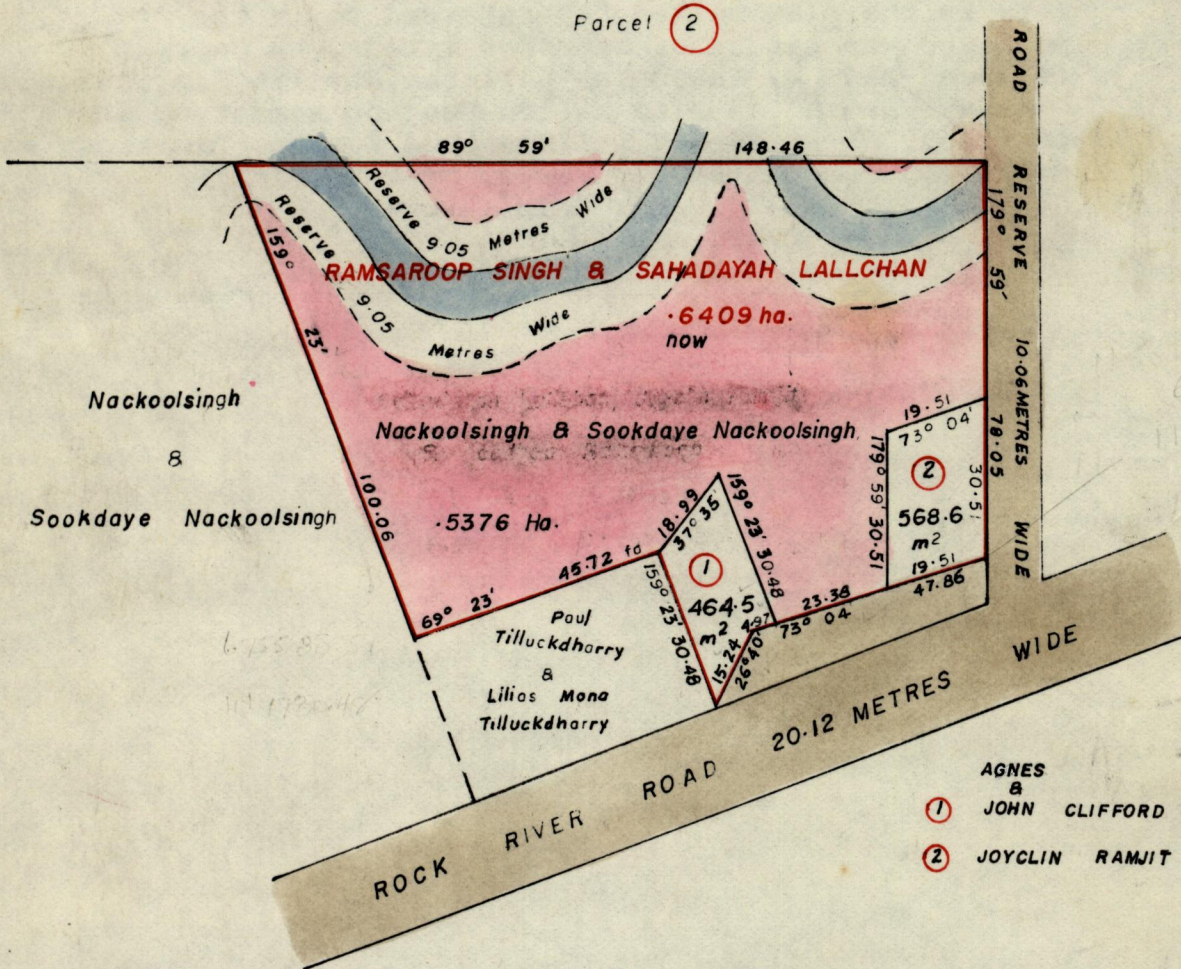

Nackoolsingh
&
Sookdaye Nackoolsingh

- AGNES &
- ① JOHN CLIFFORD Vol 2555 Fol 363
- ② JOYCLIN RAMJIT Vol 2567 Fol 487

Sahadayah Lallchan &
Boodhoo
Ramsaroop
Singh

Approved

K.B. Joshi

Director of Surveys

85.3.21

Note: To obtain compass bearings

add 1 minutes
subtract

SCALE 1/1500

Distances are in metres

This is a true copy of a diagram of point six four zero nine hectares originally transferred granted to RAMSAROOP SINGH and SAHADAYAH LALLCHAN, shewing a portion coloured pink and containing point five three seven six hectares being the remainder after two previous transfers of other portions of the land. the dividing lines having been run in conformity with Rule 76 under Sec. 14(2)(d) of the Land Surveyors Ordinance 1952 and duly certified by the Director of Surveys.

Checked by: *ABH* 85/03/21

Entered on: *744* 3/9/03

D. Jones
30-07-13

Sahadayah Lallchan

5/7/1984

99-09-03

Original in Bk 1117:29

Subd. Bk 1308:92 Vol. 4561 Fol. 439

"A"

This is the plan marked "A" referred to in the
prefixed Memorandum of Transfer dated 28th September,
1977 and made by Sahadayah Lallchan, Joyclin Ramjit, and
Boodhoo Ramsaroop also called Boodoo Ramsaroop Singh
in favour of Sahadayah Lallchan and Boodhoo Ramsaroop also
called Boodhoo Ramsaroop Singh.

Conveyancer.