

R.P.O. Vol. 438 fol. 349
 E.T. Vol. fol.

Vol. 4475 fol. 105
 Process # 66102

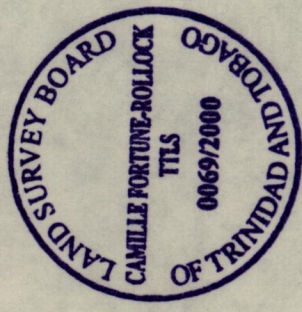

Cadastral Sheet 62D, F. 15. M.
 Ward of La Brea
 County of St. Patrick

Vide Bk. 491 / 17: Original
 S.O. 236 / 18
 Bk. 576 / 55
 Bk. 886 / 278

1282

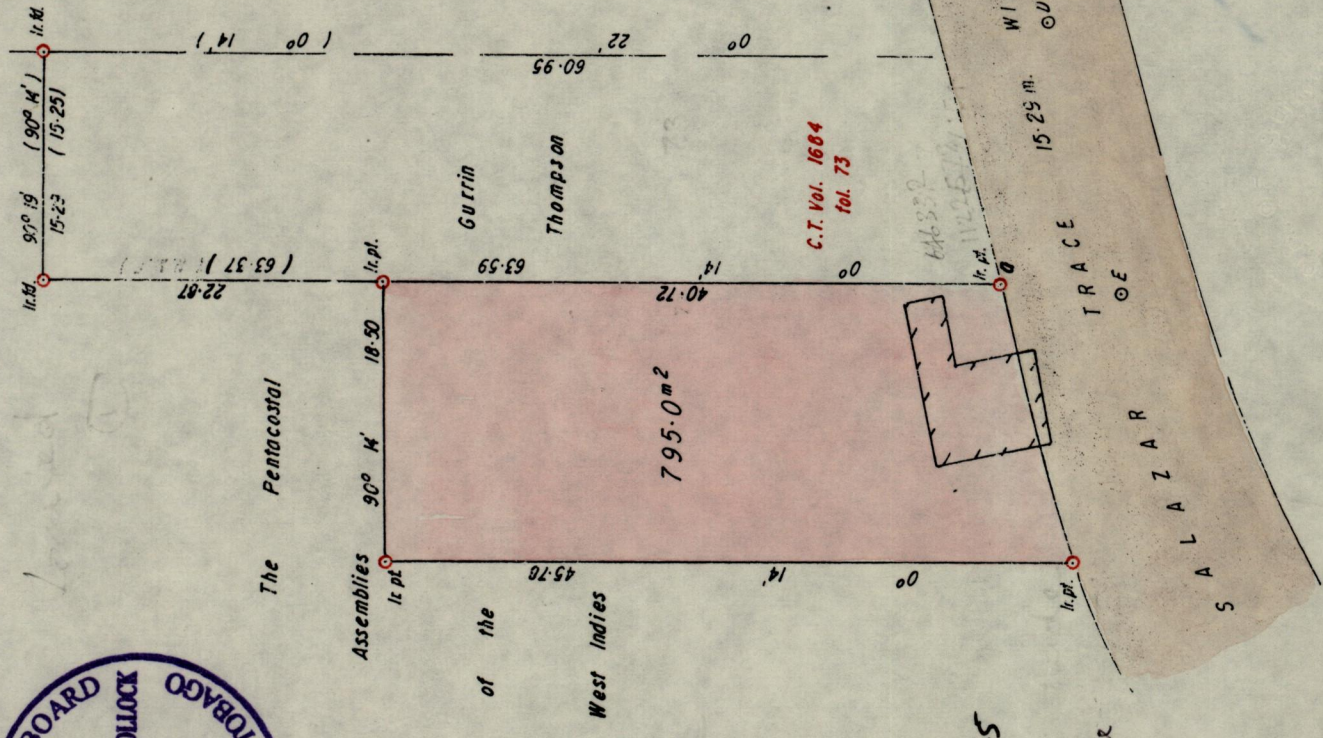

Approved *Dennis Bond*
 Director of Surveys 2000.10.5

Denecia & Doris Marecheau Glude

PLAN of a parcel of land coloured pink in the Ward of La Brea

Containing seven hundred and ninety five point zero square metres

Surveyed by me with due authority in August 1999

In accordance with Rule 25 (1) of the Land Surveyors Regulations 1998, I certify that

this plan is correct

Checked by *SH 00-09-26*

Ent. on *62D P. 8103*

Camille Fortune-Rollock
 Trinidad & Tobago Land Surveyor

Belmonte
 17th August 2000.

114

Bearings are based on Solar Obs.

INSET
 Scale 1 / 500
 Distances are in metres

Scale 1 / 2500

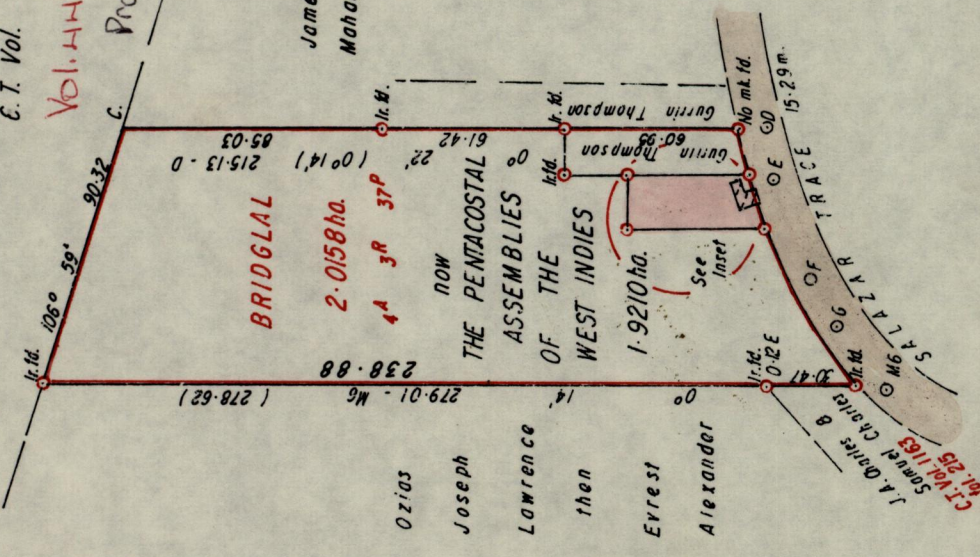

M6-G	52°09'	26.35
G-F	63°04'	17.44
F-E	71°50'	35.35
E-D	80°25'	18.19
E-o	10°35'	8.14

0	8.14	10°35'	15.25
E	35.35		
E	27.26		
F	12.82		
0	7.64	71°50'	