

6033

REMAINING PORTION

L. & S.—56

R.P.O. Vol. 81 Fol. 69  
R.P.O. Vol. 651 Fol. 563  
C. of T. Vol. 2006 Vol. 513  
Vol 4186 fol. 291

Cadastral Sheet G.12 .G. 63E  
Ward of Siparia 1/c/4  
County of St. Patrick

113

Process ID# 66093

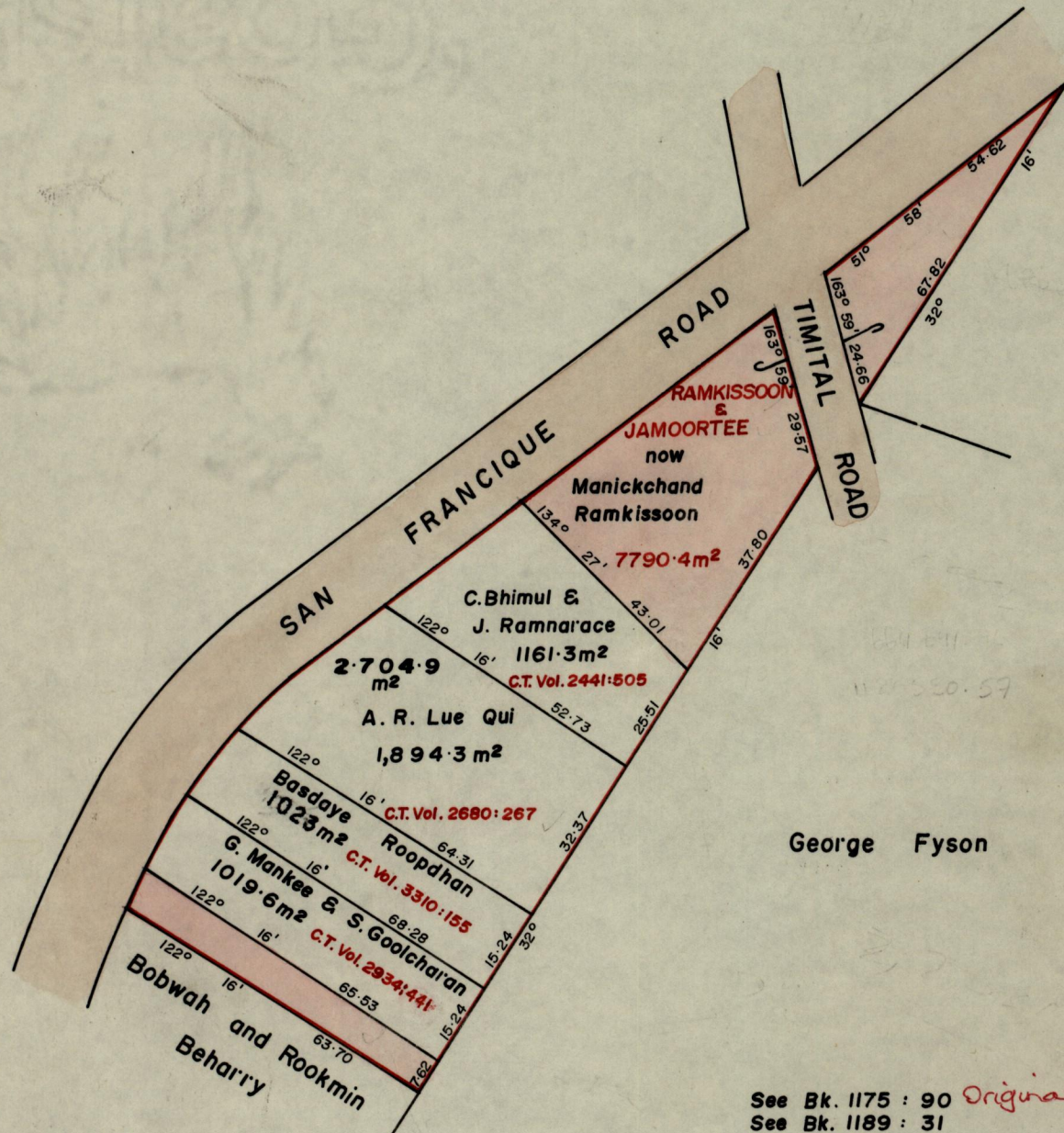

George Fyson

See Bk. 1175 : 90 Original  
See Bk. 1189 : 31  
1017 : 138

Manickchand Ramkissoon

SCALE 1 : 1250

Approved

*[Signature]*  
Director of Surveys  
28/8/5

Note: To obtain compass bearings add subtract minutes

Distances are in metres sq. metres

This is a true copy of a diagram of Seven thousand seven hundred & ninety point four sq. metres originally granted to Ram RAMKISSOON & JAMOORTEE, shewing a portion coloured pink and containing two thousand seven hundred & four point nine sq. metres being the remainder after four previous transfers of another portion of the land, 1952 14(2)(d) of the Land Surveyors Ordinance and duly certified by the Director of Surveys.

Checked by *[Signature]* 13.7.18  
Entered on 63E 8/03  
LMS 28-05-2013

*[Signature]*

Land Surveyor, Trinidad, 9/6/1978