

Vol. 4472 Bk. 724 fol. 81 fol. 247

Process ID# 66080

664065
141017

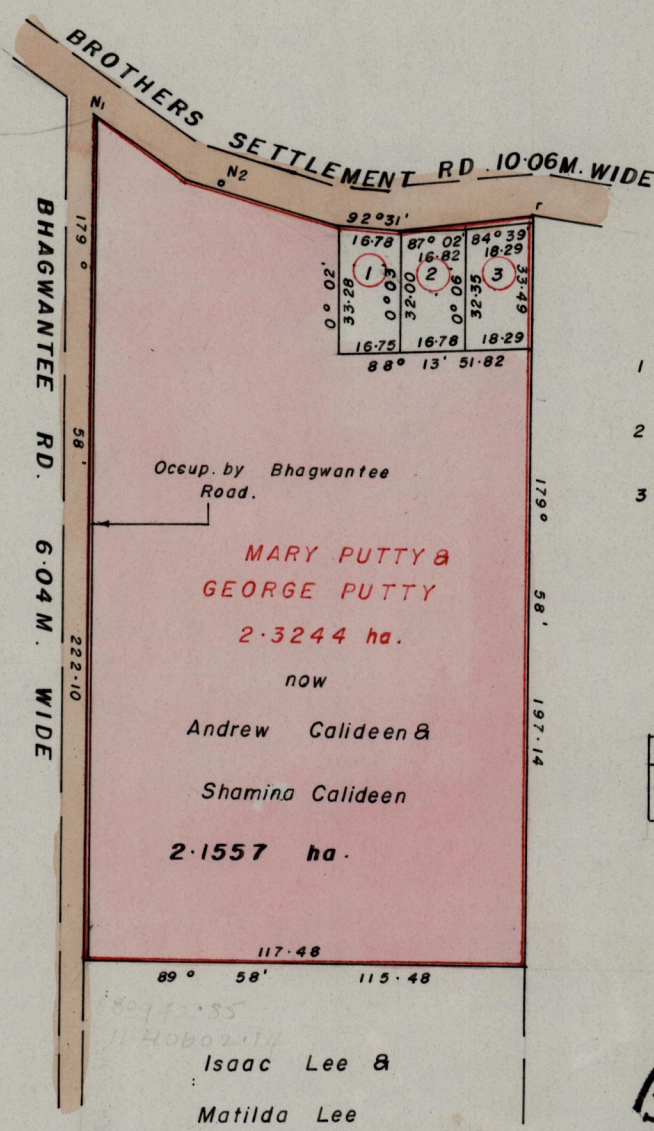

- 1 546.4 m.² Vol. 4205 fol. 169
- 2 540.1 m.² Vol. 4205 fol. 175
- 3 600.6 m.² Keith Lobin & Ors. C.T. Vol. 3638 fol. 253

Guadaloupe
Marcano

STA.	BEARINGS	DIST.
N ₁ - N ₂	119° 00'	36.88
N ₂ - r	94° 41'	85.52

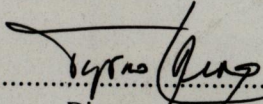

Approved 
 Director of Surveys
 10/12/04

Andrew & Shamina Calideen
Paul Binola Calideen
 Andrew Shamina & Paul Calideen

Note: To Obtain compass bearings add/subtract minutes

SCALE 1:2000
Distances are in METRES

This is a true copy of a diagram of *Two point three two four four hectares* originally transferred to *MARY PUTTY & GEORGE PUTTY*, showing a portion coloured pink and containing *Two point one five five seven hectares* being the remainder after *Three* previous transfer of another portion of the land. the dividing lines having been run in accordance with Reg. 25[1] of the Land Surveyors Regulations 1998. I certify that this plan is correct.

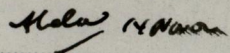
Checked by *Mela*  *Sugjage Reemaul*

Entered *548 @ 8/03* *Belmonte* Trinidad and Tobago Land Surveyor *13th August* 2000