

R.P.O. Vol. 43 Fol. 341

C.T. Vol. 4132 Fol. 409

U.P.R.N. No.:

Consolidated Plan in Vol. 4132 Fol. 407

REMAINING PORTION

Ward of Siparia

County of St. Patrick

Cadastral Sheet G.11.C & D 63D 62F  
1/a 2/b

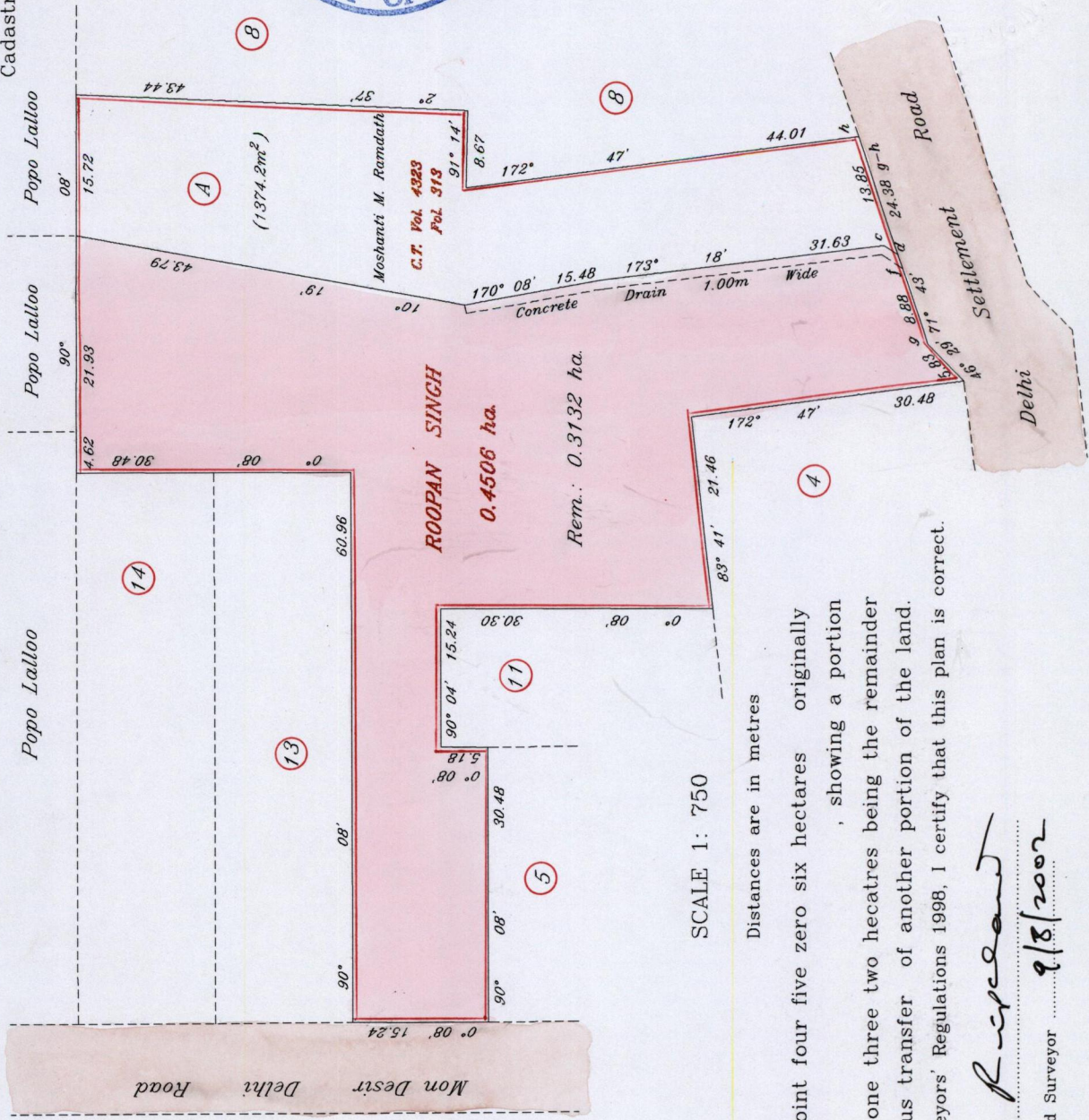

1279

52

G.N Cassini

References: Plan R.C. 79A  
Plan C.A. 65

ROOPAN SINGH  
0.4506 ha.  
Rem.: 0.3132 ha.

SCALE 1: 750

Distances are in metres

Approved  
  
 Director of Surveys  
 2013.06.11

This is a true copy of a diagram of zero point four five zero six hectares originally transferred to ROOPAN SINGH, showing a portion coloured pink and containing zero point three one three two hectares being the remainder after one (1) previous transfer of another portion of the land. In accordance with Regulation 25(1) of the Land Surveyors' Regulations 1998, I certify that this plan is correct.

Checked by   
 Entered .....  
 Trinidad & Tobago Land Surveyor ..... 9/8/2002