

1279

1279/265

265

REMAINING PORTION

R.P.O. Vol. 96 fol. 29  
C.T. Vol. 1247 fol. 19

Ward of Siparia  
County of St. Patrick  
Cadastral Sheet (G. 13. E.)  $\frac{63 E}{2/d}$

Bk. 903 fol. 141  
Bk. 1012 fol. 49  
Bk. 1005 fol. 145

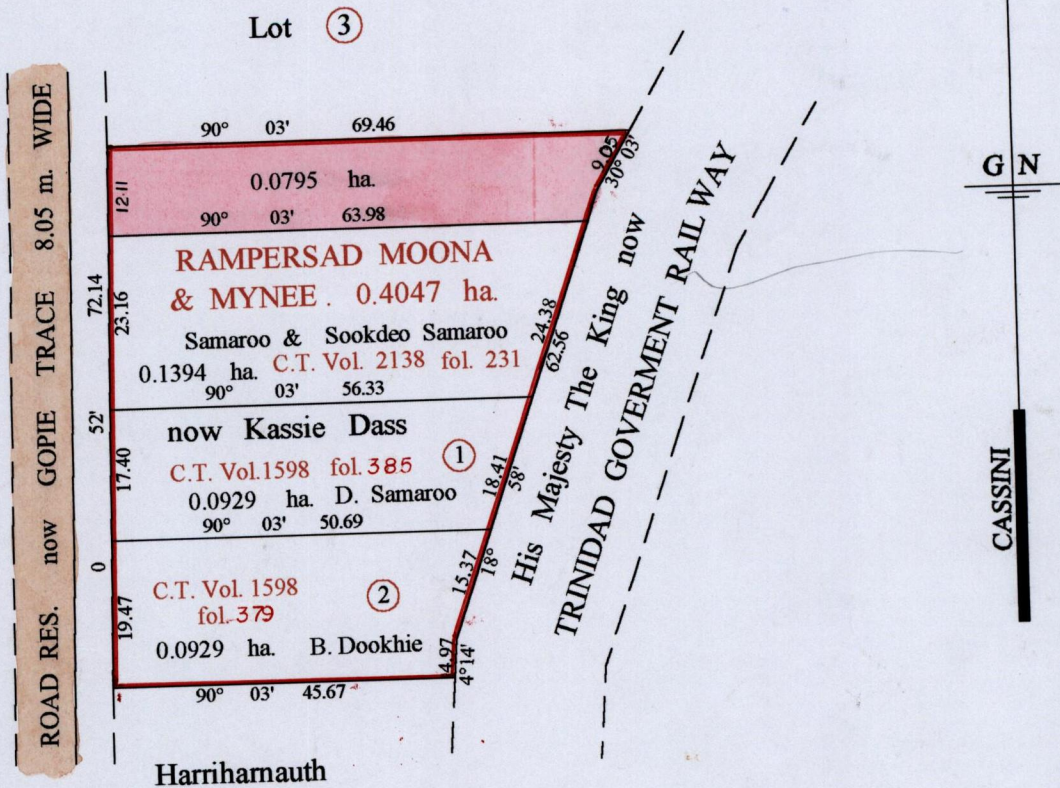

Approved *[Signature]*  
Director of Surveys  
2003.12.29

SCALE : 1 : 1000

Note: Bearings are cassini grid based on solar observations Distances are in metres  
This is a true copy of a diagram of point four zero four seven hectares originally granted to Rampersad Moona and Mynee, shewing a portion coloured pink and containing point zero seven nine five hectares being the remainder after three previous transfers of another portion of land. the dividing lines having been run in accordance with Regulation 25 (1) of the Land Surveyors' Regulations 1998. I certify that this plan is correct.

Checked by *[Signature]* 2003.12.29

Entered on ..... Trinidad & Tobago Land Surveyor *[Signature]* ..... 2003