

R.P.O. Vol.
 C.T. Vol. 2326
 U.P.R.N No.
 C.T. Vol. 133

Fol.
 Fol. 21
 Fol. 83

1279

Ward of La Brea
 County of St. Patrick
 Cadastral Sheet G.6.N.

25

62.C.
 3/d

Bk. 997 Fol. 161

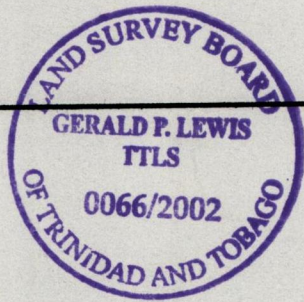
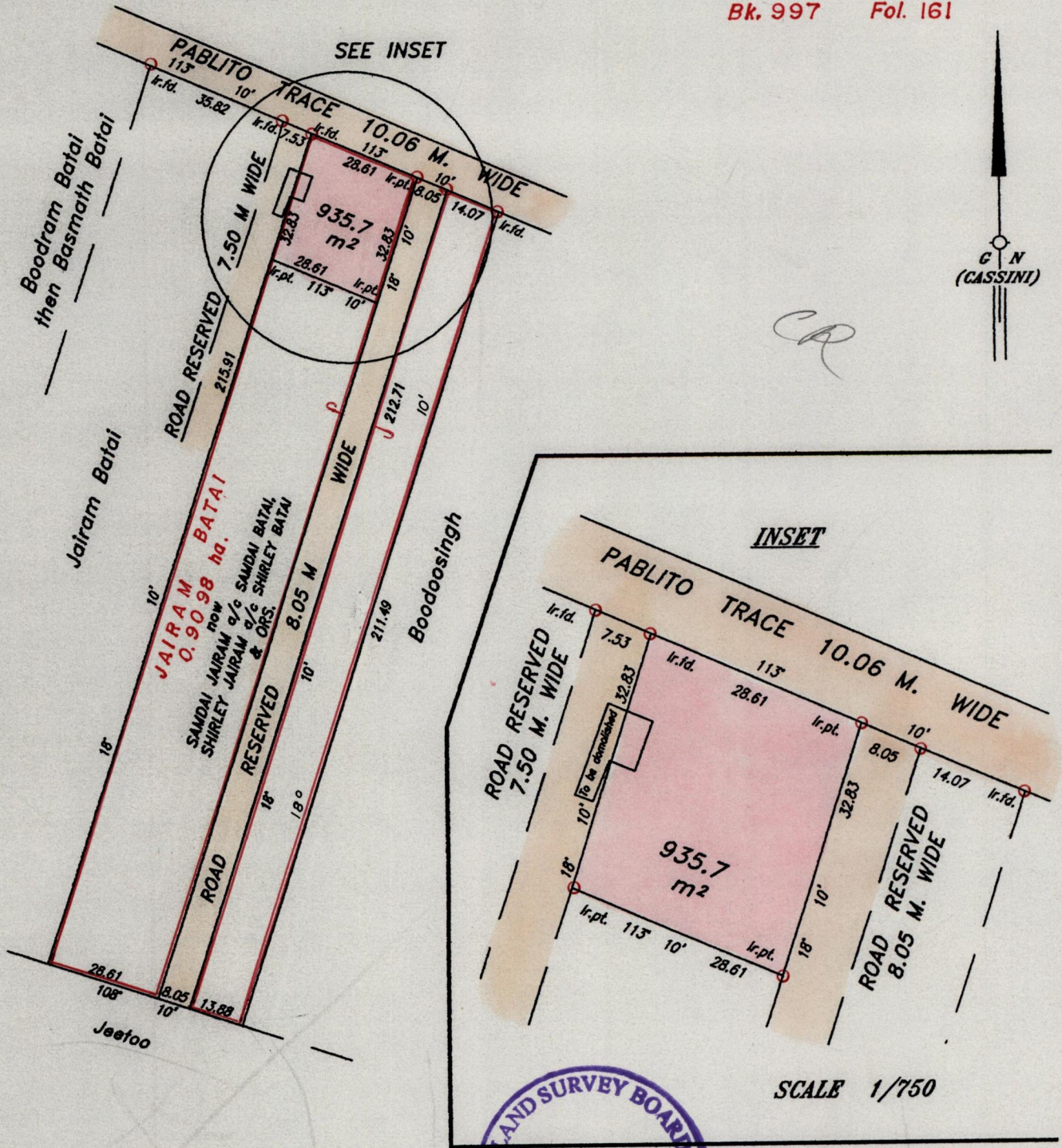

Approved *[Signature]*
 Director of Surveys 2003.4.30

SCALE 1/1500

Bearings are Cassini Grid based on Solar Observations Distances are in metres
 Plan of a Parcel of land coloured pink in the Ward of La Brea
 Containing nine hundred and thirty five point seven square metres
 Surveyed by me, with due authority, in March 2000
 In accordance with Regulation 25 (1) of the Land Surveyors Regulations 1998,
 I certify that this plan is correct.

Checked by.....
 Entered by

[Signature]
 Trinidad & Tobago, Land Surveyor..... 15/05/2002