

1279

REMAINING PORTION

246

R.P.O. Vol. 125 Fol. 667
C.T. Vol. 1838 Fol. 07

Ward of Siparia
County of St. Patrick
Cadastral Sheet G.17.B., 73A
2/a

- Lot 1 - 205.7 m²
- Lot 2 - 446.5 m² - C.T. Vol. 3527 Fol. 69
- Lot 3 - 634.7 m² - C.T. Vol. 3422 Fol. 301

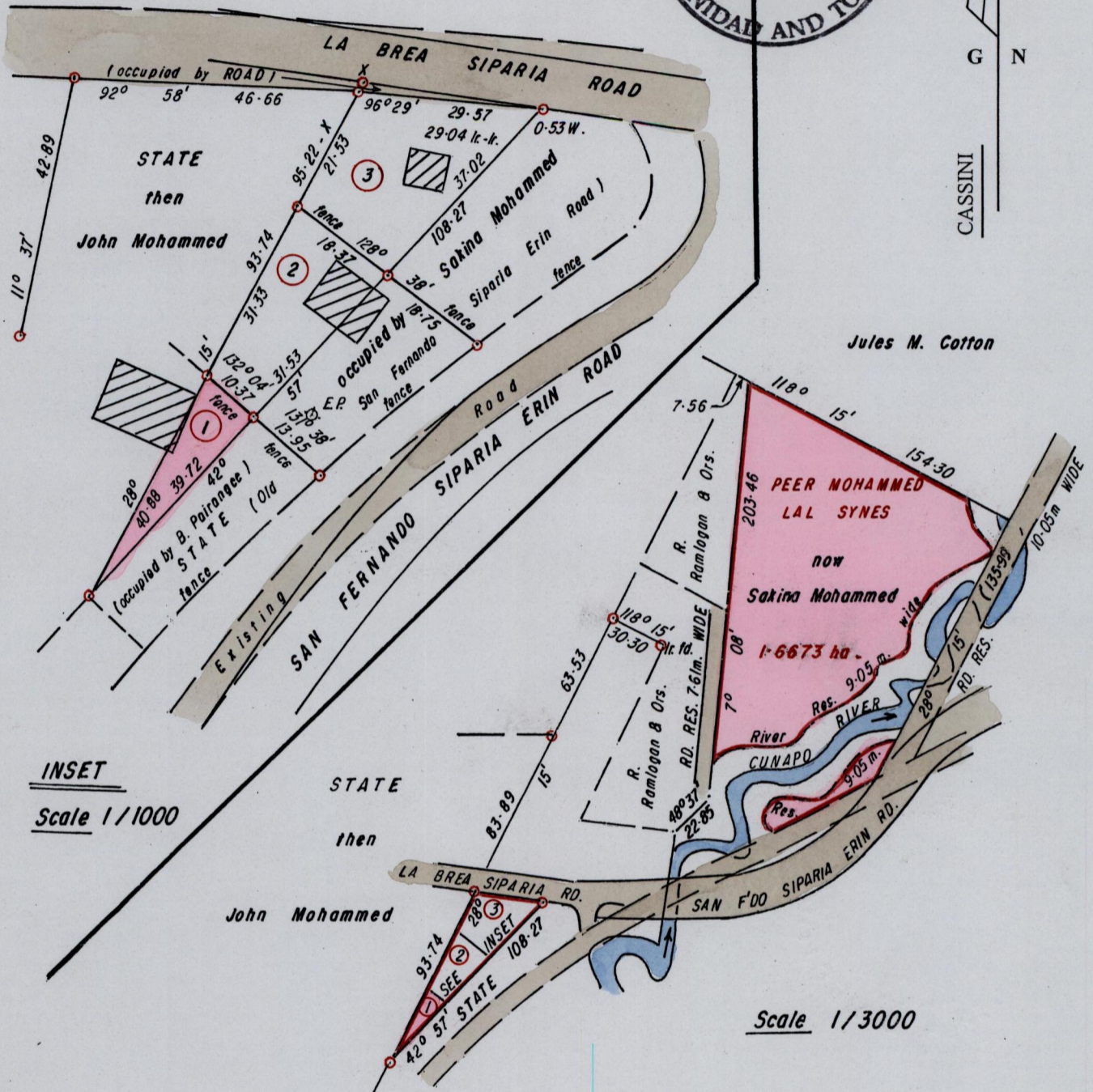
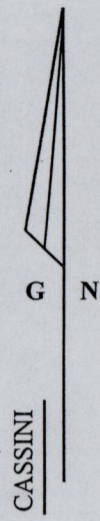

Approved *[Signature]*
Director of Surveys
2003.12.19

Note: To Obtain compass bearings add/subtract minutes

(INSET)
SCALE 1/3000 & 1/1000
Distances are in METRES

This is a true copy of a diagram of one point six six seven three hectares originally transferred to Sakina Mohammed, showing a portion coloured pink and containing one point five five nine two hectares being the remainder after two previous transfers of another portion of the land. The dividing lines having been run in accordance with Regulation 25[1] of the Land Surveyors' Regulations 1998. I certify that this plan correct.

Checked by *[Signature]* *[Signature]*
Entered Trinidad and Tobago Land Surveyor..... *[Signature]* 2002