

Ward of Siparia
 County of St. Patrick
 Cadastral Sheet G.19.E 74A
 1/c

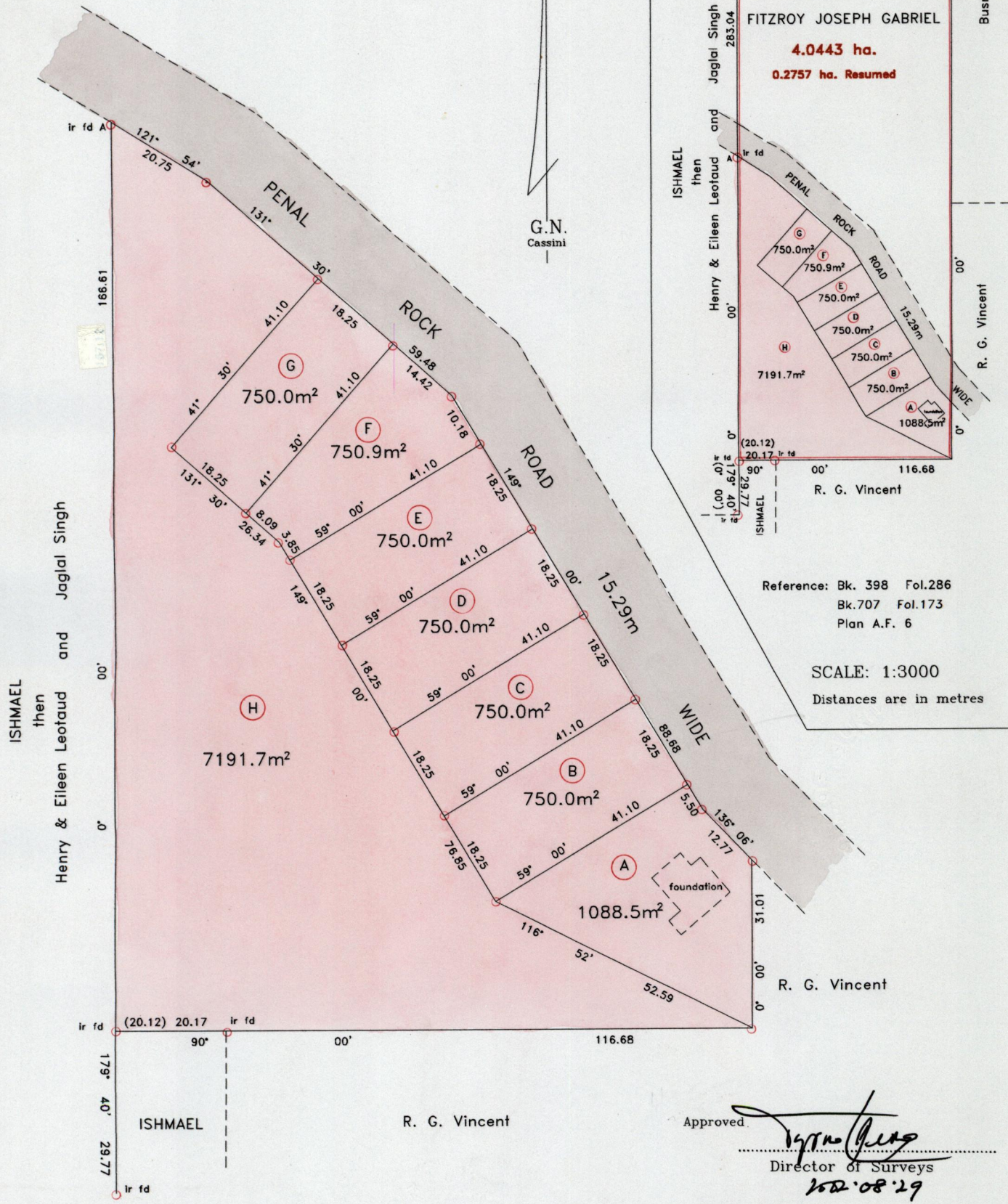

Reference: Bk. 398 Fol.286
 Bk.707 Fol.173
 Plan A.F. 6

SCALE: 1:3000
 Distances are in metres

Approved: *[Signature]*
 Director of Surveys
 2002.08.29

SCALE: 1:1000
 Distances are in metres
 ○ Denotes iron put unless otherwise stated

Bearings are Cassini Grid based on solar observations

PLAN of 8 parcels of land coloured pink in the Ward of Siparia
 Containing together twelve thousand seven hundred and eighty one point one square metres
 Surveyed by me, with due authority, on the October 1996
 In accordance with Reg. 25(1) of the Land Surveyors' Regulations 1998, I certify that this plan is correct.

Checked by *[Signature]* 21/02-07-17

[Signature] T.T.L.S.
 7/8/2000
 Trinidad & Tobago Land Surveyor



Entered on

783

1271

25 AUG 2000
Lands and
Surveys
Division