

R.P.O. Vol. 497 Fol. 209

C.T. Vol. Fol.

Borough ~~Ward~~ of Arima

County of St. George

Cadastral Sheet B.19.P. 24C
1/a & b

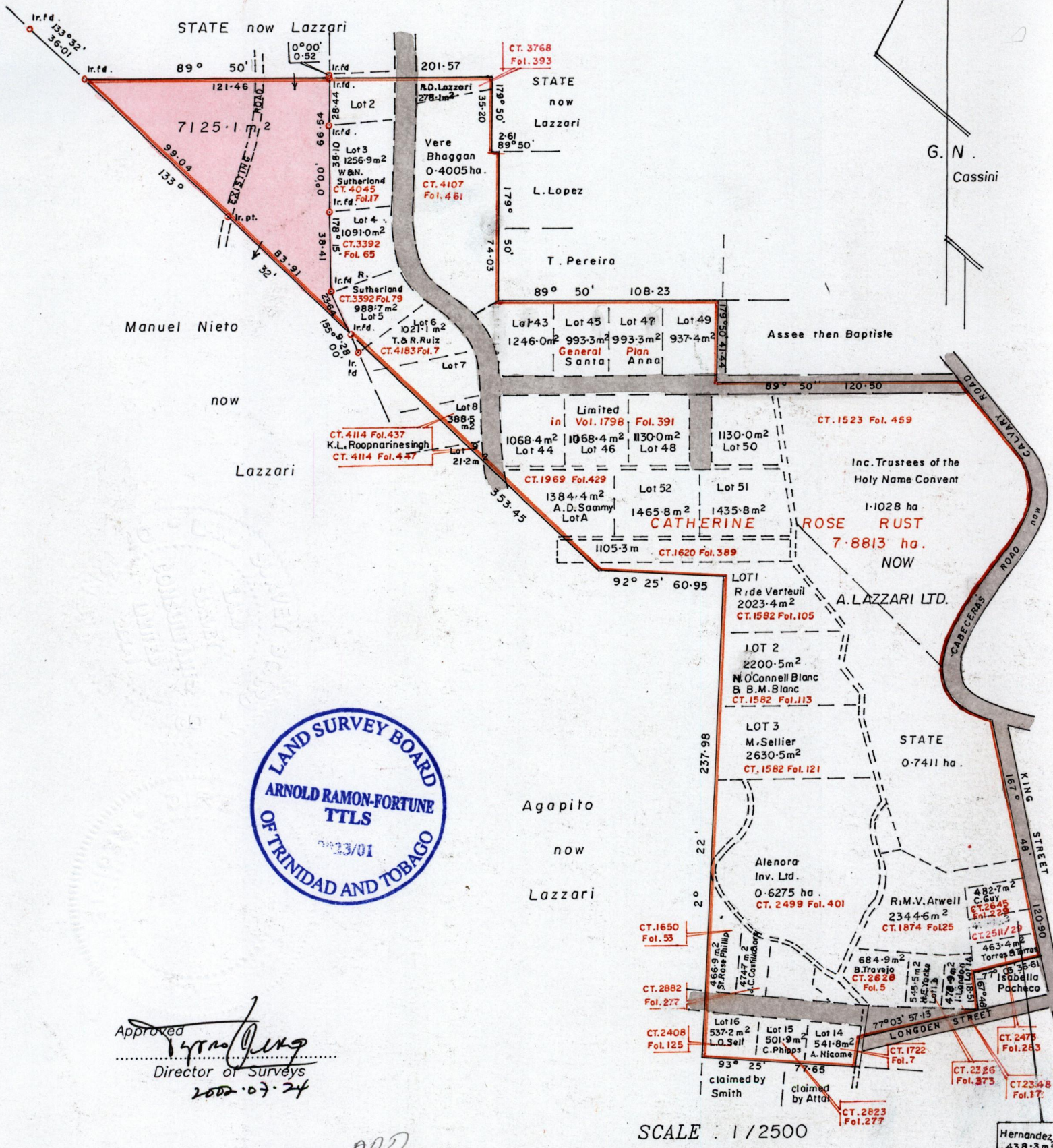

Approved
[Signature]
Director of Surveys
2002.07.24

SCALE : 1/2500

Note: To obtain compass bearings subtract 10 minutes.

Distances are in metres

Borough ~~Ward~~ of Arima

PLAN of a Parcel of land coloured pink in the ~~Ward~~ of Arima

Containing seven thousand one hundred and twenty five point one square metres

Surveyed by me with due authority in November 2001

In accordance with Regulation 25(1) of the Land Surveyors' Regulations 1998,

I certify that this plan is correct.

Checked by *[Signature]*
Entered.....

[Signature] TTLS. ARICS.
Trinidad & Tobago Land Surveyor. 29th Nov. 2001

54

1751

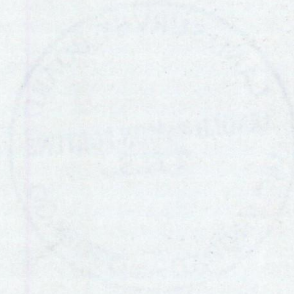

- 6 DEC 2001
Lands and
Surveys
Division

1271/42