

1271

30

R.P.O Vol 212 Fol. 465  
C.T. Vol. 1223 Fol. 309

Ward of Siparia  
County of St. Patrick  
Cadastral Sheet

U.P.R.N. No

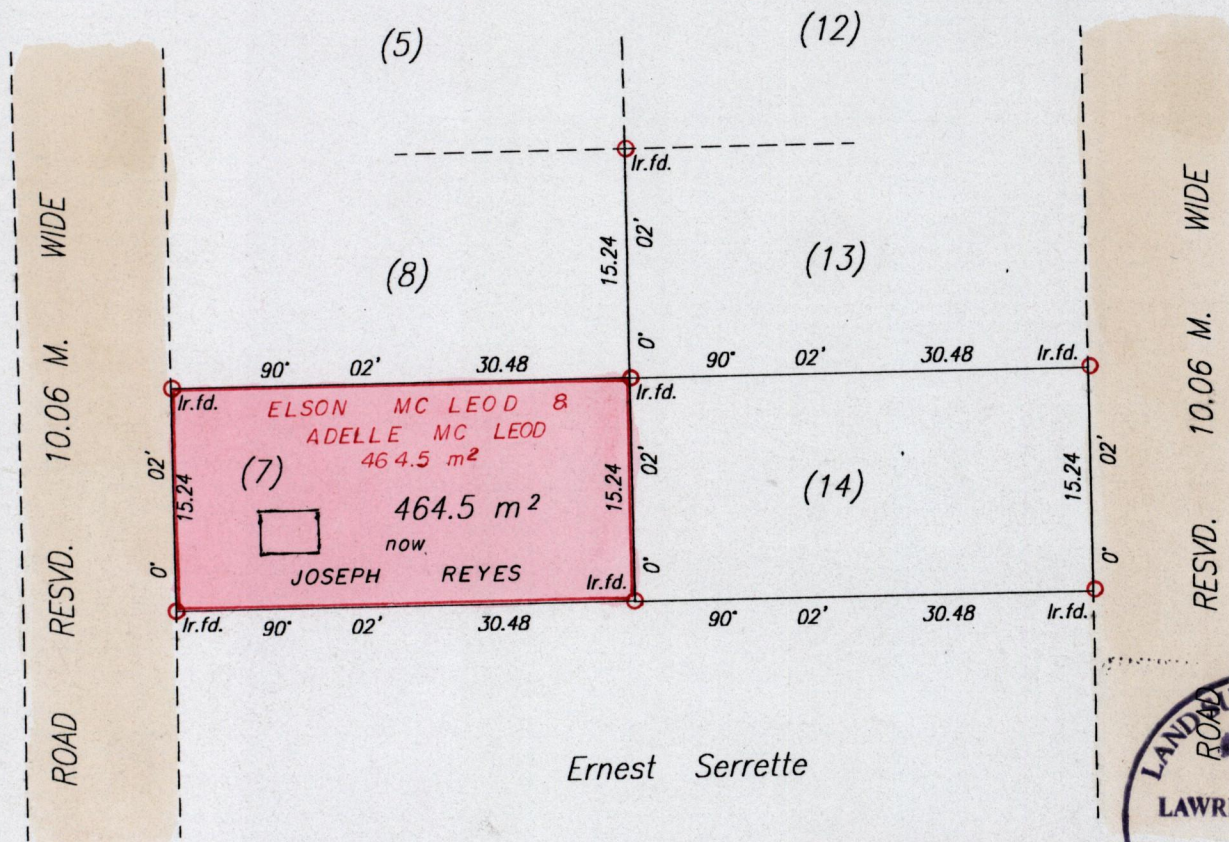
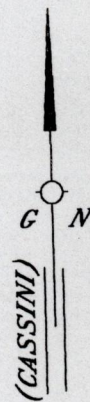

SEE BK 798 FOL 260

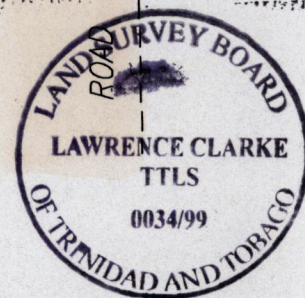

Approved .....  
Director of Surveys  
2002.07.24

SCALE 1/500

Note : To obtain compass bearing subtract 2 minutes.

Distances are in metres

Plan of a Parcel of land coloured pink in the Ward of Siparia  
Containing four hundred and sixty four point five square metres  
Surveyed by me with due authority, in September 1999  
In accordance with Regulation 25 (1) of the Land Surveyors Regulations 1998,  
I certify that this plan is correct.

Checked by ..... 02.05.22

Lawrence Clarke

Entered .....

Trinidad & Tobago, Land Surveyor ..... 6<sup>th</sup> September 1999

30

1271

Faint, illegible text at the top of the page.

