

R.P.O. Vol. 422 fol. 159  
C.T. Vol. 806 fol. 569  
Bk. 429 fol. 158  
Bk. 1005 fol. 11  
Gas Line A.N. 181 / 23

Ward of Siparia  
County of St. Patrick  
Cadastral Sheet (G.14.F) 64D  
1/d

ROCHARD DOUGLAS ROAD 15.29 M. WIDE

Dubbery

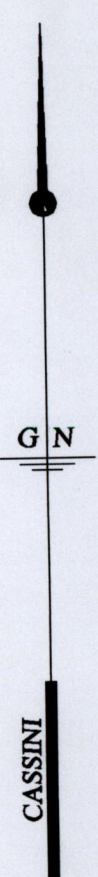
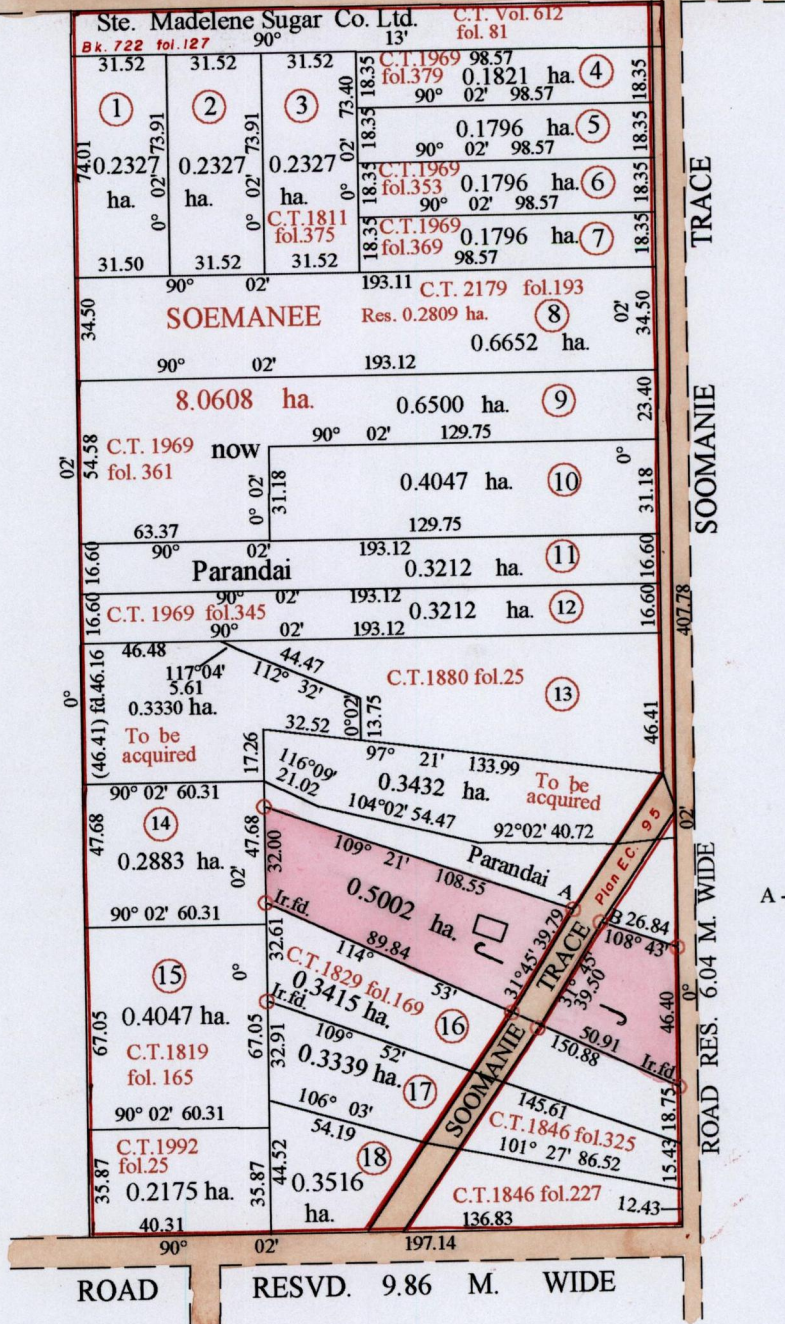

A - B 116° 31' 10.10

Approved *[Signature]*  
Director of Surveys 2003.3.20

○ Denotes Iron Put Except  
Otherwise Stated

SCALE : 1: 2500

Note: Bearings are cassini grid based on solar observations Distances are in metres  
PLAN of a Parcel of land coloured pink in the Ward of Siparia  
Containing point five zero zero two hectares  
Surveyed by me, with due authority, in August 2000  
In accordance with Regulation 25 (1) of the Land Surveyor's Regulations 1998,  
I certify that this plan is correct.

Checked by *[Signature]* Sugjage Reemaul

Entered on ..... Trinidad & Tobago Land Surveyor 30<sup>th</sup> December, 2001