

B N^o 4418

R.P.O. Vol. 25
C.T. Vol. 3891

Fol. 249
Fol. 77

Ward of Turure
County of St. George
Cadastral Sheet E.2.E, 37/b
Ref. Bk. 156 fol. 124

INSET

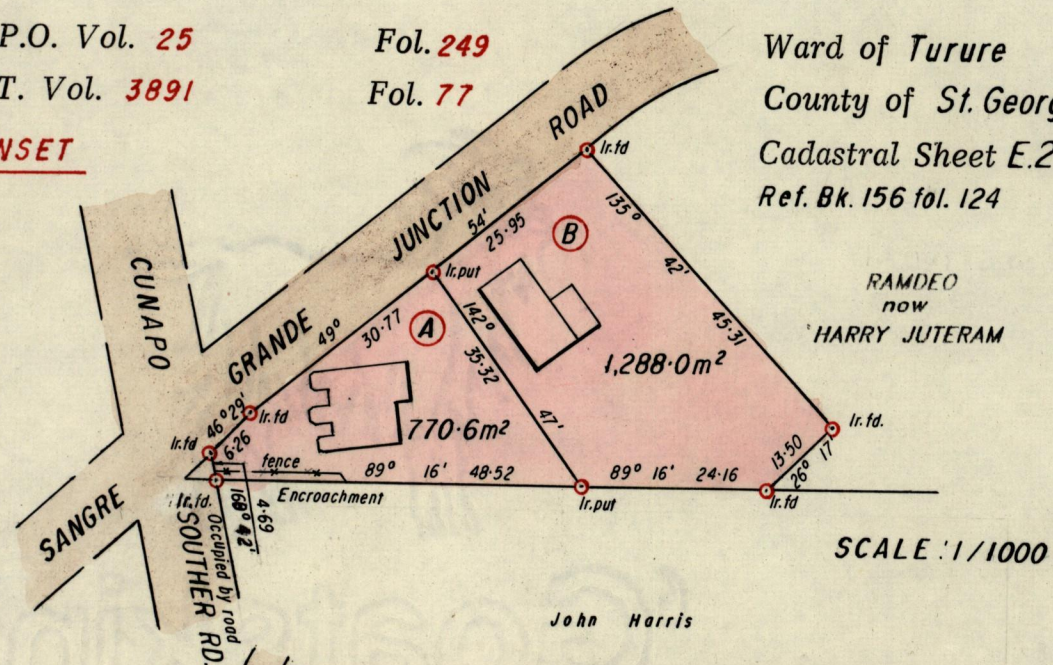

SCALE : 1/1000

John Harris

RAMDEO 3.9406 Ha.

HARRY JUTERAM

Victorine Modeste

State then Gullion Mohradge

Cassini
Grid North

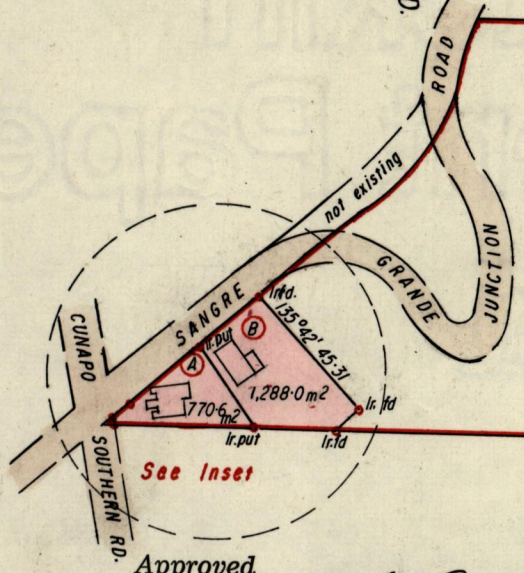

See Inset

Approved

[Signature]
Director of Surveys 2003.2.18

SCALE 1/2500

Note: To obtain compass bearings add/~~subtract~~ 17 minutes Distances are in metres

PLAN of 2 Parcelsof land coloured pink in the Ward of Turure
Containing two thousand and fifty eight point six square metres
Surveyed by me, with due authority, in December 1998

In accordance with Reg. 25(1) of the Land Surveyors Regulations 1998
I certify that this plan is correct.

Checked by *[Signature]*

Entered Trinidad & Tobago 9th July 19.2001
Land Surveyor



