

1271

223

R.P.O. Vol. 86 Fol 455
C.T. Vol. 4090 Fol. 375
U.P.R.N. No.

Cadastral Sheet G. 13 I. ^{63E}/_{4/b}
Ward of Siparia
County of St. Patrick

Penal

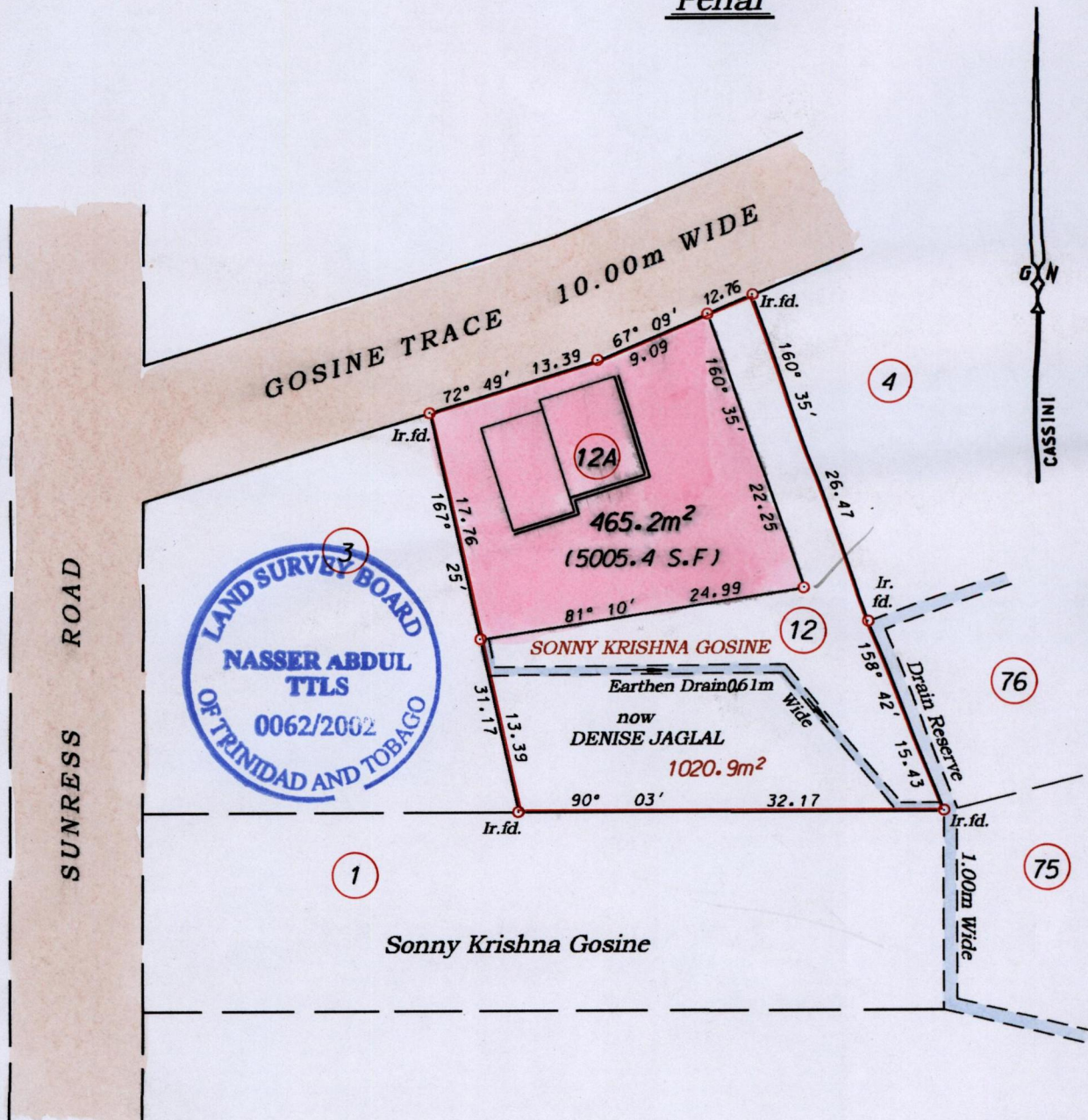

Sk. 1219:176

Approved by

[Signature]

 Director of Surveys
 2003 01-20

○ Denotes Iron put unless otherwise stated
Bearings are Cassini Grid based on Solar Obs.

SCALE:- 1/500
Distances are in metres

Note: To obtain compass bearings add/subtract minutes

PLAN of a Parcel of land coloured pink in the Ward of Siparia
Containing four hundred and sixty five point two square metres
Surveyed by me, with due authority in August 2001.

In accordance with Regulation 25 (1) of the Land Surveyors' Regulations 1998.
I certify that this plan is correct.

Checked by M.M. 30/12/02

[Signature]

 26th Feb
 Trinidad & Tobago Land Surveyor.....20.02

Entered on.....

County of ...
City of ...
Assessor's Office

...

...

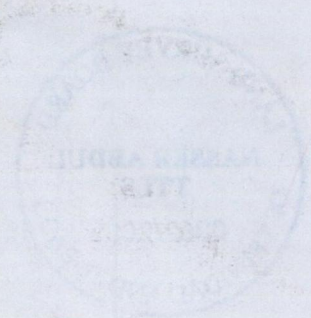
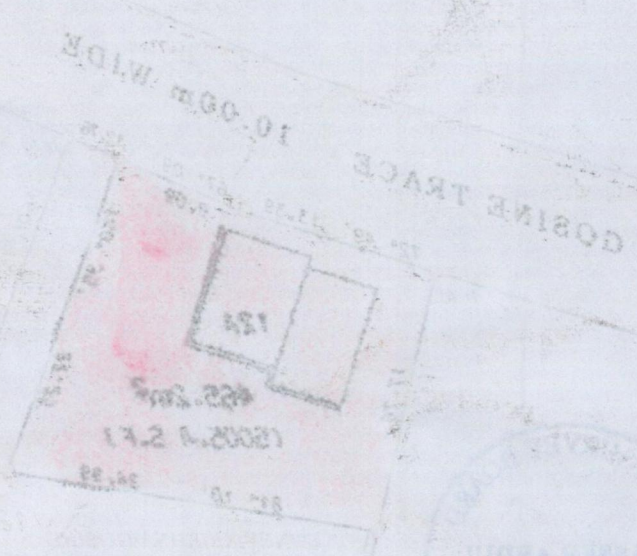

DIVISION OF LANDS AND SURVEYS

Approved by: _____
Director of Surveys

...

26 FEB 2002
Lands and Surveys Division