

1271

REMAINING PORTION

101

R.P.O. Vol. 96

Fol. 137

Ward of Siparia

C.T. Vol. 2835

Fol. 413

County of St. Patrick

Cadastral Sheet ( G.13.I ) 63.E.

4/b

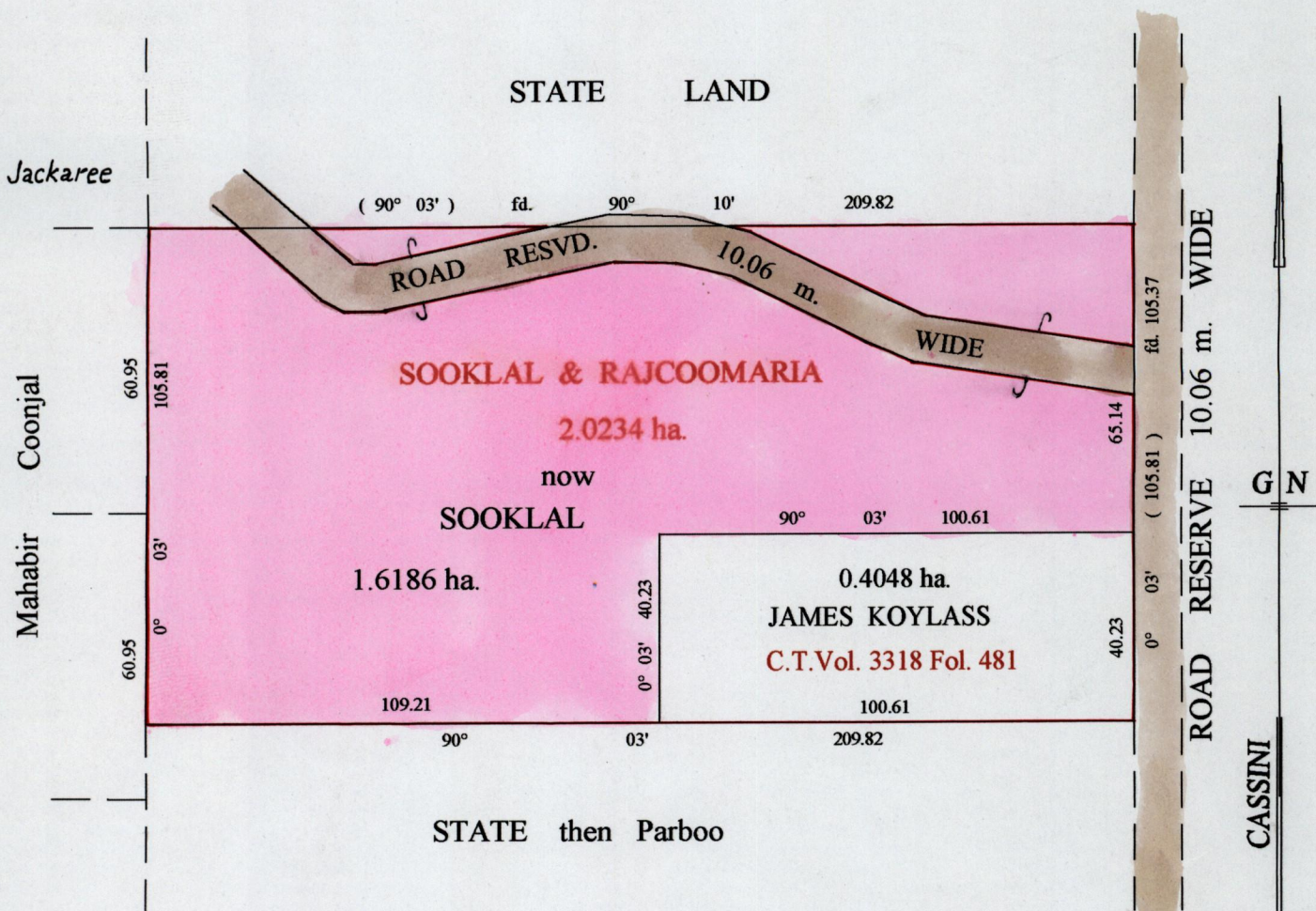

Vide Bk. 1179 fol. 179

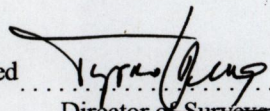
Approved   
 Director of Surveys  
 25/12/04

SCALE : 1:1500

Note: Bearings are cassini grid based on solar observations

Distances are in metres

This is a true copy of a diagram of two point zero two three four hectares, originally transferred to SOOKLAL & RAJCOOMARIA, shewing a portion coloured pink and containing one point six one eight six hectares being the remainder after one (1) previous transfer of another portion of the land. In accordance with <sup>Regulation</sup> 25 (1) of the Land Surveyors' Regulations 1998, I certify that this plan is correct.

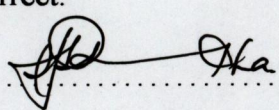
Checked by *m.m.* 7/11/02 

Entered on ..... Trinidad & Tobago Land Surveyor ..... 10. 12. 2001





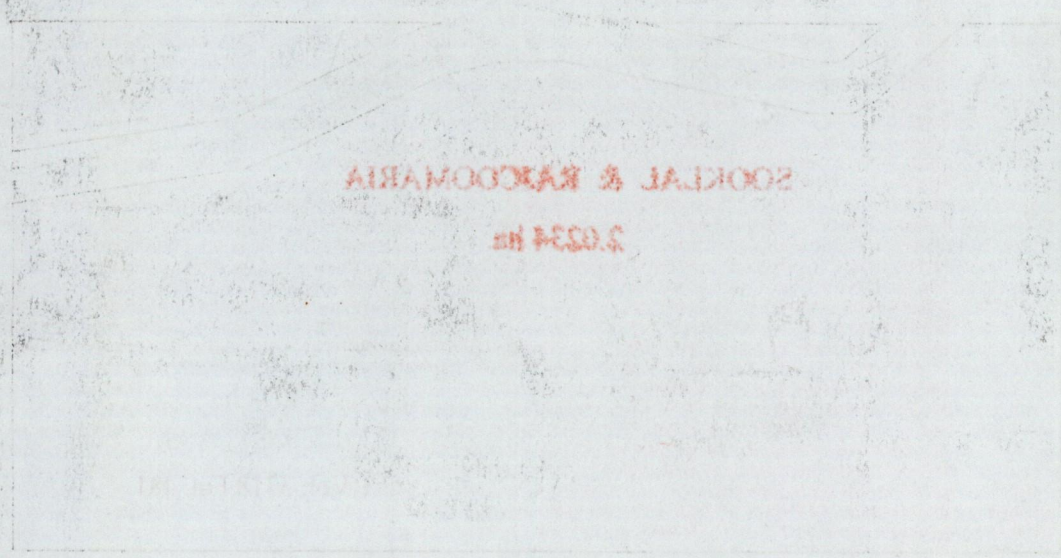

SOICIAI & RANCOMARIA

3.0334 m

6 FEB 2002  
 Lands and  
 Surveys  
 D