

R.P.O. Vol. 628
C.T. Vol.

Fol. 177
Fol.

Bk. 601 fol. 335
Plan E.C.95

Ward of Siparia
County of St. Patrick
Cadastral Sheet G.14. F. 17/d

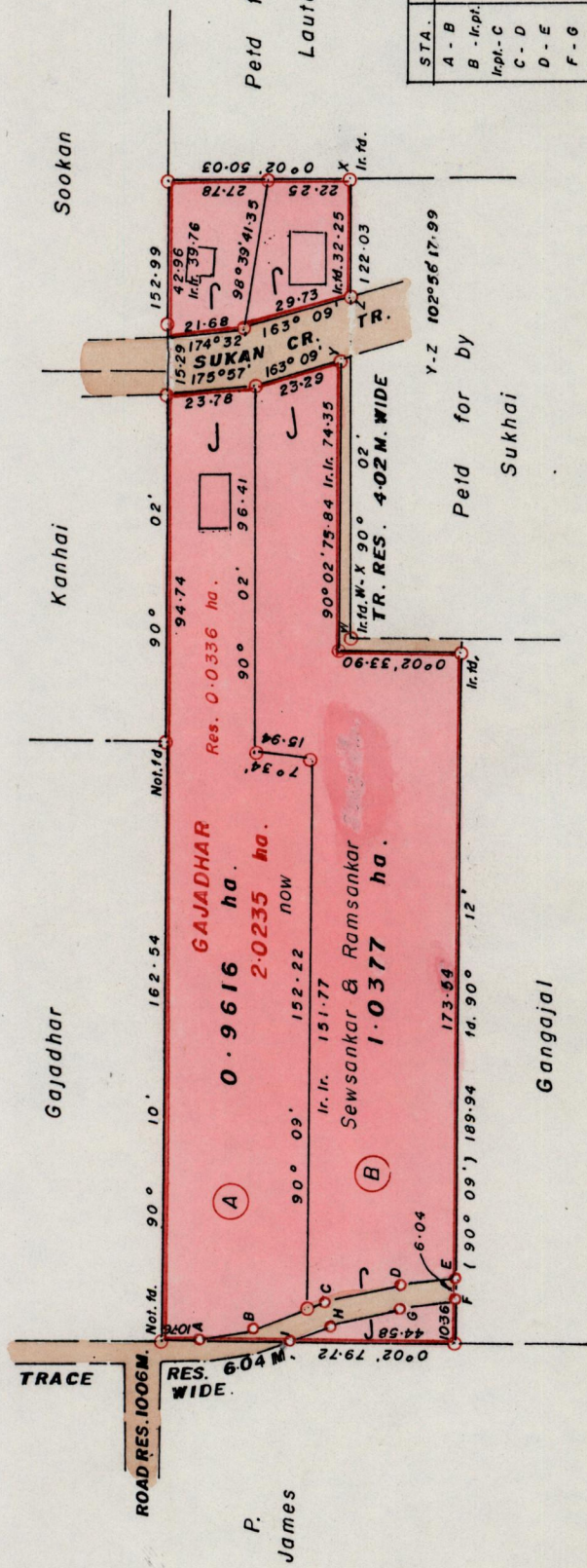
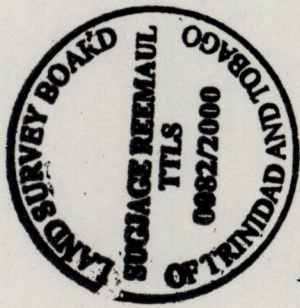

STA.	BEARING	DIST.
A - B	170° 13'	14.96
B - Ir. pt.	158° 00'	15.20
Ir. pt. - C	158° 00'	5.46
C - D	168° 15'	19.54
D - E	172° 36'	16.14
F - G	352° 34'	14.58
G - H	348° 13'	19.54
H - I	338° 01'	11.91
I - A	0° 02'	24.38

SCALE 1:2000

○ Denotes Iron put unless otherwise stated

Bearings are Cassini Grid based on Solar Obs.

Distances are in METRES

Approved
Sighe Cheng
Director of Surveys of
Trinidad and Tobago
2007.7.16

Note: To Obtain compass bearings add/subtract 2 minutes

PLAN of 2 Parcel of land coloured PINK in the Ward of Siparia
Containing together one point nine nine three hectares.
Surveyed by me, with due authority, in June 2000

In accordance with Rule 25 (1), of the Land Surveyors Regulations 1998. I certify that this plan is correct.

Checked by *Sugjage Reemaul*
3rd July 2007
Entered Trinidad and Tobago Land Surveyor 2007

CASSINI
N 1267
G

72

150

