

R.P.O. Vol. 91 Fol. 351  
 C.T. Vol. 4010 Fol. 521

Ward of Siparia  
 County of St. Patrick  
 Cadastral Sheet (G.13.A.&E) 63.E.  
 2/b

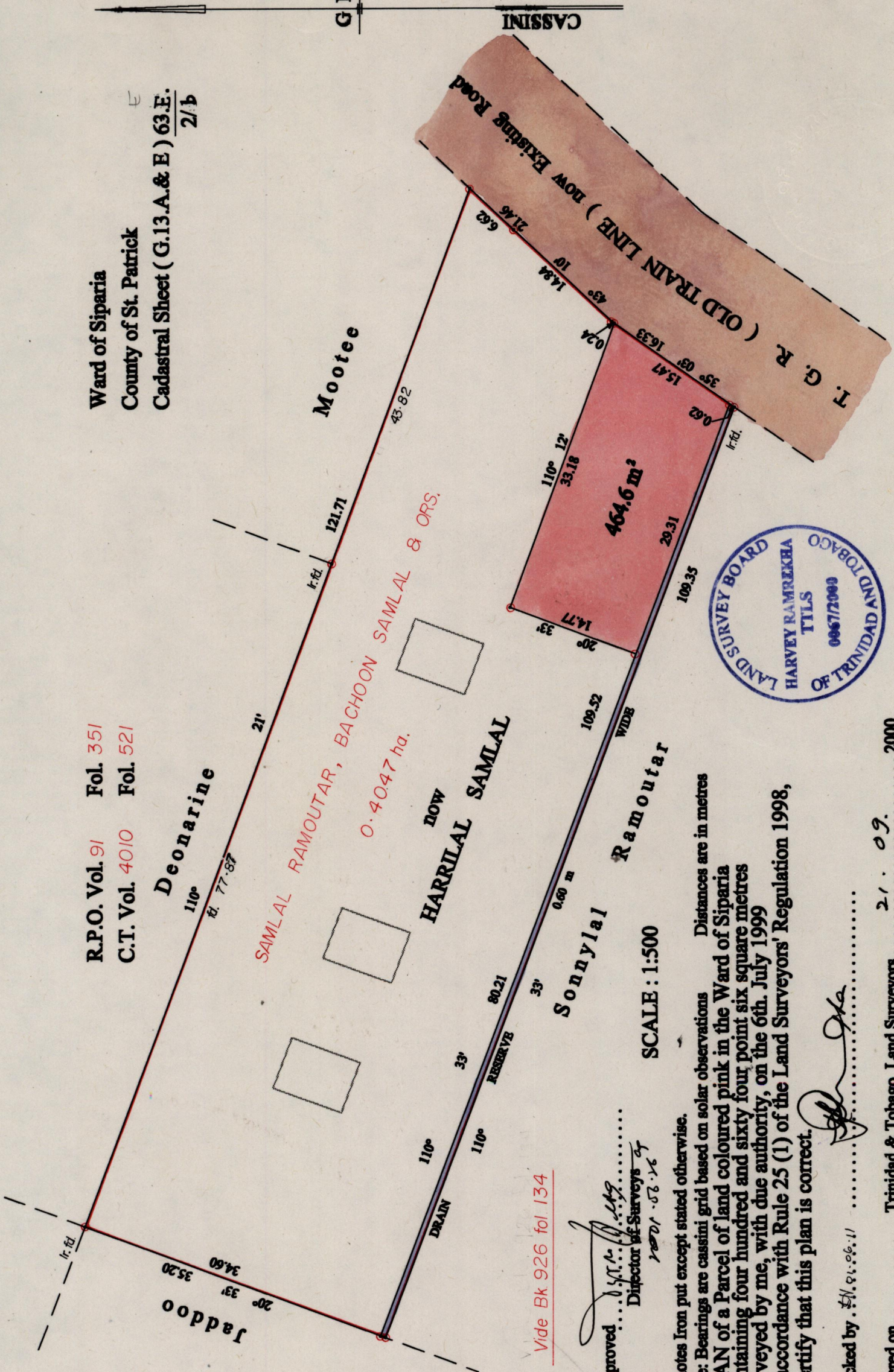

1267

45



Vide Bk 926 fol 134

Approved: *[Signature]*  
 Director of Surveys  
 1001 02.16

SCALE: 1:500

○ Denotes Iron put except stated otherwise.  
 Note: Bearings are cassini grid based on solar observations  
 PLAN of a Parcel of land coloured pink in the Ward of Siparia  
 Containing four hundred and sixty four point six square metres  
 Surveyed by me, with due authority, on the 6th. July 1999  
 In accordance with Rule 25 (1) of the Land Surveyors' Regulation 1998,  
 I certify that this plan is correct.

Checked by: *[Signature]*  
 Entered on ..... Trinidad & Tobago Land Surveyors ..... 21.09.2000

*Orig Survey Bk 926 H. 134*

22 SEP 2000  
Lands and  
Surveys  
Division