

R.P.O. Vol. 59

Fol. 319

Ward of Siparia

C.T. Vol. 1450

Fol. 479

County of St. Patrick

Bk. 1135 fol. 55

Cadastral Sheet G.13.B. 63F  
1/a

Bk. 936 " 86

Plan EK 8

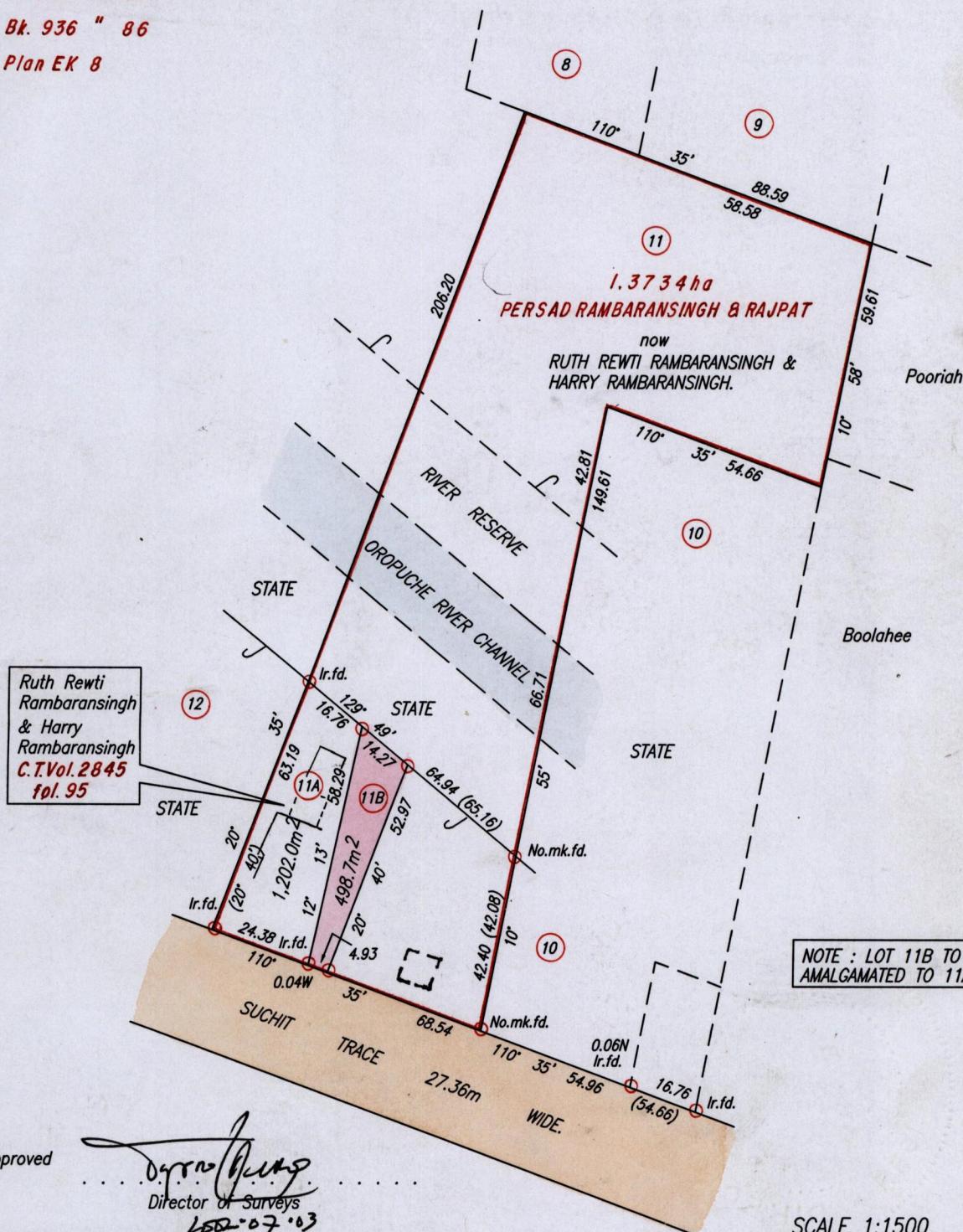

Ruth Rewti Rambaransingh & Harry Rambaransingh  
 C.T. Vol. 2845 fol. 95

Cassini  
 G I W

Approved  
*[Signature]*  
 Director of Surveys  
 1602-07-03

SCALE 1:1500  
 Distances are in Metres

○ Denotes Iron put except otherwise stated.  
 Bearings are based on Solar Observations

PLAN of a Parcel of land coloured pink in the Ward of Siparia .  
 Containing four hundred and ninety eight point seven square metres.  
 Surveyed by me, with due authority, in September, 2000  
 In accordance with Rule 25(1) of the Land Surveyors Regulations 1998,  
 I certify that this plan is correct.



Checked by M.I. 28/5/02

*[Signature]*

Entered on . . . . .

Trinidad & Tobago Land Surveyor . 13<sup>th</sup> June . 2001

28 JUN 2001  
Lands and  
Surveys  
Division