

1267

222

REMAINING PORTION

R.P.O. Vol. 566 Fol. 227

Ward of Siparia

C.T. Vol. Fol.

County of St. Patrick

U.P.R.N. No.:

Cadastral Sheet G.14.M. 64D 63F
3/c 4/d

G.N.
Cassini

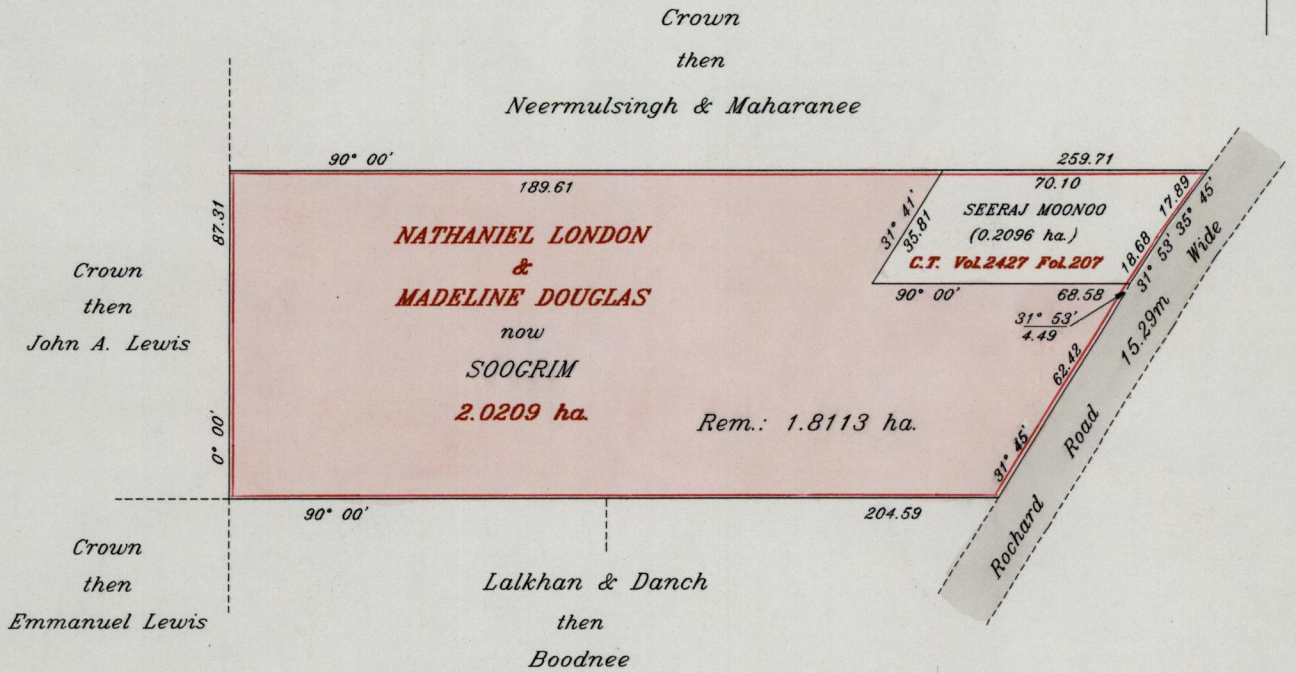

Approved

[Signature]
Director of Surveys
25.02.03.05

Reference: Bk. 563 Fol. 184
Bk. 1163 Fol. 22

SCALE 1: 2000

Distances are in metres

This is a true copy of a diagram of two point zero two zero nine hectares originally granted to NATHANIEL LONDON & MADELINE DOUGLAS, showing a portion coloured pink and containing one point eight one one three hectares being the remainder after one (1) previous transfer of another portion of the land. In accordance with Rule 25(1) of the Land Surveyors' Regulations 1998, I certify that this plan is correct.

Checked by

[Signature]

Entered

[Signature]
Trinidad & Tobago Land Surveyor 7/6/2001



✓

✓

8 JUN 2001
Lands and
Surveys
Division