

R.P.O. Vol. 54
C.T. Vol. 2150

Fol. 245
Fol. 189

Ward of Ortoire
County of Victoria
Cadastral Sheet 64B / 21B, G.10.C.

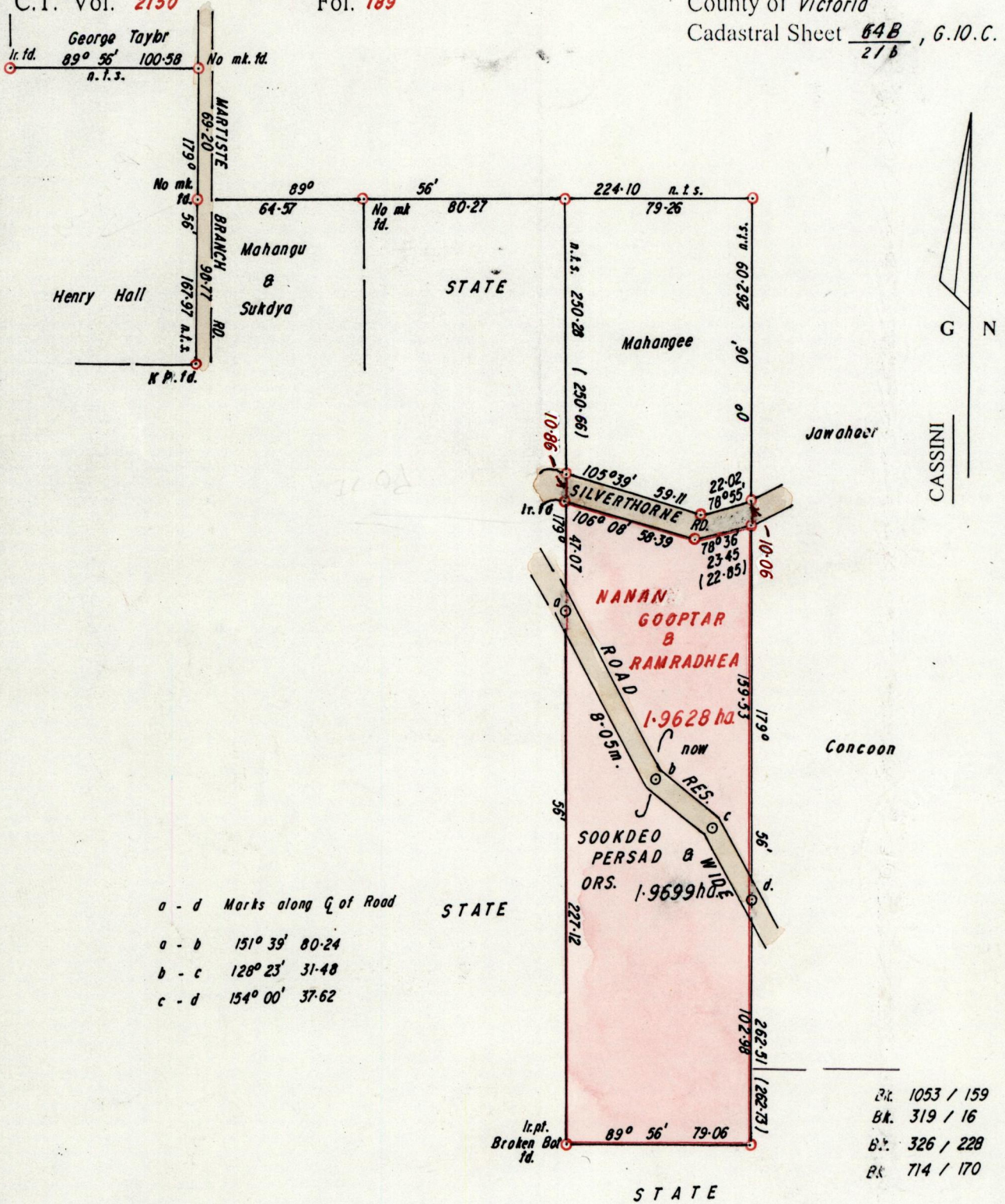

- a - d Marks along Q of Road
- a - b 151° 39' 80.24
- b - c 128° 23' 31.48
- c - d 154° 00' 37.62

Bk. 1053 / 159
 Bk. 319 / 16
 B.L. 326 / 228
 B.R. 714 / 170

Approved

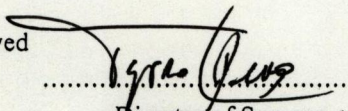
 Director of Surveys
 2001-10-31

○ Denotes Iron put unless otherwise stated

Bearings are Cassini Grid based on Solar Obs.

SCALE 1 / 2500

minutes

Distances are in METRES

Note: To Obtain compass bearings add/subtract

PLAN of a Parcel of land coloured PINK in the Ward of Ortoire
 Containing one point nine six nine nine hectares
 Surveyed by me, with due authority, in May 2000
 In accordance with Rule 25 (1), of the Land Surveyors Regulations 1998.
 I certify that this plan is correct.

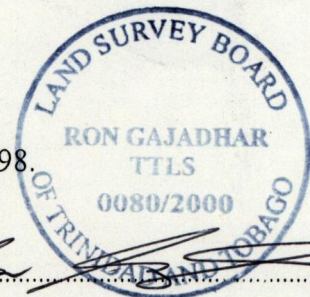

Checked by H. O. 09.18

Entered Land Surveyor, Trinidad and Tobago
 20-05-2001

7091