

142699

4264

L. and S.—53

44D

Cadastral Sheet D 23A, 37c

To be brought under the provisions of the Real Property Ordinance

Ward of Pointe a Pierre

County of Victoria

Process ~~204~~ 66646.

Bk. 1049:93

In accordance with Rule 25(1) of the Land Surveyors' Regulations 1998. I certify that this plan is correct.

Albert Haynes  
Trinidad & Tobago Land Surveyor. 28<sup>th</sup> December 2002

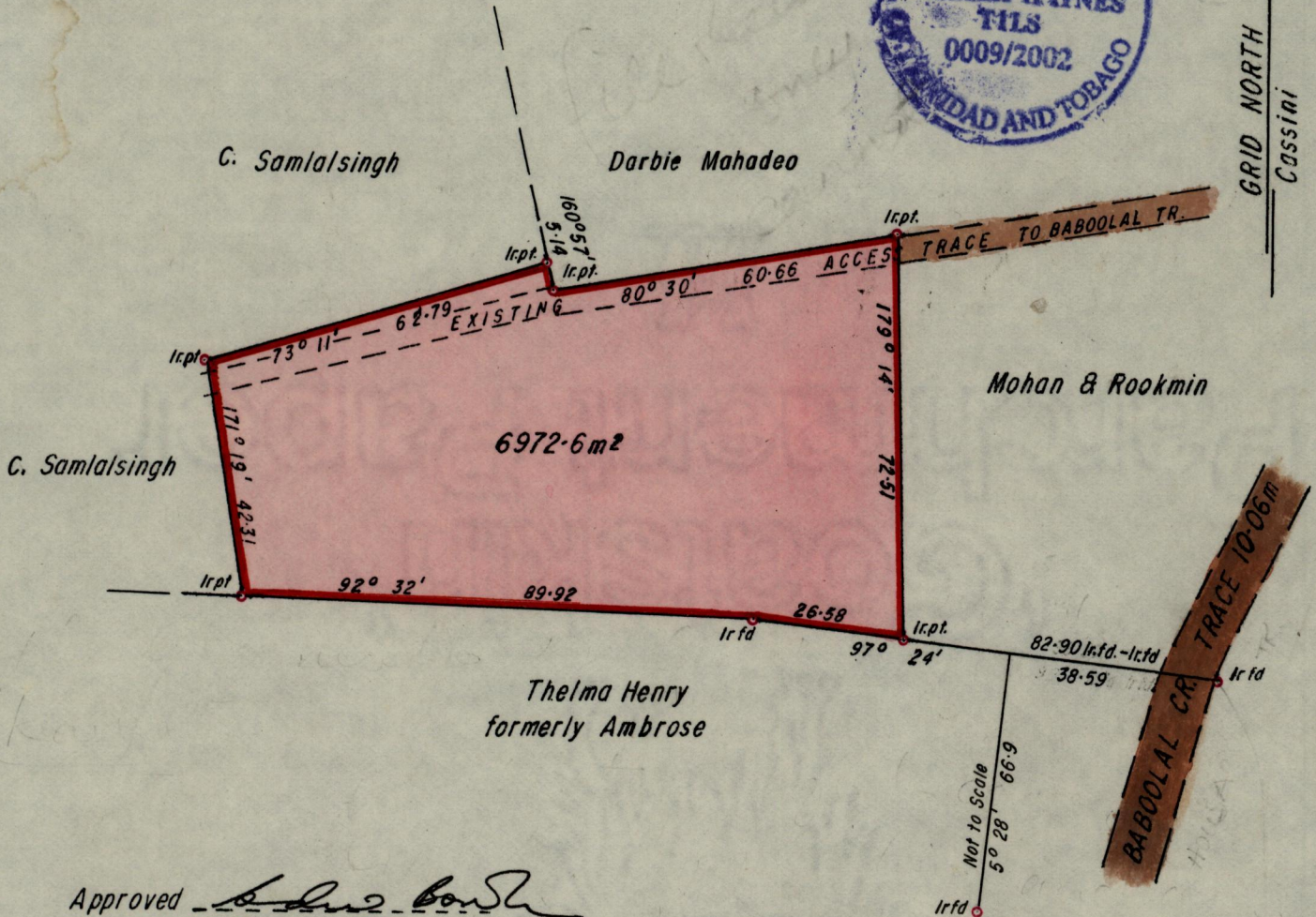

Approved *[Signature]*  
Director of Surveys  
2003.2.13

SCALE 1:1250

add

Note: To obtain compass bearing subtract minutes Distances are in metres

PLAN of a Parcel of land coloured pink in the Ward of Pointe a Pierre

Containing Six thousand nine hundred and seventytwo point six square metres

Surveyed by me, with due authority, on May 18th 1991 for Elaine Finley

*[Signature]*  
Checked by *[Signature]* Land Surveyor, Trinidad..... 1991  
Entered on 440 @ 4/1903 and Tobago

G.P., Tr./To.—C1763—50,000—6/86  
ENTERED: CMIS: *[Signature]*

90