

To be brought under the Provisions of the
Real Property Ordinance.

Wide Bk. 321 fol. 9
" " " 321 " " 172
" " " 955 " " 97
Survey Order 44/99
Bk. 1252 fol. 183

Process SD #66463

located @

Ward of Ortoire
County of Victoria
Cadastral Sheet G.5.K. 54F
1/c

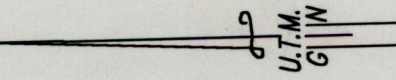

AB = 123° 10' 126.95
BC = 138° 28' 25.93
CD = 96° 50' 321.68

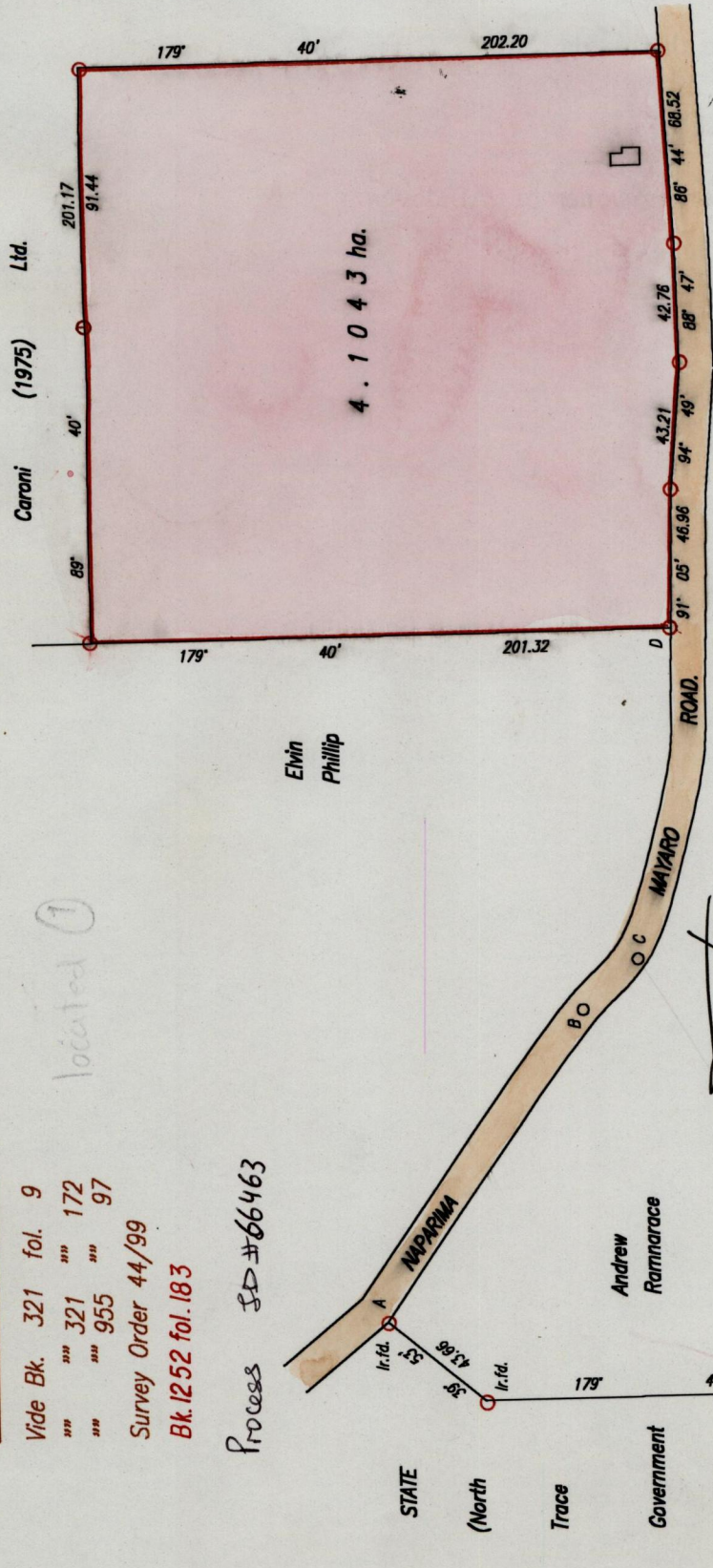

Approved
[Signature]
Director of Survey
2002.03.05

To obtain Cassini Grid add 18 minutes

○ Denotes Iron put except otherwise stated.

Bearings are based on Solar Observations (U.T.M. Grid)

Plan of a Parcel of land coloured pink in the Ward of Ortoire.

Containing four point one zero three hectares.

Surveyed by me, with due authority, on the 7th & 16th February, 2001 for John Mc Sween.

In accordance with Rule 25(1) of the Land Surveyors Regulations 1998,

I certify that this plan is correct.

Checked by M.M. 20.2.02

Entered on 54F
H.B. Dec 2002

SCALE 1:2500
Distances are in Metres



.....
[Signature]
Trinidad & Tobago Land Surveyor 16. March 2001
PATH = E:\700 C:\Drawings\Mc Sween.dwg

1264

25

"A"

This is the Survey Plan referred to in the annexed declaration
of JOHN Mc SWEEN.

Sworn to before me, this day of 2001.

.....
Commissioner of Affidavits.

23 MAY 2001
Lands and
Surveys
Division