

Process ID# 66769

10
2/03

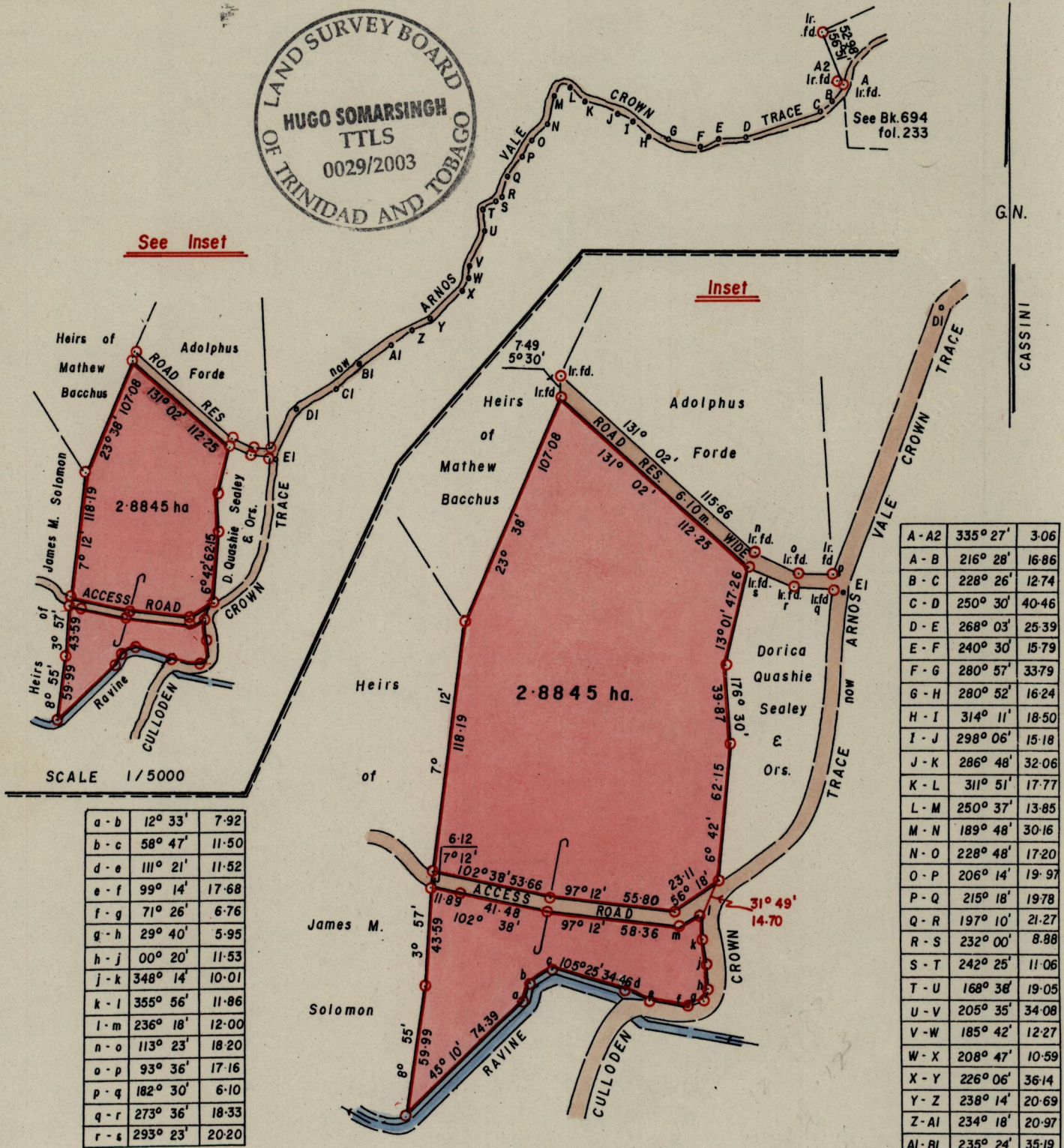
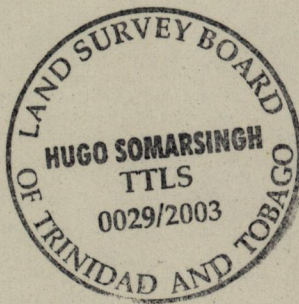

See Inset

Inset

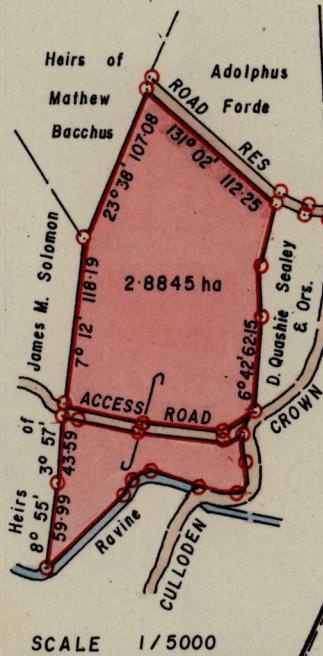

SCALE 1/5000

a - b	12° 33'	7.92
b - c	58° 47'	11.50
d - e	111° 21'	11.52
e - f	99° 14'	17.68
f - g	71° 26'	6.76
g - h	29° 40'	5.95
h - j	00° 20'	11.53
j - k	348° 14'	10.01
k - l	355° 56'	11.86
l - m	236° 18'	12.00
n - o	113° 23'	18.20
o - p	93° 36'	17.16
p - q	182° 30'	6.10
q - r	273° 36'	18.33
r - s	293° 23'	20.20

A - A2	335° 27'	3.06
A - B	216° 28'	16.86
B - C	228° 26'	12.74
C - D	250° 30'	40.46
D - E	268° 03'	25.39
E - F	240° 30'	15.79
F - G	280° 57'	33.79
G - H	280° 52'	16.24
H - I	314° 11'	18.50
I - J	298° 06'	15.18
J - K	286° 48'	32.06
K - L	311° 51'	17.77
L - M	250° 37'	13.85
M - N	189° 48'	30.16
N - O	228° 48'	17.20
O - P	206° 14'	19.97
P - Q	215° 18'	19.78
Q - R	197° 10'	21.27
R - S	232° 00'	8.88
S - T	242° 25'	11.06
T - U	168° 38'	19.05
U - V	205° 35'	34.08
V - W	185° 42'	12.27
W - X	208° 47'	10.59
X - Y	226° 06'	36.14
Y - Z	238° 14'	20.69
Z - AI	234° 18'	20.97
AI - BI	235° 24'	35.19
BI - CI	222° 23'	23.76
BI - DI	233° 26'	67.72
DI - EI	204° 05'	118.84
EI - P	332° 12'	8.29

Approved

[Signature]
Director of Surveys
2004.8.24

○ Denotes Iron put unless otherwise stated
Bearings are Cassini Grid based on Solar Obs.

SCALE 1/2500

Note: To Obtain compass bearings add/subtract minutes Distances are in metres
PLAN of a Parcel of land coloured pink in the Ward of Tobago
Containing two point eight eight four five hectares
Surveyed by me, with due authority on 10th July 2003 for Fulton Murray and
Trevor Murray.

In accordance with Regulation 25 (1) of the Land Surveyors' Regulations 1998,
I certify that this plan is correct.

Checked by *[Signature]*

[Signature]

Entered

Trinidad and Tobago Land Surveyor. 19th November 2003