

Process ID#66755

To be brought under the Provisions of the
Real Property Ordinance.

Cadastral Sheet G.4.0. 54D
4/a
Ward of Savana Grande.
County of Victoria.

Vide Bk. 965 fol 188
" " 989 " 178

located ④

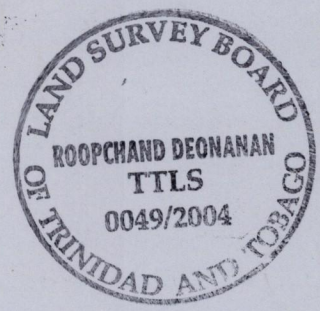
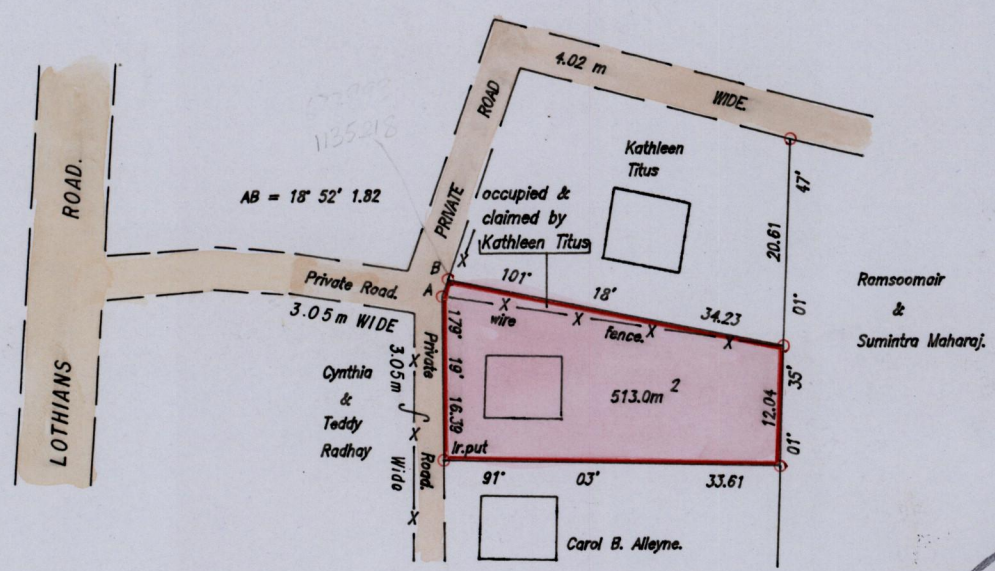
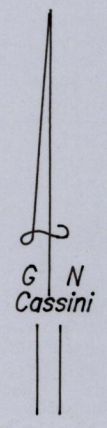

Approved *[Signature]*
Director of Surveys
2004.07.01

SCALE 1:750
Distances are in Metres

○ Denotes Iron found except otherwise stated.
Bearings are based on Solar Observations.(Cassini Grid.)
PLAN of a Parcel of land coloured pink in the Ward of Savana Grande
Containing five hundred and thirteen point zero square metres.
Surveyed by me, with due authority, on 7th April, 1998 for Carol B. Alleyne.
In accordance with Regulation 25(1) of the Land Surveyors' Regulations 1998,
I certify that this plan is correct.

Checked by *[Signature]* 22/09/06/04 *[Signature]*

Entered *[Signature]* Trinidad & Tobago Land Surveyor . 22nd November . 2003
PATH = EV700 C:\Drawings\Carol.dwg.