

1264

193

Process ID# 66905

To be brought under the Provisions of the
Real Property Ordinance
Vide Bk. 1020 fol. 52.

City of San Fernando
County of Victoria

Cadastral Sheet G.3.J. 53F
N/W 1/c

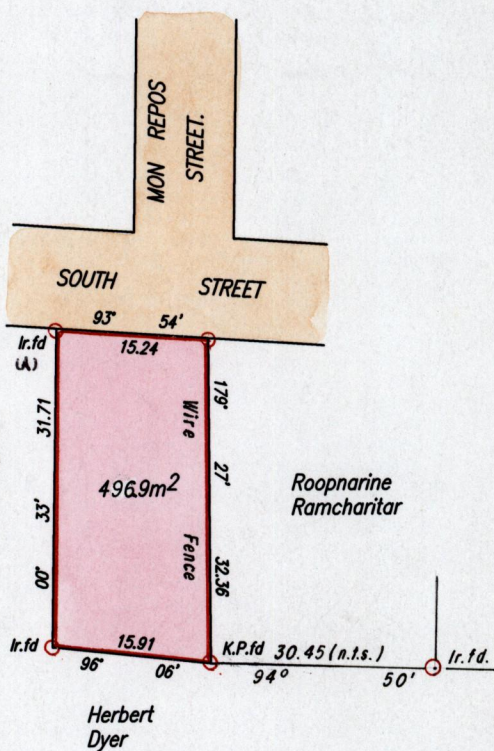

Cassini
G | W

SEE 1292: 82.

11 - 669483.09
1136467.10
WGS84.

Approved *[Signature]*
Director of Surveys



SCALE 1:750
Distances are in Metres

○ Denotes Iron put except otherwise stated.
Bearings are based on Solar Observations

PLAN of a Parcel of land coloured pink in the City of San Fernando
Containing four hundred and ninety six point nine square metres.
Surveyed by me, with due authority, 13th May, 2002 for Dianne Thompson
In accordance with regulation 25(1) of the Land Surveyors' Regulations 1998,
I certify that this plan is correct.

Checked by *[Signature]* 2504.4.26

Entered on *[Signature]* 21st June 2002
Trinidad & Tobago Land Surveyor
PATH = E:\700 C:\Drawings\Lake.dwg

Lucie Lucas
attorney at law

29 OCT 2003
Lands and
Surveys
Division

1264/193