

To be brought under the provisions of the Real Property Ordinance

City of San Fernando
County of Victoria

Process ID# 66644

G. N. UTM

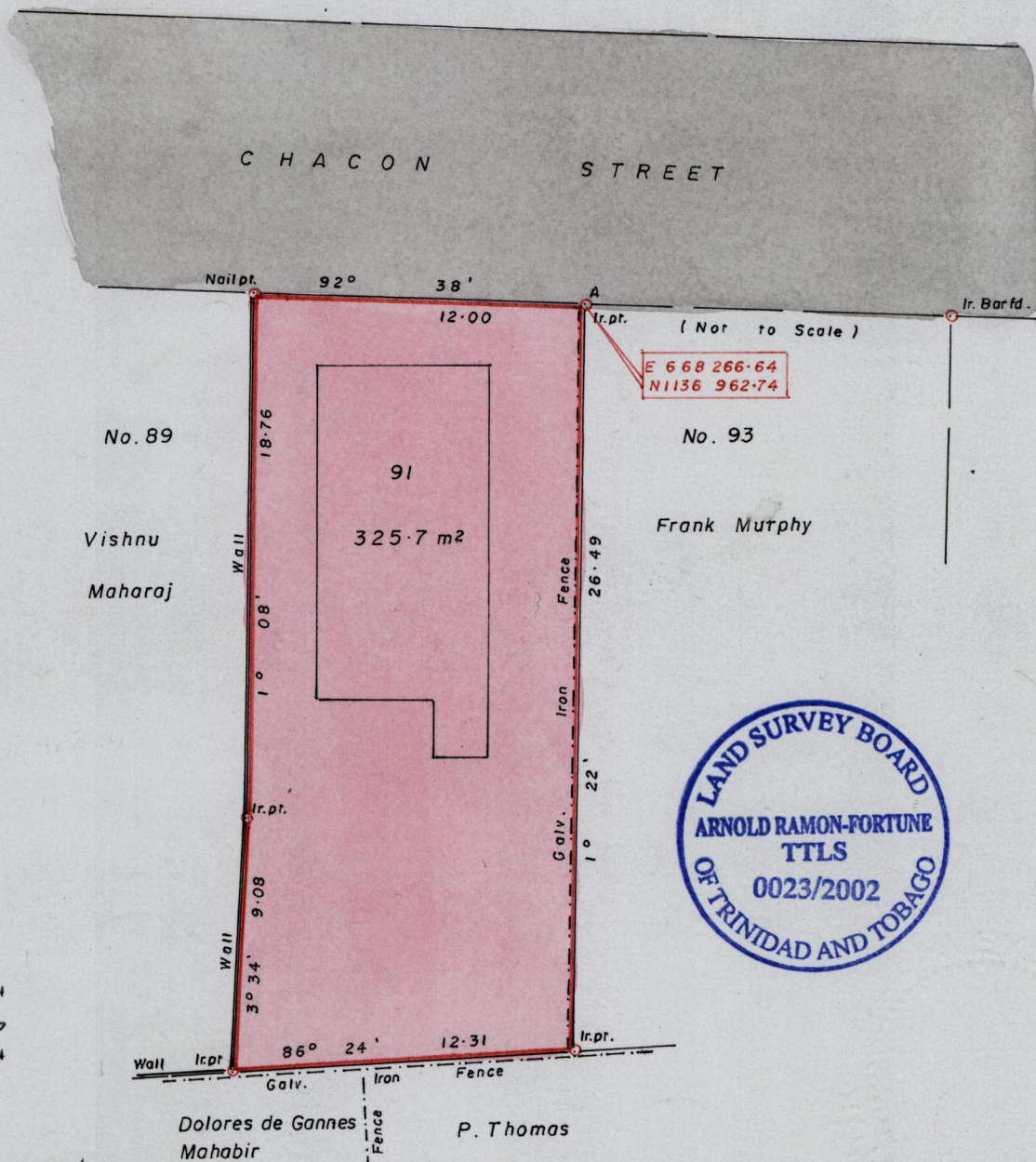

A- 668434
1137146
WGS 84

Approved
Director of Surveys
25/2/02

Co- or. for Brass 53/252= E 668 451.48
N 1137 004.97
A - Ir. Bar = 91° 14' 28.66

Bearings are based on L&S. Control Brasses 53/253 - 53/252
59° 46' 148.49

SCALE : 1 / 250

Note: To obtain compass bearings subtract minutes.

Distances are in metres

PLAN of a Parcel of land coloured pink in the Ward of San Fernando
Containing three hundred and twenty five point seven square metres

Surveyed by me with due authority on 13th February 2002 for Louis Allen.
In accordance with Rule 25(1) of the Land Surveyors' Regulations 1998,
I certify that this plan is correct.

Checked by: *Arnold A. J. Ramon Fortune* T.T.L.S. MRICS.
25th FEBRUARY 2002

Entered: *2002-02-20*
Trinidad & Tobago Land Surveyor.....2002