

Cadastral Sheet B.9.C. 4EB
2/b

Ward of Blanchisseuse

County of St. George

To be brought under the Provision of the
Real Property Ordinance

Process ID#66687

1264/141



Commissioner of Affidavits

"A" This is the survey plan marked "A" referred to in the annexed affidavit of Aldwyn Philip sworn to before me this 26th day of April 1992.

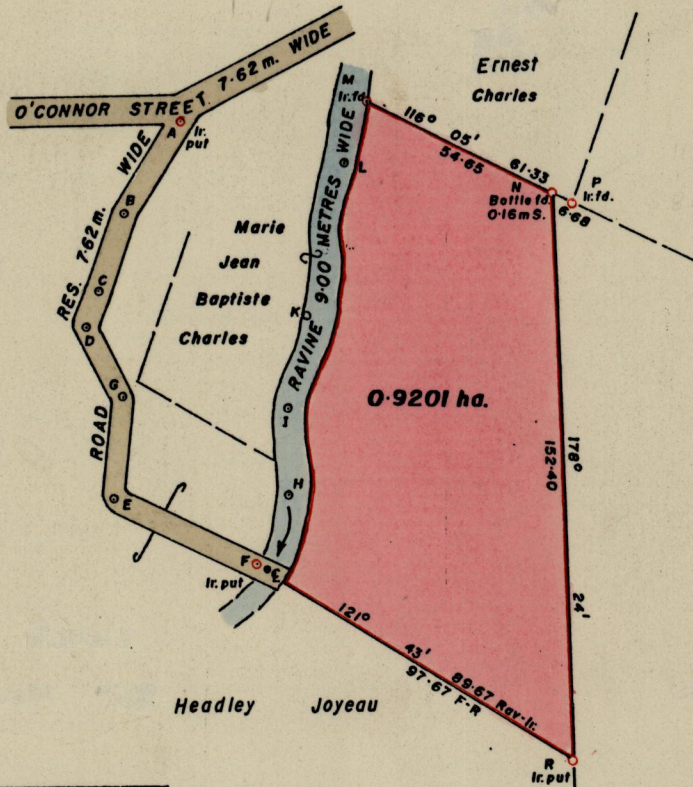

(Cassini)
Grid North

STAT.	BEARING	DIST.
A - B	211° 54'	20.04
B - C	147° 48'	22.03
C - D	201° 43'	10.73
D - G	151° 18'	21.79
G - E	186° 08'	28.04
E - F	115° 59'	42.47
F - H	115° 59'	3.05
F - H	24° 14'	20.69
H - I	00° 32'	23.51
I - K	12° 17'	24.63
K - L	13° 37'	43.27
L - M	21° 59'	17.25

Approved: *[Signature]*
Director of Surveys
2003-11-06

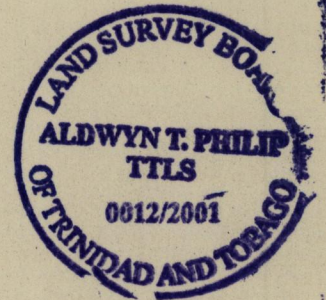

SEE BK. 1241 : 217
SEE BK. 1083 : 143
SEE BK. 859 : 101

SCALE 1:2000

N.T.S. - Not To Scale

Note: To obtain compass bearing subtract 13 minutes Distances are in metres

PLAN of a Parcel of land coloured pink in the Ward of Blanchisseuse
Containing point nine two zero one hectares

Surveyed by me, with due authority, on 26th, 27th Sept. & 2nd, 3rd. Oct. 1990 for Beryl Williams, Lucille Guevara and
Checked by *[Signature]* in accordance with Reg. 25 (1) of the Land Surveyors Reg. 1998, I certify that this plan is correct. Allen Black.

Entered on 4EB 2/12/03

[Signature]
Land Surveyor, Trinidad and Tobago

April 24th, 1992.